



AGENDA
DRAINAGE DISTRICT
BOARD OF DIRECTORS
November 22, 2016
9:00 A.M.

NOTICE is hereby given in accordance with Chapter 551, Texas Government Code, that a REGULAR MEETING of the Drainage District #1 Board of Directors will be held in the Commissioners' Courtroom of the Administration Building, 100 E. Cano, 1st floor, Edinburg, Hidalgo County, Texas. Discussion and possible action relating to the following business will be transacted:

1. **Roll Call**
2. **Prayer**
3. **Open Forum**
4. **Approval of Consent Agenda**
5. Discussion on Hidalgo County Drainage District No. 1 Drainage projects, maintenance and operations
6. **AI -57240** A. Discussion and action on tax resale bids received on the properties described as follows: (see attached list).

B. Discussion and action on resolution for tax resale bid properties.
7. **AI -57439** Requesting approval of a drainage easement acquisition from Gayle Jackson, being a 20.00 foot wide drainage easement containing 0.606 of an acre and being the east of 20.00 feet of Farm Tract 1119 of the West and Adams Tract Subdivision.
8. **AI -57411** A.) Requesting approval of final negotiated Professional Services Agreement with Millennium Engineers Group, Inc., as it relates to Material Testing Services for Kenyon Rd. & Mile 17 Area Drainage Improvements Project. Approved for negotiations by HCDD1 Board of Directors on June 14, 2016.

B.) Pursuant to the Boards approval of Professional Services Agreement

with Millennium Engineers Group, Inc., requesting approval of Work Authorization No. 1 in the amount of \$24,828.25 as it relates to On Call Construction Material Testing Services for Kenyon Rd. & Mile 17 Area Drainage Improvements Project.

9. **AI -57435** A.) Requesting exemption from competitive bidding requirements under the Texas Local Government Code, Section 262.024(A)(4) for a Professional Service.

B.) Presentation of scoring grid (for purposes or ranking by HCDD1 Board of Directors) of the firms graded and evaluated through the District's approved "Pool" of Engineering Firms for the provision of "Construction Material Testing" for Flood Pump Drainage Improvements Projects at Mercedes Lateral, East Donna Drain, South Mercedes Drain and Weslaco Drain.

FIRM NAME:	SCORE:	RANK:
MILLENNIUM ENGINEERS GROUP	98	
INTERNATIONAL CONSULTING ENGINEERS	94	
TERRACON CONSULTANTS, INC	97	

C.) Requesting authority for Drainage District to negotiate a Professional Agreement for Engineering Services with the number one ranked firm of _____, as it relates to Construction Material Testing for Flood Pump Drainage Improvements Projects at Mercedes Lateral, East Donna Drain, South Mercedes Drain, and Weslaco Drain.

10. **AI -57461** Requesting approval to submit Application for Service to Sharyland Water Supply Corporation and approval for District General Manager to sign as it relates to water service for The North 1.0 Acre of the East 20.0 acres of Lot 8, Section 236.

11. **AI -57451** 2012 Bond Referendum

A. Request approval to amend the 2012 bond resolution relating to the authorization to issue bonds for the Raymondville Drain Project.

B. Request approval of a resolution of the Board of Directors of Hidalgo County Drainage District No. 1, authorizing filing of a petition for Declaratory Action relating to issuance of the District \$100 million in authorized by unissued tax bonds, and approving other matters incident thereto.

C. Request approval and permission for the District to file Declaratory Action and Authorization to have such filing be prepare and filed by the District Bond Counsel, Jesus Ramirez, under the term of the current

engagement between the Hidalgo County Drainage District No. 1 and The J. Ramirez Law Firm.

12. **AI -57428** Authority to publish and approval of qualifications, requirements and scope of services for the engagement of legal counsel to pursue all remedies available to the Hidalgo County Drainage District #1 in connection with the agreement between Hidalgo County Drainage District #1 and Integ Corporation as outlined/contained in the final Lee Law Firm Report

13. **Closed Session:**
Board of Directors may go into Closed Session pursuant to Chapter 551, Texas Government Code, Sections 551.071 & 551.072 to discuss the following:
 - A. **Real Estate Acquisition**

 - B. **Pending and/or Potential Litigation**

 - C. **AI -57463** Review of Attorney-Client Privileged Investigative Analysis Report with respect to potential litigation - Integ Corporation

 - D. **AI -57466** Potential Litigation - 2012 Bond Resolution

14. **Open Session:**
 - A. **Real Estate Acquisition**

 - B. **Pending and/or Potential Litigation**

 - C. **AI -57464** Review of Attorney-Client Privileged Investigative Analysis Report with respect to potential litigation - Integ Corporation

 - D. **AI -57467** Potential Litigation - 2012 Bond Resolution

15. **Closed Session:**
Board of Directors may reconvene into Closed Session for the discussion regarding the agenda items listed

16. Open Session:
Board of Directors may reconvene into Open Session for the discussion regarding the agenda items listed

17. Adjourn

AI -57240

6.

DRAINAGE DISTRICT

Meeting Date: 11/22/2016

Submitted For: Lora Briones

Submitted By: Monica Badillo,
EXECUTIVE OFFICE

Department: DRAINAGE DISTRICT

Information

CAPTION

A. Discussion and action on tax resale bids received on the properties described as follows: (see attached list).

B. Discussion and action on resolution for tax resale bid properties.

BACKGROUND

Fiscal Impact

Attachments

backup

resolution

Form Review

Inbox	Reviewed By	Date
Final Approval	Monica Badillo	11/18/2016 05:28 PM
Form Started By: Monica Badillo		Started On: 11/07/2016 01:32 PM
Final Approval Date: 11/18/2016		

LAW OFFICES
OF
LINEBARGER GOGGAN BLAIR & SAMPSON, LLP
ATTORNEYS AT LAW
205 SOUTH PIN OAK AVE.
EDINBURG, TEXAS 78539

Telephone: (956) 383-4500
Facsimile: (956) 383-7820

November 22, 2016

Ms. Monica Salinas Badillo
Court Administrator
Hidalgo County Executive Office
2818 S. Business Hwy. 281
Edinburg, Texas 78539

RE: TAX RESALE PROPERTIES

Dear Ms. Badillo:

On October 4, 2016, our firm held a Tax Resale at the Hidalgo County Clerk Records Management Facility. We placed thirty five (35) previously struck-off properties for resale throughout Hidalgo County and received bids on thirty two properties. The resale of these properties was published in several newspapers throughout Hidalgo County.

Enclosed for the consideration of the Commissioner's Court and Drainage District # 1 Board of Directors is an analysis of each bid received, which indicates the amount to be prorated amongst Hidalgo County, Hidalgo County Drainage District # 1 and all other taxing jurisdictions. We are in the process of submitting the resale bids to La Joya Independent School District, Mission Consolidated Independent School District, City of Mission, South Texas College, South Texas Independent School District, City of Alton, City of McAllen, City of Progreso, City of Sullivan, Hidalgo County Irrigation district #16, Hidalgo County Irrigation district #6, McAllen Independent School District, Progreso Independent school District and United Irrigation District for their consideration.

If you have any questions or require further information, please do not hesitate to call me.

Very truly yours,

**LINEBARGER GOGGAN BLAIR
& SAMPSON, LLP**

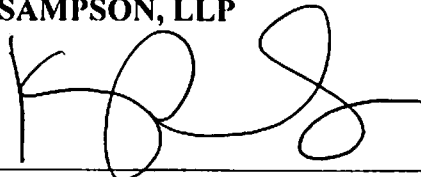

Kelly R. Salazar
Attorney for the Firm

LINEBARGER GOGGAN BLAIR & SAMPSON, LLP
October 4, 2016 TAX RESALE LIST
HIDALGO COUNTY

SUIT NUMBER	LEGAL DESCRIPTION	ACCOUNT NUMBER	OPENING BID	AMOUNT OF BID	AMOUNT FOR COUNTY	AMOUNT FOR DRAIN. DIST. # 1
T-843-97-C 1	A parcel of land out of the Northwest corner of Lot No. 16-3, West Addition to Sharyland, in Hidalgo County, Texas	W0100-00-016-0003-18	\$7,450.00	\$9,500.00	\$1,184.75	\$254.74
T-937-03-A 2	Lot A-2, Penn Rich Garden South Subdivision Unit 2, Hidalgo County, Texas	P5600-02-000-00A2-00	\$20,900.00	\$10,000.00	\$1,447.67	\$364.47
T-271-04-A 3	Lot 5, Block 33, Original Townsite, City of Mission, Hidalgo County, Texas "POSSIBLE UNSAFE STRUCTURE"	M5200-00-033-0005-00	\$59,790.00	\$17,500.00	\$3,655.23	\$773.67
T-716-04-E 4	1.0 ACRES OF LAND BEING THE SOUTH 1.0 ACRES OF THE NORTH 10.0 ACRES OF LOT 45-1, WEST ADDITION TO SHARYLAND SUBDIVISION	W0100-00-045-0001-06	\$17,780.00	\$9,600.00	\$1,865.92	\$205.69
T-897-04-F 5	Lot D, Los Jardines Subdivision, Hidalgo County, Texas.	L6220-00-000-0000-04	\$38,461.00	\$18,500.00	\$3,704.99	\$581.28
T-897-04-F 6	Lot 63, Los Jardines Subdivision, Hidalgo County, Texas.	L6220-00-000-0063-00	\$22,150.00	\$14,000.00	\$3,022.99	\$603.26
T-818-07-A 7	ALL OF LOT 136, PALM LAKE ESTATES SUBDIVISION UNIT NUMBER ONE (1), IN HIDALGO COUNTY, TEXAS	P1000-00-000-0136-00	\$9,710.00	\$13,000.00	\$2,418.31	\$201.37
T-411-10-E 9	A 0.287 acre tract of land, more or less, out of Lot 43-12, West Addition to Sharyland, Hidalgo County, Texas	S6200-00-000-0009-00	\$19,590.00	\$15,000.00	\$3,201.52	\$612.35
T-413-10-A 10	The North 50 feet of Lot 6, Block "C", Cinco De Mayo Ranch, an addition to Hidalgo County, Texas, according to the map or plat thereof, recorded in Volume 19, Page 24, Map Records of Hidalgo County, Texas. (Subject to United Irrigation District)	C4450-00-00C-0006-00	\$21,726.00	\$13,000.00	\$2,045.16	\$316.12
T-1319-10-C 11	Lot 7, Mission Center Subdivision, a subdivision to the City of Mission, Hidalgo County, Texas	M4935-00-000-0007-00	\$171,100.00	\$55,100.00	\$11,428.71	\$1,058.00
T-1319-10-C 12	The Northeast 1.00 acre of the South 8.55 acres, more or less, out of Lot 43-9, West Addition to Sharyland, an addition to Hidalgo County, Texas,	W0100-00-043-0009-35	\$127,870.00	\$26,000.00	\$6,057.15	\$570.94
T-1296-08-G 15	Lot 97, Retiree Haven Addition, Unit 2, City of McAllen, Hidalgo County, Texas,	R2300-02-000-0097-00	\$39,111.00	\$15,000.00	\$2,873.17	\$274.49

SUIT NUMBER	LEGAL DESCRIPTION	ACCOUNT NUMBER	OPENING BID	AMOUNT OF BID	AMOUNT FOR COUNTY	AMOUNT FOR DRAIN. DIST. # 1
T-1015-09-G 16	Lot 5, Block 1, Cathay Courts Addition, an addition to the City of McAllen, Hidalgo County, Texas,	C2300-00-001-0005-00	\$37,730.00	\$30,100.00	\$6,225.35	\$650.44
T-1669-13-H 17	Lot No. Ten (10), Block One (1), in Cathay Courts Annex, an addition to the City of McAllen, Hidalgo County, Texas,	C2300-00-001-0010-00	\$65,990.00	\$24,500.00	\$5,123.77	\$1,182.70
T-1059-97-B 18	28.66 Acres, ,more or less, out of Tract 303, Partition of Porciones 38, 39 and 40, Hidalgo County, Texas	10038-00-000-0303-03	\$81,700.00	\$30,000.00	\$6,210.53	N/A
T-416-03-B 19	ALL OF LOT 24, IN COUNTRY ESTATES WEST ADDITION "A", AN ADDITION TO THE CITY OF LA JOYA, HIDALGO COUNTY, TEXAS	C9010-0A-000-0024-00	\$19,275.00	\$9,600.00	\$1,478.63	\$362.46
T-416-03-B 20	ALL OF LOT 25, IN COUNTRY ESTATES WEST ADDITION "A", AN ADDITION TO THE CITY OF LA JOYA, HIDALGO COUNTY, TEXAS	C9010-0A-000-0025-00	\$19,275.00	\$11,000.00	\$1,769.04	\$433.65
T-416-03-B 21	ALL OF LOT 26, IN COUNTRY ESTATES WEST ADDITION "A", AN ADDITION TO THE CITY OF LA JOYA, HIDALGO COUNTY, TEXAS,	C9010-0A-000-0026-00	\$19,275.00	\$12,500.00	\$1,711.72	\$407.57
T-1152-03-I 22	A .50 ACRE OUT OF THE EAST 145.6 FEET OF THE WEST 871.2 FEET OF THE NORTH 150 FEET OF LOT 10, BLOCK 18, TEXAS GARDENS, HIDALGO COUNTY, TEXAS	T2200-00-018-0010-16	\$81,370.00	\$20,500.00	\$3,701.88	\$407.25
T-1164-03-C 23, 24 & 25	Lot 6, Block 4, Lot 8, Block 4 & Lot 2, Block 6 Del Monte Orchard Co. Subdivision No. 1, a subdivision in Hidalgo County, Texas	D2800-00-004-0006-00 D2800-00-004-0008-00 D2800-00-006-0002-00	\$213,410.00	\$140,000.00	\$25,982.25	\$3,855.46
T-1114-04-G 26	LOT 56, BLOCK 49 OF THE TOWNSITE OF CITRUS CITY, HIDALGO COUNTY, TEXAS,	C4750-00-049-0056-00	\$32,770.00	\$12,000.00	\$1,431.63	\$230.48
T-1114-04-G 27	LOT 57, BLOCK 49 OF THE TOWNSITE OF CITRUS CITY, HIDALGO COUNTY, TEXAS,	C4750-00-049-0057-00	\$32,420.00	\$17,000.00	\$2,144.37	\$345.23
T-2679-09-A 28	LOT 18, BLOCK 23, TIERRA DORADA, HIDALGO COUNTY, TEXAS	T5250-00-023-0018-00	\$21,360.00	\$9,800.00	\$1,344.85	\$193.65
T-1368-10-I 29	Lot 41, Carlos Acres Subdivision, a subdivision in Hidalgo County, Texas	C1760-00-000-0041-00	\$37,730.00	\$16,000.00	\$3,856.67	\$481.04
T-1029-11-C 30	Lot 59-A, Benavides Subdivision, Hidalgo County, Texas	B2400-01-000-0059-01	\$25,170.00	\$10,500.00	\$2,153.57	N/A
T-1070-11-I 31	Lot 125, Amended Plat of Palm Shores Subdivision, Unit No. 1, a subdivision in Hidalgo County, Texas,	P2750-01-000-0125-00	\$13,710.00	\$9,000.00	\$952.93	N/A

SUIT NUMBER	LEGAL DESCRIPTION	ACCOUNT NUMBER	OPENING BID	AMOUNT OF BID	AMOUNT FOR COUNTY	AMOUNT FOR DRAIN. DIST. # 1
T-0339-12-A 32	The 0.457 acres, more or less, out of Tract 267 of the Partition of Porciones 38, 39 and 40, Hidalgo County, Texas	10038-00-000-0267-11	\$7,060.00	\$9,000.00	\$2,184.79	N/A
T-0339-12-A 33	The 0.457 acres, more or less, out of Tract 267 of the Partition of Porciones 38, 39 and 40, Hidalgo County, Texas	10038-00-000-0267-00	\$11,640.00	\$9,000.00	\$2,312.55	N/A
T-2370-14-H 34	0.20 acres, more or less, situated in the Northwest corner of Block 139, Los Ejidos Viejo Grant, Hidalgo County, Texas	L6050-00-000-0139-15	\$45,560.00	\$11,000.00	\$2,488.88	\$254.66
T-1377-09-B 35	0.686 acre, more or less, being a portion of the South 7.29 acres of Block 36 of the resubdivision of Blocks 25, 26, 35, 36, 47, 48, 57, 58, 69 and 70, Llano Grande Subdivision, a subdivision in Hidalgo County, Texas	L5025-00-000-0036-01	\$39,910.00	\$25,500.00	\$4,614.37	\$477.71

Total for Hidalgo County: \$118,593.35
Total for Drainage District #1: \$15,098.68
Total Amount Collected: \$ 133,692.03

HIDALGO COUNTY DRAINAGE DISTRICT NO. 1

RESOLUTION

On the 22nd day of November 2016, at the regularly scheduled meeting of the Board of Directors of Hidalgo County Drainage District No. 1, a motion was duly made and seconded to resell properties described on the attached list, which were acquired by the District through previous tax foreclosure proceedings. The properties were sold in accordance with Texas Tax Code Ann. §34.05.

Discussion was then conducted, and upon completion of the same, the Chairman of the Board called for a vote on the motion, and the same was passed by majority. Now therefore:

BE IT RESOLVED that the Board of Hidalgo County Drainage District No. 1 approves the bids received on the properties described on the attached list and authorizes the Chairman of the Board to execute the tax resale deeds conveying the approved properties.

SIGNED on this 22nd day of November 2016.

HIDALGO COUNTY

Ramon Garcia
Chairman
Board of Directors

ATTEST:

Arturo Guajardo, Jr.
County Clerk
Hidalgo County

AI -57439

7.

DRAINAGE DISTRICT

Meeting Date: 11/22/2016

Submitted For: Jaime Salazar

Submitted By: Jaime Salazar, DRAINAGE DISTRICT

Department: DRAINAGE DISTRICT

Information

CAPTION

Requesting approval of a drainage easement acquisition from Gayle Jackson, being a 20.00 foot wide drainage easement containing 0.606 of an acre and being the east of 20.00 feet of Farm Tract 1119 of the West and Adams Tract Subdivision.

BACKGROUND

Fiscal Impact

Attachments

Drainage Easement

Form Review

Inbox	Reviewed By	Date
Final Approval	Monica Badillo	11/18/2016 05:28 PM
Form Started By: Jaime Salazar		Started On: 11/18/2016 09:31 AM
Final Approval Date: 11/18/2016		

NOTICE OF CONFIDENTIALITY RIGHTS: IF YOU ARE A NATURAL PERSON, YOU MAY REMOVE OR STRIKE ANY OR ALL OF THE FOLLOWING INFORMATION FROM ANY INSTRUMENT THAT TRANSFERS AN INTEREST IN REAL PROPERTY BEFORE IT IS FILED FOR RECORD IN THE PUBLIC RECORDS: YOUR SOCIAL SECURITY NUMBER OR YOUR DRIVER'S LICENSE NUMBER.

DRAINAGE EASEMENT

STATE OF TEXAS

KNOW ALL MEN BY THESE PRESENTS

COUNTY OF HIDALGO

That Gayle Jackson (Grantor) for good and valuable consideration, the receipt and sufficiency for which is hereby acknowledged and accepted does hereby GRANT, BARGAIN, SELL AND CONVEY unto Hidalgo County Drainage District No. 1 ("Grantee") its successors or assigns the following described free and permanent easement and right of way upon, over, across, under and along the following described certain tract of land situated in Hidalgo County, Texas as follows, to wit:

SEE EXHIBIT A AND B ATTACHED HERETO AND INCORPORATED HEREIN AT THIS POINT FOR ALL PURPOSES.

(the "Easement") for the purpose of constructing, reconstructing, excavating, digging, maintaining, and operating a drainage ditch, spoil bank, levees, roadways and other storm drain structure(s) for the disposal of accumulated and excessive rainfall and/or floodwater, (the "Facilities") together with free ingress and egress at all reasonable times to and from the Easement for the purpose of doing and performing or having performed, any and all acts and functions for the orderly constructing, reconstructing, excavating, digging maintaining, and operating the Facilities together with any and all other functions and acts incident to the constructing, reconstructing, excavating, digging, maintaining, and operating the Facilities, upon, over, under across, and along the Easement.

Grantee shall have the right of ingress, egress, entry and access in, to, through, on, over, under, across and along the Easement and where same intersect any public road or public right of way or other easement to which Grantee has the right to access and along any roads designated by Grantor, for any and all purposes necessary and/or incident to the exercise by the Grantee of the rights granted to it by this Agreement.

TO HAVE AND TO HOLD, the Easement, with the right of ingress and egress thereto, together with all and singular the rights and appurtenances thereto, any wise belonging unto the said Grantee, its successors and assigns forever; and Grantor does hereby bind itself, its successors and assigns, to warranty and to defend all and singular the Easement premises unto the Grantee, its successors and assigns against every person whomsoever lawfully claiming or to claim same or any part thereof.

Grantor represents and warrants it is the sole owner and holds fee simple title to the property on which the Easement is located. Grantor has the unrestricted rights and authority and has taken all necessary action to authorize Grantor to execute the easement and to grant to Hidalgo County Drainage District No. 1 the rights granted hereunder.

This easement will be binding upon and inure to the benefit of the parties hereto and their respective successors, legal representatives, and assigns. The parties intend that this easement creates a valid and present interest in the property on which the easement is located in favor of Grantee and therefore this easement will be deemed an interest in and encumbrance upon the property on which the easement is located which will run with the property on which the easement is located. Grantee may assign all or part of its interest or rights in this Easement.

This Easement may only be modified in a separate writing signed by both parties. This Easement shall be governed by and construed under the laws of the State of Texas excluding any choice of law provisions thereof.

IN WITNESS WHEREOF, this instrument is executed on this the 9th day of November, 2016.

Grantor:

Gayle Blake Jackson

Grantee:

Hidalgo County Drainage District No. 1

By:

Print Name: Gayle Blake Jackson

By:

Print Name: Ramon Garcia

Title:

Owner

Title: Chairman of the Board

ACKNOWLEDGEMENT

STATE OF TEXAS

COUNTY OF HIDALGO

This instrument was acknowledged before me on Nov 9, 2016 by

Gayle B Jackson of 2409 Jay Ave McAllen TX on behalf of
said Blake Farms Partnership.

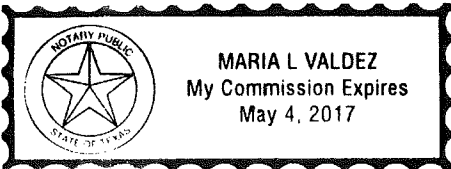

Maria L. Valdez
Notary Public, State of Texas

CORPORATION ACKNOWLEDGEMENT

STATE OF TEXAS

COUNTY OF HIDALGO

This instrument was acknowledged before me on _____, 2016, by Ramon Garcia, Chairman of the Board of Hidalgo County Drainage District No. 1, on behalf of said corporation.

Notary Public, State of Texas

“EXHIBIT A”

DRAINAGE EASEMENT

BEING a twenty (20.00) foot wide drainage easement containing 0.606 of an acre and being the east 20.00 feet of Farm Tract 1119 of the West and Adams Tract Subdivision as depicted and recorded in Volume 2, Pages 34 thru 37, of the Plat Records of Hidalgo County, Texas, and being more particularly described as follow:

BEGINNING at a cotton spindle found in the center of Mile 13 ½ North (40.0 foot right-of-way width) for the common north corner of Farm Tract 1122 and Farm Tract 1119, having Texas State Plane Coordinates of N: 16,616,738.24' and E:1,163,172.87';

THENCE, South 00°59'31" East, along the common boundary line of the aforementioned Farm Tract 1122 and Farm Tract 1119, at a distance of 20.00 feet, pass a 1/2 inch iron rod set with a surveyors cap stamped "CDS/MUERY S.A. TX" (hereinafter referred to as "with cap") on the south right-of-way line of the aforementioned Mile 13 ½ North, at a distance of 1,290.00 feet pass, a 1/2 inch iron rod set with cap for reference on the north side of an existing drainage ditch, a total distance of 1,320.00 feet, to a point in said drainage ditch at the common south corner of said Farm Tract 1122 and Farm Tract 1119 and on the north boundary line of Farm Tract 1121 for the southeast corner of the herein described drainage easement;

THENCE, South 89°00'29" West, along the south boundary line of Farm Tract 1119, the north boundary line of Farm Tract 1121 and along the aforementioned drainage ditch, a distance of 20.00 feet, to a point for the southwest corner of the herein described drainage easement;

THENCE, North 00°59'31" West, along a line parallel to and 20.00 feet west of the common boundary line of Farm Tract 1122 and Farm Tract 1119, at a distance of 40.00 feet, pass a 1/2 inch iron rod set with cap set for reference, on the north side of an existing drainage ditch, at a distance of 1,300.00 feet, pass a 1/2 inch iron rod set with cap on the south right-of-way line of the aforementioned Mile 13 ½ North, a total distance of 1,320.00 feet, to a point in the center of said Mile 13 ½ North, on the common boundary line of Farm Tract 1119 and Farm Tract 1123, for the northwest corner of the herein described drainage easement;

THENCE, North 89°00'29" East, along common boundary line of said Farm Tract 1119 and Farm Tract 1123 and the center of Mile 13 ½ North, a distance of 20.00 feet, to the **POINT OF BEGINNING** of the herein described drainage easement, said easement contains 0.606 of an acre, more or less, within these metes and bounds.

TEMPORARY CONSTRUCTION EASEMENT

BEING a thirty (30.00) foot wide temporary construction easement containing 0.909 of an acre out of Farm Tract 1119 of the West and Adams Tract Subdivision as depicted and recorded in Volume 2, Pages 34 thru 37, of the Plat Records of Hidalgo County, Texas, and being more particularly described as follow:

BEGINNING at a point in the center of Mile 13 ½ North (40.0 foot right-of-way width) on the north boundary line of Farm Tract 1119 and the south boundary line of Farm Tract 1123, for the northeast corner of the herein described temporary construction easement, from which a cotton spindle found in the center of Mile 13 ½ North for the common north corner of Farm Tract 1122 and Farm Tract 1119 bears North 89°00'29" East a distance of 20.00 feet, and having Texas State Plane Coordinates of N: 16,616,738.24' and E:1,163,172.87';

THENCE, South 00°59'31" East, along a line parallel to and 20.00 feet west of the common boundary line of the aforementioned Farm Tract 1122 and Farm Tract 1119, at a distance of 20.00 feet, pass a 1/2 inch iron rod set with a surveyors cap stamped "CDS/MUERY S.A. TX" (hereinafter referred to as "with cap") on the south right-of-way line of the aforementioned Mile 13 ½ North, at a distance of 1,280.00 feet pass a 1/2 inch iron rod set with cap for reference on the north side of an existing drainage ditch, a total distance of 1,320.00 feet, to a point in said drainage ditch on the south boundary line of said Farm Tract 1119 and the north boundary line of Farm Tract 1121, for the southeast corner of the herein described temporary construction easement;

THENCE, South 89°00'29" West, along the south boundary line of Farm Tract 1119 and the north boundary line of Farm Tract 1121 and along the aforementioned drainage ditch, a distance of 30.00 feet, to a point for the southwest corner of the herein described temporary construction easement;

THENCE, North 00°59'31" West, along a line parallel to and 50.00 feet west of the common boundary line of Farm Tract 1122 and Farm Tract 1119, at a distance of 1,300.00 feet, pass the south right-of-way line of the aforementioned Mile 13 ½ North, a total distance of 1,320.00 feet, to a point in the center of said Mile 13 ½ North on the common boundary line of Farm Tract 1119 and Farm Tract 1123, for the northwest corner of the herein described temporary construction easement;

THENCE, North 89°00'29" East, along common boundary line of said Farm Tract 1119 and Farm Tract 1123 and the center of Mile 13 ½ North, a distance of 30.00 feet, to the **POINT OF BEGINNING** of the herein described temporary construction easement, said easement contains 0.909 of an acre, more or less, within these metes and bounds.

Bearings are Grid North, based on the Texas State Plane Coordinate System, NAD 83(93), South Zone. Coordinates and distances shown are grid. A survey drawing (416006 Ditch 4E2A.dwg) of even date was prepared and is made a part of this field note description.

I, R. Michael Wood a Registered Professional Land Surveyor, do hereby certify that the above field notes were prepared using information obtained by an on the ground survey made under my direction and supervision in August of 2016

Date 3RD day of October 2016 A.D.

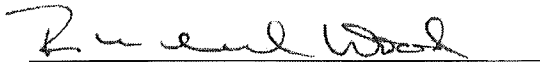

R. Michael Wood
Registered Professional Land Surveyor
No. 5974 - State of Texas

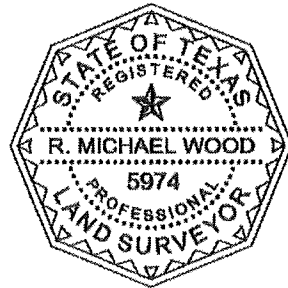

"EXHIBIT B"

NOTES:

1. BEARINGS SHOWN HEREON ARE GRID NORTH, BASED ON THE TEXAS STATE PLANE COORDINATE SYSTEM, TEXAS SOUTH ZONE, NAD(83). ALL DISTANCES AND COORDINATES ARE GRID.
2. A METES AND BOUNDS DESCRIPTION OF EVEN DATE WAS PREPARED (416006FND.DOCX) AND IS MADE OF PART OF THIS SURVEY PLAT.
3. THIS SURVEY PREPARED WITHOUT THE BENEFIT OF A TITLE COMMITMENT, THEREFORE ALL EASEMENTS AND RIGHTS-OF WAY MAY NOT BE SHOWN.
4. ORIGINAL SURVEYS ARE SIGNED AND SEALED IN RED INK. ALL OTHER COPIES ARE NULL AND VOID.

LEGEND

- 1/2" IRON ROD SET WITH CAP STAMPED "CDS/MUERY S.A. TX"
- COTTON SPINDLE FOUND

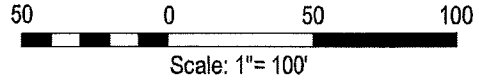

A TWENTY (20.00) FOOT WIDE DRAINAGE EASEMENT CONTAINING 0.606 OF AN ACRE AND BEING THE EAST 20.00 FEET OF FARM TRACT 1119, WEST AND ADAMS TRACT SUBDIVISION AS RECORDED IN VOLUME 2 PAGES 34 THROUGH 37, OF THE PLAT RECORDS OF HIDALGO COUNTY, TEXAS

AND
A THIRTY (30.00) FOOT WIDE TEMPORARY CONSTRUCTION EASEMENT CONTAINING 0.909 OF AN ACRE OUT OF FARM TRACT 1119, WEST AND ADAMS TRACT SUBDIVISION AS RECORDED IN VOLUME 2 PAGES 34 THROUGH 37, OF THE PLAT RECORDS OF HIDALGO COUNTY, TEXAS

I, R. MICHAEL WOOD, A REGISTERED PROFESSIONAL LAND SURVEYOR, DO HEREBY CERTIFY THAT THIS SURVEY WAS PREPARED USING INFORMATION OBTAINED BY AN ON THE GROUND SURVEY MADE UNDER MY DIRECTION AND SUPERVISION.

R. Michael Wood 10/3/16
R. MICHAEL WOOD, R.P.L.S. No. 5974

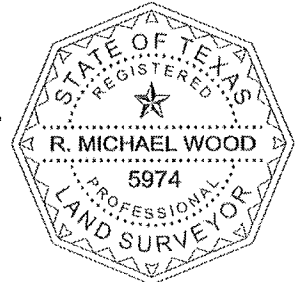

2290 W. PIKE BLVD., SUITE 102 WESLACO, TEXAS 78596 • O: (956) 854-4930 F: (956) 375-2053
TBPE NO. F-1733 • TBPLS NO. 10194080

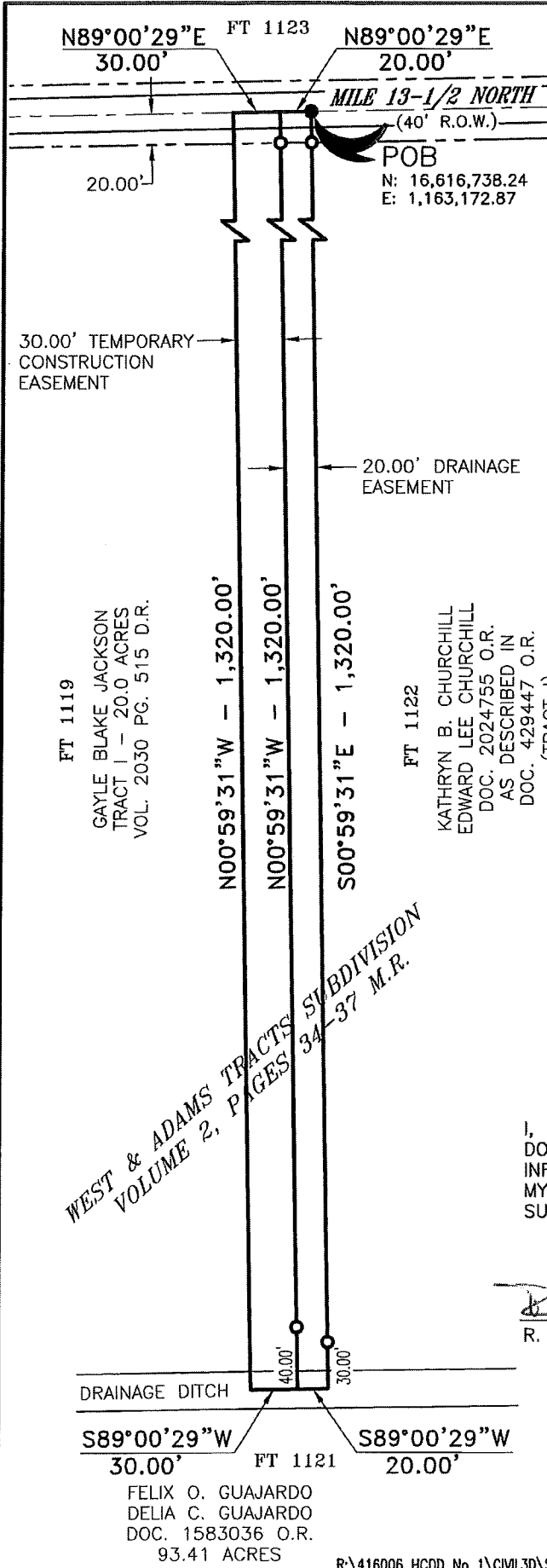

AI -57411

8.

DRAINAGE DISTRICT

Meeting Date: 11/22/2016

Submitted For: Jaime Salazar

Submitted By: Moises Salazar, DRAINAGE DISTRICT

Department: DRAINAGE DISTRICT

Information

CAPTION

A.) Requesting approval of final negotiated Professional Services Agreement with Millennium Engineers Group, Inc., as it relates to Material Testing Services for Kenyon Rd. & Mile 17 Area Drainage Improvements Project. Approved for negotiations by HCDD1 Board of Directors on June 14, 2016.

B.) Pursuant to the Boards approval of Professional Services Agreement with Millennium Engineers Group, Inc., requesting approval of Work Authorization No. 1 in the amount of \$24,828.25 as it relates to On Call Construction Material Testing Services for Kenyon Rd. & Mile 17 Area Drainage Improvements Project.

BACKGROUND

Fiscal Impact

Attachments

Agreement CMT -MEG

AI#55034 Minutes -Selection of MEG

C-HCDD1-16-045A-11-22-WA-1 -CMT MEG

Form Review

Inbox

Reviewed By

Date

Final Approval

Monica Badillo

11/18/2016 05:28 PM

Form Started By: Moises Salazar

Started On: 11/17/2016 10:05 AM

Final Approval Date: 11/18/2016

THE STATE OF TEXAS §
§
COUNTY OF HIDALGO §

PROFESSIONAL SERVICES AGREEMENT
C-HCCD1-16-045A-11-22

THIS AGREEMENT is made effective the 22ND day of November, 2016 by and between **HIDALGO COUNTY DRAINAGE DISTRICT NO 1, TEXAS**, ("District") and **Millennium Engineers Group, Inc.**, a Texas Corporation ("Laboratory").

WITNESSETH:

WHEREAS, the District is vested with the responsibility of providing "**CONSTRUCTION MATERIALS TESTING SERVICES**" for the **Kenyon Road and Mile 17 Area Drainage** project (the "Services");

WHEREAS, the District has determined that the services of a professional laboratory company is necessary to carry out the required Services;

WHEREAS, pursuant to Texas Government Code Chapter 2254.002, (the "Texas Professional Services Procurement Act"), the District requested Statements of Qualifications (SOQ's) from a professional laboratory to assist the District by providing the Services;

WHEREAS, District has selected the Laboratory to provide the Services within **Hidalgo County Drainage District No. 1**, in accordance to Exhibit "A-1" Request for Qualifications (RFQ) Procurement Packet.

NOW THEREFORE, in consideration of the mutual covenants and agreements herein contained, District and Laboratory do mutually agree as follows:

1. Scope of Services. The District will provide to Laboratory the services described in Exhibit "A" attached hereto and entitled "Services to be Performed by District." Laboratory agrees to provide to District with the work described in Exhibit "B", "Services to be Performed by the Laboratory".

2. Term. This Agreement is for a period of **one (1) year**, effective **November 22, 2016** and will expire **November 21, 2017** or unless sooner terminated as provided herein. The Laboratory will not begin to work or incur costs until authorized in writing by the District with each "Work Authorization".

3. Compensation. The maximum amount payable under this Agreement shall not exceed the amount for each work authorization unless an amendment is executed as provided hereinafter. The Laboratory shall submit periodic requests for payment within (30) thirty days after completion of each Work Authorization. The request for payment shall be made using forms acceptable to the District and shall show the total amount earned to the date of submission and the amount due and payable as of the date of the current billing. Upon receipt of said request for payment, District shall submit a requisition for payment for said Services in the customary manner provided for payments utilized by Hidalgo County, Texas. Laboratory agrees to separately account for the receipt and/or expenditure of funds received pursuant to this Agreement and to keep accurate books and records of all such receipts and/or expenditures. All payments to Laboratory shall be mailed to the address shown in numbered paragraph 23 herein.

4. Inspection of Work. The District has the right at all reasonable times to inspect or otherwise evaluate the work performed hereunder and the premises in which it is being performed. If any inspection or evaluation is made on the premises of the Laboratory, or of a subcontractor, the Laboratory shall provide and require its subcontractor to provide all reasonable facilities and assistance for the safety and convenience of the inspectors in the performance of their duties. All inspections and evaluations shall be performed in such a manner as will not unduly delay their work.

5. Amendments. If it becomes necessary at any time during this Agreement to change the scope of Services, the Agreement period, the maximum amount payable, the complexity, or the character of this Agreement, an amendment shall be executed by use of a (Supplemental

Agreement Form) more particularly described in Exhibit "E" within the agreement. The District retains the right to reject any such amendment proposed by the Laboratory. Any such amendments shall be made in writing, agreed to by all parties hereto, and duly executed before the end of the Agreement as specified. If the District finds it necessary to require changes in completed work because of errors made by the Laboratory, the District shall require the Laboratory to correct the work at no cost to the District and without amendment to the Agreement. If the changes are made at the request of the District and are not due to errors of the Laboratory, the District will reimburse the Laboratory for the additional work at the same rate of pay established in Exhibit "C," "Laboratory Rates." If payment for the additional work will cause the maximum amount payable under this Agreement to be exhausted, an amendment shall be proposed in accordance with all State procurement laws.

6. Reporting. The Laboratory shall promptly advise the District in writing of events which have a significant impact upon the Agreement, including:

- a. Problems, delays, or adverse conditions which will materially affect the ability to meet time schedules and goals, or preclude the attainment of project work units by established time periods. This disclosure shall be accompanied by a statement of the action taken, or contemplated and any District or, if Federal Funds are involved, Federal assistance needed to resolve the situation.
- b. Favorable developments or events which enable meeting time schedules and goals to be met sooner than anticipated or which are producing more work units than originally projected.

7. Ownership of Documents. Upon completion or termination of this Agreement, all documents prepared by the Laboratory or furnished to the Laboratory by the District shall be delivered to and become the property of the District. All sketches, photographs, calculations, and other data prepared under this Agreement shall be made available, upon request, to the District without restriction or limitation on their further use. The Laboratory may, at its own

expense, have copies made of the documents or any other data furnished to the District under this Agreement.

8. Suspension of Work. Should District desire to suspend the work under this Agreement, but not terminate this Agreement, the District shall provide thirty (30) calendar days verbal notification to Laboratory, followed by written confirmation from the District to Laboratory to that effect. The thirty-day notice may be waived as agreed in writing by both the District and Laboratory to that effect. The work under this Agreement may be reinstated and resumed in full force and effect within sixty (60) days of receipt of written notice from the District to the Laboratory. The sixty-day notice may be waived as agreed in writing by both the District and Laboratory. If the District suspends the work, the Termination Date as identified above is not affected and this Agreement will terminate on the date specified.

9. Progress and Coordination. The Laboratory shall, from time to time during the progress of the work, confer with the District. The Laboratory shall prepare and present such information as may be pertinent and necessary, or as may be requested by the District, in order to evaluate features of the Laboratory's services and work.

At the request of the District or the Laboratory, conferences shall be provided at the Laboratory's office, the offices of the District, or at other locations designated by the District. These conferences shall also include evaluation of the Laboratory's services and work when requested by the District.

All applicable study reports shall be submitted in preliminary form for approval by the District before the final report is issued. The District's comments regarding the Laboratory's preliminary report will be addressed by the Laboratory in the final report.

If funds by other agencies or entities are to be used for the development of the project under this Agreement, the Laboratory's Services and work will be subject to periodic review and approval by other agencies or entities, including those of the city, county, state and/or federal agencies.

Should it be determined that the progress in the production of the Laboratory's Services and work does not satisfy the requirements of the approved Work Authorization as provided by Exhibit "D", attached hereto, the District shall review the approved Work Authorization with the Laboratory to determine the corrective action needed by either the District or the Laboratory.

The Laboratory shall promptly advise the District in writing of events which have a significant impact upon the progress of the Laboratory's Services and work and the approved Work Schedule, including:

- a. problems, delays, adverse conditions which will materially affect the ability to attain Agreement objectives, prevent the meeting of time schedules and goals, or preclude the timely completion and submittal of Project deliverables by the Laboratory within established time periods; this disclosure will be accompanied by a statement by the Laboratory of recommended or immediate action taken, or contemplated, and any Owner or other agency or entity assistance needed to resolve the situation: and
- b. favorable developments or events which enable meeting the Work Schedule goals sooner than anticipated.

10. Independent Contractor. Laboratory must comply with all applicable Hidalgo County Drainage District No. 1 policies and with any applicable federal, state or local laws, regulations, orders or ordinances applicable to the Services provided by Laboratory under this Agreement. Notwithstanding the foregoing sentence, Laboratory represents and maintains that it is an Independent Contractor and is not an employee of Hidalgo County Drainage District No. 1, Texas or any agency thereof, and represents and warrants that it does not desire or request any fringe benefits provided to employees of Hidalgo County Drainage District No. 1, Texas, and/or any agency thereof, including, but not limited to benefits associated with Hidalgo County's Drainage District No. 1 civil service program. Laboratory agrees to be responsible for

any federal income tax, withholding or social security tax liability that might arise from payments received hereunder.

11. Subcontracting and Assignment. The Laboratory shall not assign subconsultant or transfer the Laboratory's interest in this Agreement without the prior written consent of the District. The Laboratory shall bind every subconsultant by written agreement to observe all the terms of this Agreement to the extent that they may be applicable to each subconsultant. No subcontractor relieves the Laboratory of any responsibilities under this Agreement.

12. Voluntary Termination. District may terminate this Agreement at any time for any reason or no reason at all upon giving thirty (30) days prior written notice to the Laboratory.

13. Insurance. Laboratory agrees to provide liability insurance covering its activities in providing the Services for District in an amount not less than the minimum amounts prescribed by the Texas Tort Claims Act, §100.001, et seq., Texas Civil Practices and Remedies Code, and shall furnish District a certificate issued by the insurer that such insurance is in full force and effect.

14. Payment of Franchise Tax. The Laboratory hereby certifies that the Laboratory is not delinquent in Texas franchise tax payments, or that the Laboratory is exempt from, or not subject to, such tax. A false statement concerning corporation's franchise tax status shall constitute grounds for termination of the Agreement at the sole option of the District.

15. No Assignment. Except as otherwise herein provided, Laboratory may not assign the obligations or rights under this Agreement to any person without the prior written consent of District.

16. Conflict. Nothing in this Agreement shall be construed so as to require the commission of any act contrary to law, and whenever there is any conflict between any provision of this Agreement and any present or future law, ordinance or administrative, executive or judicial regulation, order or decree, or amendment thereof, contrary to which the

parties have no legal right to Agreement, the latter shall prevail, but in such event the affected provision or provisions of this Agreement shall be modified only to the extent necessary to bring them the legal requirements and only during the time such conflict exists.

17. Termination by District. If Laboratory fails to deliver quality Services, fails to achieve the defined goals, outcomes, strategies and outputs required by District, or if Laboratory fails to comply with any conditions in this Agreement, then District shall have the right to terminate this Agreement upon the giving of ten (10) days prior written notice to Laboratory.

18. No Waiver. No waiver by District of any breach of any provision of this Agreement shall be deemed to be a waiver of any preceding or succeeding breach of the same or any other provision hereof.

19. Entire Agreement. This Agreement contains the entire agreement between the parties hereto, and each party acknowledges that neither has made (either directly or through any agent or representative) any representations or agreements in connection with this Agreement not specifically set forth herein. This Agreement may be modified or amended only by agreement in writing executed by District and Laboratory, and not otherwise.

20. Venue. This Agreement shall be construed under and in accordance with the laws of the State of Texas, and all obligations of the parties created hereunder are performable in Hidalgo County, Texas. The parties hereby consent to personal jurisdiction in Hidalgo County, Texas.

21. Hold Harmless. In the event Laboratory should cause, either directly or indirectly, damage, loss, destruction, liability, or claims against the other party as a result of intentional conduct, negligence or otherwise, Laboratory shall hold harmless and indemnify District from any and all obligations, liabilities, cause of action, lawsuits, damages, and assessments, including legal fees, etc., that from the Laboratory's intentional actions or

negligence. This indemnification clause shall survive this Agreement and be enforceable as a separate agreement in the event its survival and enforcement becomes necessary.

22. Attorney's Fees. In the unlikely event that a dispute occurs which is litigated, or a cause of action in law or equity is filed concerning the operation, construction, interpretation, or enforcement of this Agreement, the losing party shall bear the cost of the attorney's fees incurred by the prevailing party and any and all costs applicable thereto, including, but not limited to, court costs, deposition fees, expert witness fees, out-of-pocket expenses and travel expenses which are incurred by the prevailing party.

23. Notices. Except as may be otherwise specifically provided in this Agreement, all notices, demands, requests or communications required or permitted hereunder shall be in writing and shall either be (i) personally delivered against a written receipt, or (ii) sent by a registered or certified mail, return receipt requested, postage prepaid and addressed to the parties at the addresses set forth below, or at such other addresses as may have been theretofore specified by written notice delivered in accordance herewith:

If to District: Hidalgo County Drainage District No. 1
Attention: Raul E. Sese, PE, CFM General Manager
Floodplain Administrator
902 North Doolittle Road
Edinburg, Texas 78542

If to Laboratory: Millennium Engineers Group, Inc.
Attention: Raul Palma, P.E.
5804 N. Gumwood Ave.
Pharr, Texas 78577

Each notice, demand, request or communication which shall be delivered or mailed in the manner described above shall be deemed sufficiently given for all purposes at such time as it is personally delivered to the addresses or, if mailed at such time as it is deposited in the United States mail.

24. Executions of Documents. The parties hereto covenant and agree that they will execute such other and further instruments and documents as are or may become necessary or convenient to effectuate and carry out the terms of this Agreement.

25. Binding Agreement. This Agreement shall be binding upon and inure to the benefit of the parties hereto and their respective heirs, executors, administrators, legal representatives, successors, and assigns where permitted by this Agreement.

26. Gender. All pronouns used in this Agreement shall include the other gender, whether used in the masculine, feminine or neutral gender, and the singular shall include the plural whenever and as often as may be appropriate.

27. Authority. The execution and performance of this Agreement by District and Laboratory have been duly authorized by all necessary laws, resolutions or corporate action, and this Agreement constitutes the valid and enforceable obligations of District and Laboratory in accordance with its terms.

28. Professional Seal. All documents and data furnished by the Laboratory to the District shall bear Professional seal of a licensed Engineer employed by the Laboratory.

29. Commitment of Current Revenues Only. In the event that, during any term hereof, the Commissioners Court does not appropriate sufficient funds to meet the obligations of Buyer under this Agreement, Buyer may terminate this Agreement upon ninety (90) days written notice to Seller. Buyer agrees, however, to use reasonable efforts to secure funds necessary for the continued performance of this Agreement. The parties intend this provision to be a continuing right to terminate this Agreement at the expiration of each budget period of Buyer pursuant to the provisions of Tex. Loc. Govt. Code Ann. ' 271.903 (Vernon Supp. 1996).

30. Immunities. Nothing in this Agreement is intended to and District does not hereby waive, release or relinquish any right to assert any of the defenses District enjoys by virtue of the state or federal constitution, laws, rules or regulations, and any sovereign, official or

qualified immunity available to District as to any claim or action of any person, entity, or individual against District.

EXECUTED as of the day and year first written above.

HIDALGO COUNTY DRAINAGE DISTRICT NO. 1, TEXAS

By: _____
Hon. Ramon Garcia, Chairman of the Board

LABORATORY:

MILLENNIUM ENGINEERS GROUP, INC.

By: _____

Printed Name Raul Palma, P.E.

Title: President

APPROVED AS TO FORM:

Atlas, Hall & Rodriguez, L.L.P.

By: _____
Stephen L. Crain, Attorney

ATTACHMENTS:

- EXHIBIT A** -Scope of Services to be provided by the County
- EXHIBIT B** -Scope of Services to be provided by the Laboratory
- EXHIBIT C** -Laboratory's Rates
- EXHIBIT D** -Work Authorization Form
- EXHIBIT E** -Supplemental Agreement Form
- EXHIBIT F** -Certificates of Insurance

Approved by Commissioners' Court on: _____, 2016

EXHIBIT A-1

-Request for Qualifications (RFQ) Procurement Packet

#14
 COPY

STATEMENT OF QUALIFICATIONS

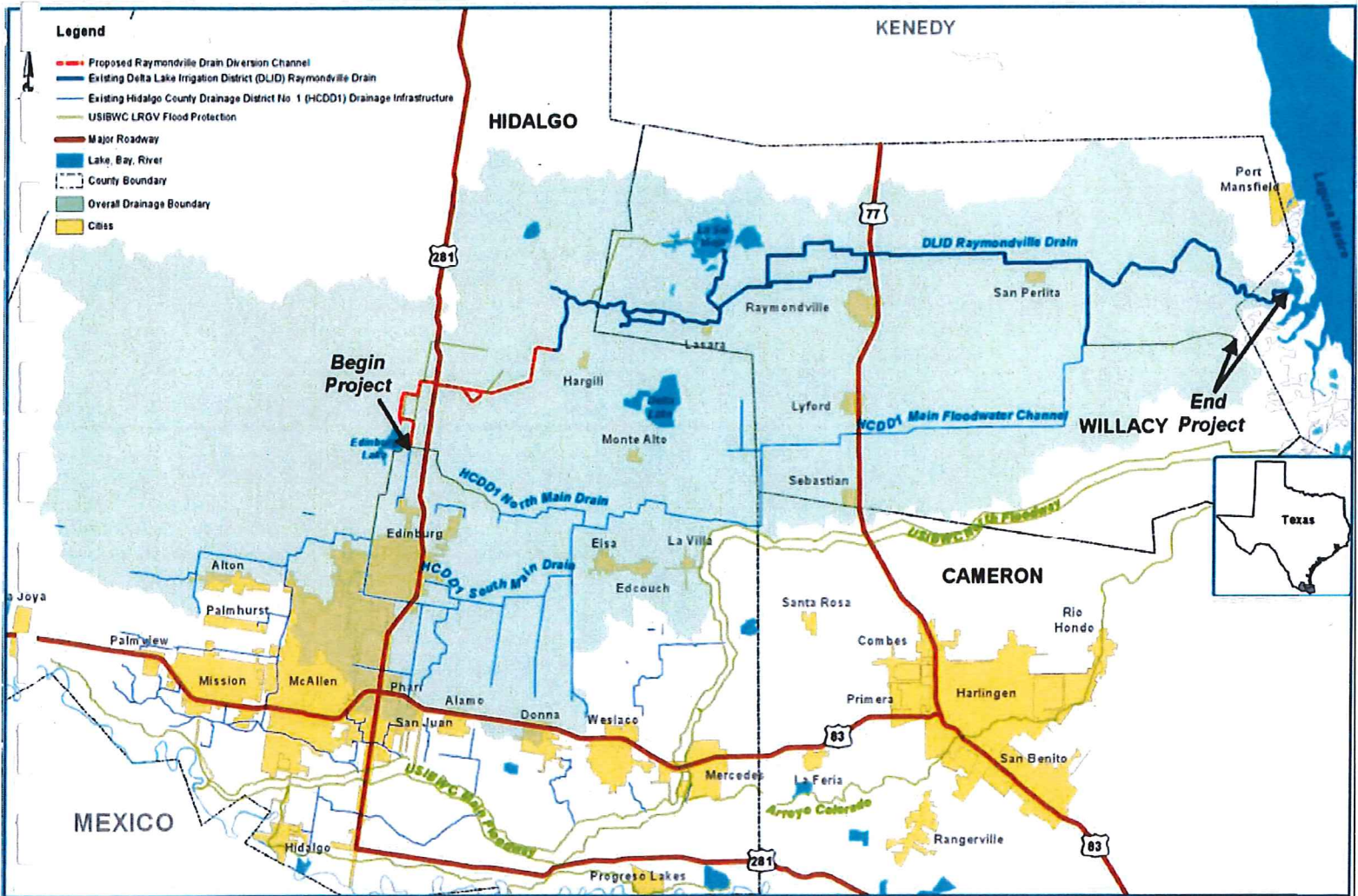

Professional Engineering Services - Pool

HCDD1-16-001-02-17





Table of Contents

Part 1	Statement of Interest	1
Part 2	Firm Introduction	2
Part 3	Project Team	7
Part 4	Representative Projects	14
Part 5	References	17
Part 6	Workload Capacity / Quality Assurance	20

Attachments **Engineering Licenses, Procurement Form, Certificate of Insurances, Project Requirements, Conflict of Interest ,Proposer Affidavit, Vendor Application HUB Declaration, W-9 Form Certification Regarding Debarment**

February 29, 2015

Mr. Jaime J. Salazar, Buyer
Hidalgo County Drainage District No. 1
902 N. Doolittle
Edinburg, Texas 78542
Jaime.salazar@hcdd1.org



**Re: Statement of Qualifications for Professional Engineering Services – Pool
Geotechnical Engineering Projects, RFQ NO. HCDD1-16-001-02-17**

Dear Mr. Salazar:

The County of Hidalgo is looking for the most qualified engineering consultant to work with the county to provide geotechnical engineering services and material testing for the county projects. Millennium Engineers Group, Inc. (MEG) is that firm. We believe that MEG is the right choice for the county based on the following:

History of Stability and Strong Rio Grande Valley Presence

MEG is a locally owned corporation that has never been sold or acquired, or merged with other entities. Furthermore, Mr. Raul Palma, P.E. President and Owner of MEG has 34 years of engineering experience in the Rio Grande Valley and is the former TxDOT Pharr District Materials Engineer. In May of 2014, we recently moved into our new two building, 9000 sf. testing facility. MEG is stable and we have invested in the future. We are consistent and we're not going anywhere. ***We are confident that the people and company you see in the Rio Grande Valley today will be the people and company you see for the life of your projects***

Experienced Project Manager

As your project manager, I have spent over 34 years working on Rio Grande Valley projects including 15 years as the president and chief engineer of MEG completing various successful projects within the Hidalgo County Drainage District No. 1.

Pride in Execution

MEG is acutely aware of the financial and management challenges facing most colleges these days. We are committed to:

- Working to identify and implement projects in the most cost effective manner.
- Communicating closely with the college to meet your requirements and schedule.
- Knowledge of geotechnical solutions for cost effective construction methods.
- Dedicated to quality: AASHTO accredited laboratory.

Our team is thrilled about the opportunity to serve the Hidalgo County Drainage District No. 1 and is ready to start immediately upon selection. If you have any questions or would like to discuss our approach or team capabilities in greater detail, please contact me at anytime at 956/708-8500, 956/648-4488 or at rpalma@megengineers.com. Thank you for your consideration.

Respectfully,
MILLENNIUM ENGINEERS GROUP, INC
TPBE Firm No.: F-3913

A handwritten signature in blue ink that reads "Raul Palma".

Raul Palma, P.E.
President / Chief Geotechnical Engineer

■ PHARR ■ HARLINGEN ■ SOUTH TEXAS ■

Millennium Engineers Group, Inc. | 5804 N. Gumwood Pharr, Texas 78577 | O 956.702.8500 F 956.702.4180



Firm Introduction

In the Rio Grande Valley MEG is

Innovative

Responsive

Professional

Convenient

Reliable

Our Services

Geotechnical Engineering

Construction Materials Testing

Consulting

Forensics



Millennium Engineers Group, Inc. (MEG) provides complete geotechnical engineering and consulting services, construction material engineering and testing, forensic testing and consulting services to its client base of government and municipal agencies, educational institutions, architects, engineers, real estate developers, constructors, and private sector clients. Our strength is our people; combining their experience and collaborating as a unit enables us to quickly identify our roles and deliver accurate cost effective deliverables. Whether defining a new working relationship or continuing on to the next project our mission remains the same: to achieve yours.

History

MEG was founded in 2001 by Mr. Raul Palma, P.E. on the principles of honesty, integrity, and service. The goal to provide innovative geotechnical and material testing services, continue to raise the level of quality in the local profession, and make a difference in the community. Today, MEG provides a full range of integrated geotechnical engineering and consulting services, construction material engineering and testing, forensic testing and consulting services. Our philosophy and practices have been positively reflected in both client and employee loyalty and contribute to a steady growth in a diversity of projects.

Quality Accreditation and Business Certification

- MEG is accredited by the American Association of State Highway and Transportation Officials (AASHTO) and is audited by an independent AASHTO auditor, as part of our accreditation process.
- MEG is a minority owned and operated business certified as:
 - Historically Under-utilized Business (HUB)
 - Small Business Enterprise (SBE)
 - Minority Business Enterprise (MBE)
 - Emerging Small Bus. Enterprise (ESBE)
 - Hispanic American Bus. Enterprise (HABE)
- MEG meets the requirements for ASTM E329 Standard of Recommended Practice for Inspection and Testing Agencies, and maintains yearly proficiency testing samples to AASHTO, TxDOT, and TxAPA.





Personnel and Resources

Personnel

- 3 Registered Professional Engineers
- 1 Engineer in Training
- 1 Materials Testing Manager
- 1 Geotechnical Manager
- 1 CMT Supervisor / Dispatcher
- 1 Geotechnical Drilling Crew
- 8 Engineering Technicians
- 1 CAD Designer
- 3 Administrative Staff

Millennium Engineers Group, Inc. (MEG) has the ability to meet your schedule and deadline because of its thorough training and understand of its CLIENTS needs, its resources, MEG's resources, MEG's subcontractors resources, and industry requirements. MEG employs a staff of 15 individuals comprising of geotechnical engineers, engineering technicians, inspectors, and support staff. Our firms has personnel and laboratory equipment to provide geotechnical engineering and construction materials testing services in the following areas.

Equipment

- Atterberg Limits
- Moisture Contents
- Minus No.200 Sieve Analysis
- Dry Sieve Analysis
- Moisture Density Relationships
- Density Testing
- California Bearing Ratio (CBR)
- Optimum Cement or Lime Content for Stabilization of Soils
- Classification of Soils
- Hydrometer
- Consolidation
- Triaxial Testing
- Unconfined Compression
- Deleterious Material Determination
- Decantation of Aggregates
- Wet Ball Mill
- Ph Testing
- Aggregate Resistivity Testing
- Aggregate Soundness
- Concrete Testing
- Asphalt Testing
- Mortar and Grout Testing
- Concrete Material Designs
- Hot Mix Asphaltic Concrete Designs
- 2-Concrete Compression Machines
- 1-Three Point Conc. Beam Compression
- 5-Ovens
- 6-Measuring Scales
- 1-Concrete Curing Room
- 2-Concrete Saws
- 1-Asphalt Ignition Oven
- 1-Asphalt Gyration Press
- 5-Manual Proctor Hammer
- 1-Automatic Proctor Hammer
- 1-Hveem Stability
- 1-Gilson 50 Gallon Sample Shaker
- 1-Sand Equivalent
- 2-Computerized One Dimensional Consolidation Frames
- 1-Computerized Triaxial Load Frame
- 4-Sieve Analysis Shakers
- 3-Sample Splitters
- Sulfate Testing

Staff Summary

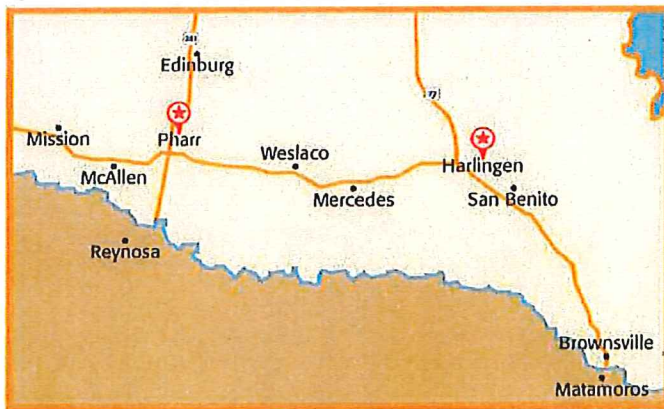

Pharr Office

Point of Contact: Raul Palma, P.E.
5804 N. Gumwood
Pharr, Texas 78577
O 956.702.8500 F 956.702.4180
E rpalma@megengineers.com

Harlingen Office

Point of Contact: Andres Palma, P.E.
1221 E. Tyler Ave.
Harlingen, Texas 78550
O 956.622.7077 F 956.702.4180
E apalma@megengineers.com



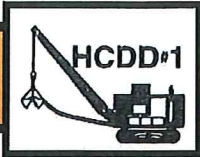

Recent Experience

MEG understands the needs and goals of local government, municipalities and school districts during times of growth and this economy. We have experience working on similar projects involving geotechnical engineering & construction material testing services. Below is a recent list of local government, municipalities and school districts for your consideration:

Hidalgo County Precinct No. 2

Hidalgo County Precinct No. 4

Hidalgo County Precinct No. 1

Hidalgo County Urban County

Hidalgo County Appraisal District

Hidalgo County Drainage District No. 1

City of Harlingen

City of Edinburg

City of Pharr

City of Alamo

City of San Juan

City of Weslaco

City of Hidalgo

City of Rio Grande City, Roma, Sullivan City

City of La Villa, Palmview, Alton, Primera, Progreso

La Joya Independent School District

Edinburg Consolidated Independent School District

Pharr San Juan Alamo Independent School District

Valley View Independent School District

Hidalgo, Lasara, Santa Rosa, Roma Independent School Districts



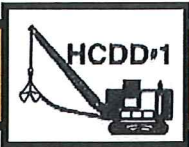

Management Plan

MEG will manage the project by implementation of the project team, project understanding, project approach, and organizational chart provided in this submittal. Mr. Raul Palma, P.E. will be the project task leader and will be responsible for the implementation of the management plan. If a subconsultant is required the subconsultant will provide services on an as needed basis if applicable. MEG and the subconsultant are corporations of the State of Texas. The lines of authority and communication will be as follows:

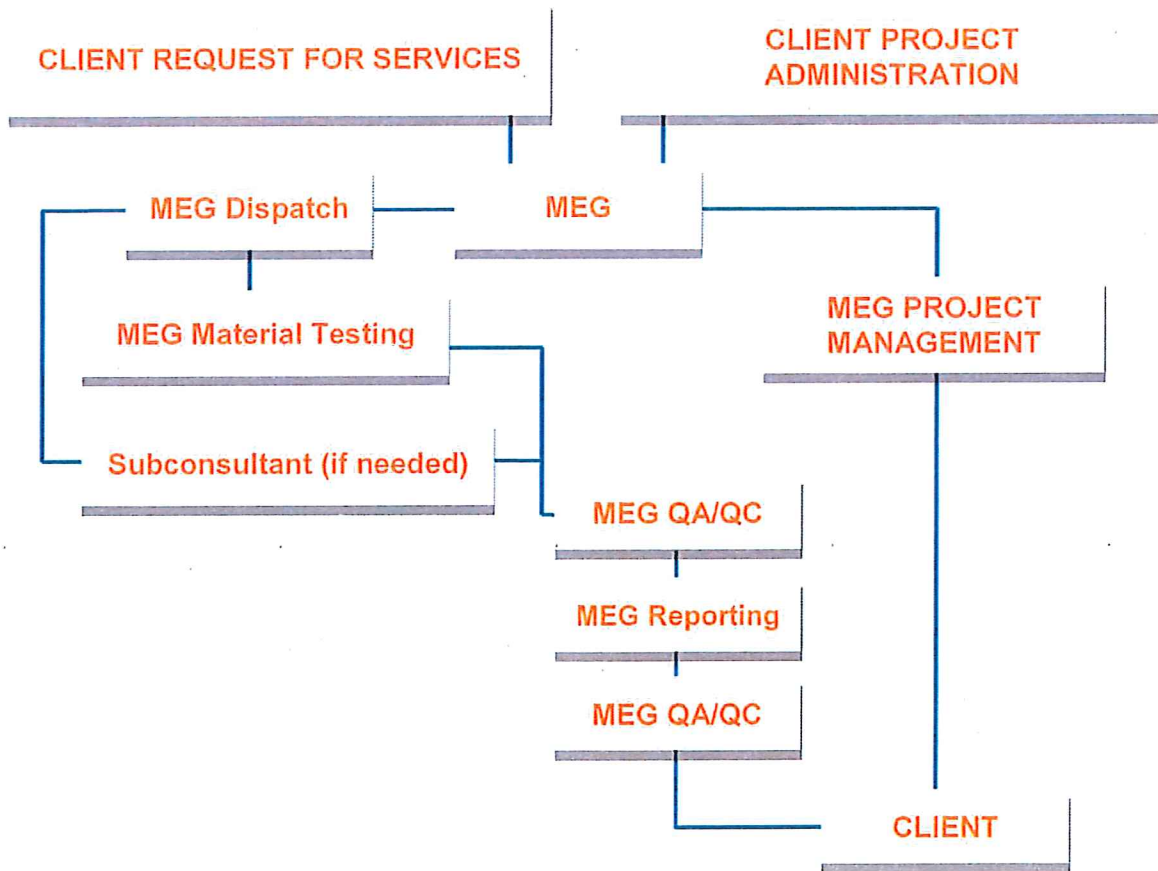

MEG will manage the personnel used for the project by the Current Workload/Firm Availability section of this submittal. The coordination and exchange of information can be sent electronically via email, on cloud computing via a shared server or any other method the CLIENT may want to utilize. The CLIENT will designate on our project information sheet which parties will receive project information and/or project reports.



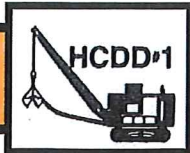

Project Commitment

MEG is committed to your projects, program, goals, and timelines for project schedule. We will provide the essential staff, equipment and resources to be available and responsive daily for the geotechnical engineering, construction materials testing/inspection services for the proposed drainage district projects. Our Pharr office is equipped and trained to provide the level of service and responsiveness required by Hidalgo County projects. MEG has extensive local resources and expertise to complete large project programs. The key personnel presented in this Statement of Qualifications are committed to the drainage district projects and will be available throughout the life of the project.



■ Project Communication

Communication is the key to all successful projects. The management of the testing and inspection program for the project will begin with the introduction of the project team members. Upon notification of award, our engineers and staff will meet with members of the project team who have an active role in the project. This is a critical phase in to communicate project information, goals, timelines, or potential conflicts.

■ Review of Construction Schedule

MEG will review the most up-to-date construction schedule by task after design documents are completed. The testing and inspection program can best support regulated testing and control final testing costs if we clearly understand the project testing requirements.

■ Construction Meetings

From the initiation of the project until the completion, we propose biweekly or monthly management meetings with the construction manager or his representative and other project team members. At these meetings it is necessary, to review and discuss testing results, project progress, and project schedule.

■ Daily Communication

MEG on site representative will maintain daily communication with the contractor's superintendent, and the designated project team members in order to schedule the required services and to communicate inspection and test results. Our project manager will communicate the results of critical off-site testing and inspections to the designated project team representatives the same day testing is performed.





Project Team

MEG proposes to utilize the latest measurement techniques to effectively perform the services of this agreement with our current staff as proposed in our organization chart. We understand that we need to respond quickly to some service requests, and we are practiced in having staff available on short notice, if necessary. Our current and projected workloads are such that we are confident of our ability to meet the city expectations in terms of having appropriate staff resources available when they are needed. The organization chart below reflects the staff we anticipate using for the proposed projects; however, we have additional personnel that can also be utilized if needed.

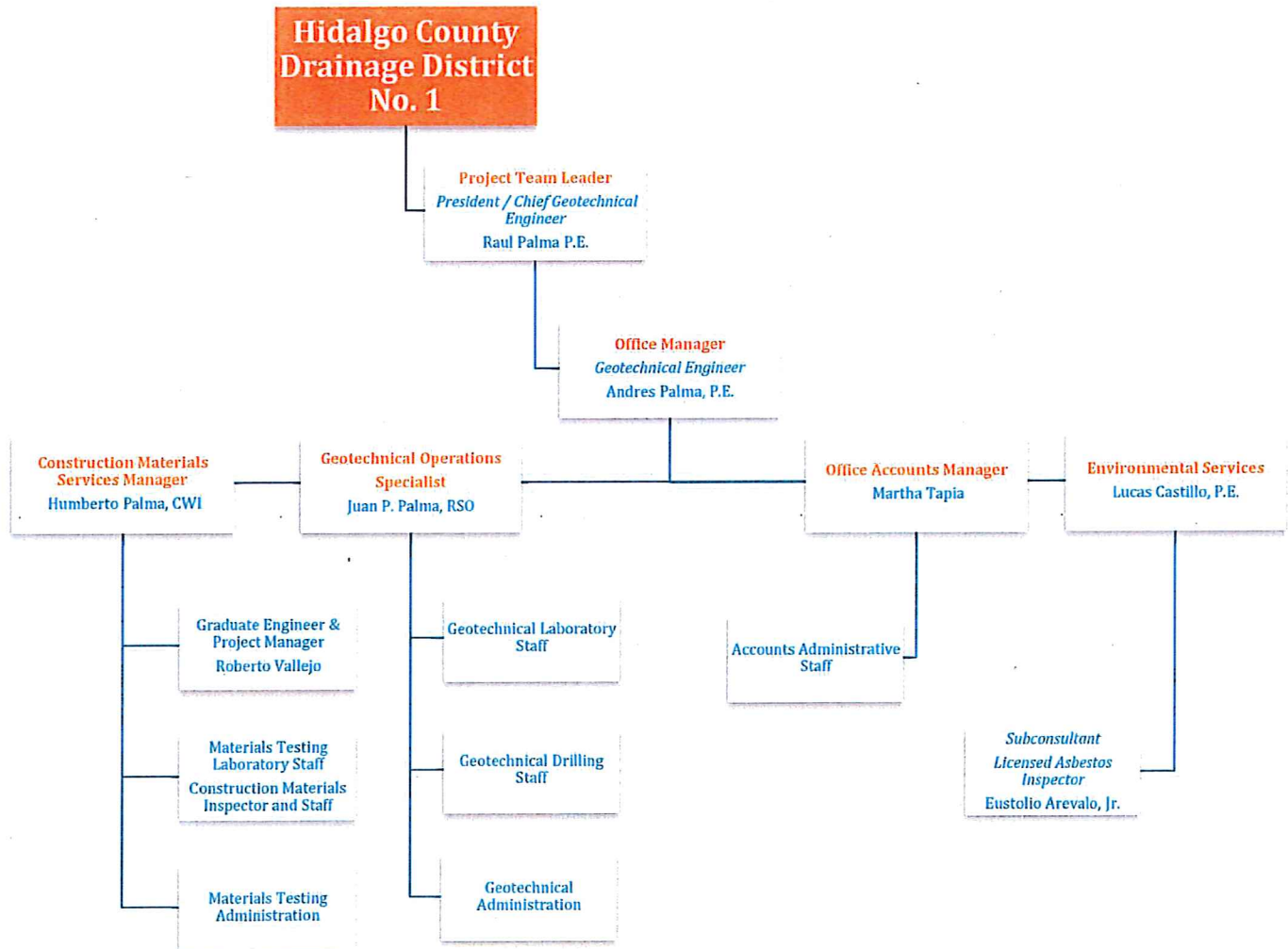



Raul Palma P.E. Principal Engineer

PROFESSIONAL EXPERIENCE

Mr. Palma is a licensed Professional Engineer with over 33 years of experience in geotechnical engineering, construction materials testing, management, and engineering design of highways, streets, and utilities. Mr. Palma has directed and completed a wide variety of geotechnical projects throughout the South Texas region. As President and Chief Geotechnical Engineer of the Pharr, Texas office, he is responsible for overall operations management of the Pharr Office.

As geotechnical project manager, he is responsible for coordination and completion of geotechnical engineering projects. His experience includes subsurface explorations, laboratory testing, foundation investigation and design; slope stability assessments and remediation design, pre-load fill design; geotechnical plans and specifications preparation; and construction monitoring. Client relationships have included city and county agencies; engineering and architectural firms; municipal and utility districts, as well as private developers and constructors.

During Mr. Palma's employment with the Texas Department of Transportation (TxDOT), Mr. Palma gained an extensive background in the area of geotechnical and materials engineering serving as the District Materials Engineer for a centralized laboratory for TxDOT in the Pharr District located in Pharr, Texas. As the District Materials Engineer he was responsible for overseeing the testing and approval of materials for all construction projects in the Cameron, Hidalgo Starr, Zapata, Jim Hogg, Brooks, Willacy and Kennedy counties. At the end of his tenure with TxDOT, the Pharr District had a construction program of approximately \$170 million dollars of construction per year. He oversaw all the geotechnical exploration and soil testing for all bridge and retaining wall structures in these same

Education

*Graduate of Edinburg High School
Edinburg, Texas*

1978

*Bachelors of Science in Civil Engineering
Princeton University, Princeton, New
Jersey*

1982, Cum Laude

Registrations

*Texas Board of Professional Engineers:
Registration Number 65656 is Current*

Affiliations

American Society of Civil Engineers

GEO Institute

American Concrete Institute

Work History

MEG Engineers, Pharr, Texas

President / Chief Geotechnical Engineer

2001- Present

Texas Department of Transportation

Pharr, Texas

District Materials Engineer

1990-2001

Texas Department of Transportation

Pharr, Texas





counties. Mr. Palma also served as the assistant to the State Concrete and Physical Testing Engineer at the Materials & Tests Division of TxDOT and during this period he gained extensive experience in concrete, concrete admixtures, reinforcing steel, and pre-stressed steel. Mr. Palma's extensive experience in the area of materials and geotechnical engineering gives our firm a unique ability to provide services of the highest professional caliber.

PROJECT EXPERIENCE

HIGHWAY AND BRIDGES

- US Highway 83 – FM 494 to Bus 83, Texas Department of Transportation – Mission, Texas
- US 83 Highway – FM 1426 to FM 493, Texas Department of Transportation – Alamo, Texas
- US Highway 83/77 Interchange, Texas Department of Transportation – Harlingen, Texas
- US Highway 77/83 – US 83 S. to LP 499, Texas Department of Transportation – Harlingen, Texas
- US Highway 77/83, Texas Department of Transportation – Brownsville, Texas

HEAVY INDUSTRIAL

- North Edinburg Industrial Park Phase 1, Edinburg EDC – Edinburg, Texas
- North Edinburg Industrial Park Phase 2, Edinburg EDC – Edinburg, Texas
- Pharr Produce District Subdivision Industrial Park, City of Pharr – Pharr, Texas
- Weslaco Industrial Park, Weslaco EDC – Weslaco, Texas
- IBTC Corridor, Hidalgo County Regional Mobility Authority – Hidalgo County, Texas

PUBLIC

- Edinburg Public Safety Building, City of Edinburg – Edinburg, Texas
- Daniel Sekula Memorial Library, City of Edinburg – Edinburg, Texas

- Pharr International Bridge Improvements, City of Pharr – Pharr, Texas
- Edinburg City Hall, City of Edinburg – Edinburg, Texas
- Hidalgo Wastewater Treatment Plant, City of Hidalgo – Hidalgo, Texas

COMMERCIAL

- COSTCO, Klienfelder – Pharr, Texas
- First Community Bank – Brownsville, Texas
- Members First Federal Credit Union – Harlingen, Texas
- Security First Credit Union – Edinburg, McAllen, Pharr, Brownsville, Mission, Texas

EDUCATION

- Nursing & Allied Health Building (NAH), South Texas College – McAllen, Texas.
- Information and Technology Building (IT), South Texas College - McAllen, Texas.
- Instructional Support Services Building (ISS), South Texas College – McAllen, Texas.
- Jaime Escalante Middle School, PSJA ISD – Pharr, Texas
- FJ Scott Elementary School, Roma ISD – Roma, Texas

RETAIL / MIXED-USE

- The Shoppes of the Rio Grande Valley – Edinburg, Texas
- Riverview Retail Center – Roma, Texas
- Morrison Crossing Retail Center – Brownsville, Texas
- Auto Zone Stores – McAllen, Roma, Texas
- Goodwill Stores – Edinburg, McAllen, Edinburg

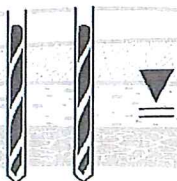



Andres Palma P.E. Geotechnical Engineer

PROFESSIONAL EXPERIENCE

Mr. Palma serves as office manager of MEG's Pharr, Texas office. He has over 13 years experience in the engineering industry and vast knowledge in geotechnical engineering and construction materials testing in the South Texas area. Geotechnical projects that Mr. Palma has been involved with include mixed-use developments, urban mid-rise buildings, educational facilities, airport facilities, parking garages, commercial low-rise to mid-rise buildings, water and wastewater treatment facilities, elevated water towers, industrial facilities, multi-family developments, churches, residential subdivisions and general retail centers. Pavement design projects that Mr. Palma has been involved with include highways, industrial parks, heavy duty brick paving, freight centers and industrial applications.

Mr. Palma's responsibilities as a Geotechnical Engineer include coordination of field personnel, communication with the client, generation of geotechnical engineering reports, evaluating laboratory soil testing, and scheduling and managing field personnel.

Mr. Palma's responsibilities as a Construction Materials Engineer include coordination of field personnel, communication with the client, generation of daily logs and weekly status reports, training of technicians, evaluating laboratory and field construction materials testing data, and scheduling and managing field personnel.

PROJECT EXPERIENCE

EDUCATION

- Jaime Escalante Middle School, PSJA ISD – Pharr, Texas
- La Joya ISD Stadium Improvements, La Joya ISD - La Joya, Texas
- 6 Story Student Dorms, University of Incarnate Word – San Antonio, Texas

Education

*Graduate of Edinburg High School
Edinburg, Texas
2002*

*Bachelors of Science in Civil Engineering
University of Texas San Antonio,
San Antonio
2006*

Registrations

*Texas Board of Professional Engineers:
Registration Number 115936 is Current*

Affiliations

*American Society of Civil Engineers
GEO Institute
American Concrete Institute
Deep Foundation Institute*

Work History

*MEG Engineers, Pharr, Texas
Geotechnical Engineer, 2009-present*

*Professional Service Industries, San Antonio, Texas
Staff Engineer, 2007-2009*

*MEG Engineers, Pharr, Texas
Engineering Staff, 2001-2006*

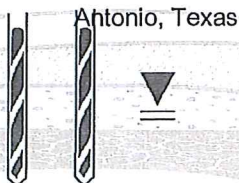



- 9 Story Parking Garage, University of Incarnate Word – San Antonio, Texas
- Edinburg CISD Stadium Improvements – Edinburg, Texas

PAVEMENTS

- SH 365 Hidalgo County Regional Mobility Authority – Hidalgo County, Texas
- IBTC Corridor Hidalgo County Regional Mobility Authority – Hidalgo County, Texas
- Pharr Produce District Industrial Subdivision, City of Pharr – Pharr, Texas
- McIntyre Streetscape Brick Paving, City of Edinburg – Edinburg, Texas
- FedEx Freight Facility – Harlingen, Texas
- North Edinburg Industrial Park – Edinburg, Texas

PUBLIC

- NAWSC Regional Water Treatment Plant – Weslaco, Texas
- City of Hidalgo WWTP Improvements – Hidalgo, Texas
- Hidalgo County Precinct No. 2 Office – Pharr, Texas
- San Antonio International Airport Parking Garage – San Antonio, Texas
- Harlingen Water Works Elevated Water Storage Tank – Harlingen, Texas
- PSJA ISD Stadium Improvements – Pharr, Texas
- La Joya ISD Jimmy Carter High School Forensic – La Joya, Texas
- South Texas Museum of History Jail Structure – Edinburg, Texas

COMMERCIAL

- Morrison Crossing Development – Brownsville, Texas
- The Fingers Development, West Section Improvements – Port Isabel, Texas
- The Shoppes of the Rio Grande Valley – Edinburg, Texas
- Alon Towne Center – San Antonio, Texas
- Renaissance Center Subdivision Development – McAllen, Texas

HEAVY INDUSTRIAL

- Royal Technologies 320,000 sf – Mission, Texas
- Don Hugo Produce 270,000 sf – Edinburg, Texas
- Santana Textiles 500,000 sf combined – Edinburg, Texas
- Loop Cold Storage Expansion – McAllen, Texas
- Brownsville Oil Storage Facility, Port of Brownsville – Brownsville, Texas

RETAIL / MIXED-USE

- The Vistana Condominiums, 17 story – San Antonio, Texas
- Tesoro Corporate Towers, 14 story, 7 Story, Parking Garages – San Antonio, Texas
- Unity Center Development, 6 story & 2 story – McAllen, Texas
- Peninsula Condominium Tower, 7 story – South Padre Island Texas
- Edinburg Student Housing Buildings, 4 story & 3 story – Edinburg, Texas

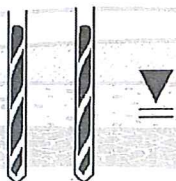

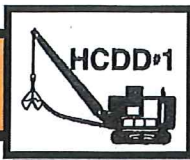

Humberto Palma, CWI

CMT Laboratory Manager Certified Welding Inspector (CWI)

PROFESSIONAL EXPERIENCE

Mr. Palma serves as construction materials testing manager of MEG's Pharr, Texas office. He has over 13 years experience in the engineering & construction industry and vast knowledge in construction materials testing, quality assurance/quality control, and project management in the South Texas area. Construction Material Testing projects that Mr. Palma has been involved with include mixed-use developments, educational facilities, commercial low-rise to mid-rise buildings, water and wastewater treatment facilities, elevated water towers, industrial facilities, multi-family developments, churches, residential subdivisions and general retail centers.

Mr. Palma's responsibilities as a Construction Materials Testing Manager include coordination of field personnel, communication with the client, generation of daily logs and weekly status reports, training of technicians, evaluating laboratory and field construction materials testing data, and scheduling and managing field personnel.

Mr. Palma's responsibilities as a Project Manager include pre-construction documentation, project budget analysis, technical report review, project billing, daily/weekly reporting with clients, attending pre-construction meetings, budget review, and job-site visits. He has experience managing a wide range of projects in both the construction and quality assurance fields.

PROJECT EXPERIENCE

EDUCATION

- Valley View 9th Grade Campus, PSJA ISD – Pharr, Texas
- Nursing and Allied Health Building Addition, South Texas College - McAllen, Texas
- Henry Ford Elementary, PSJA ISD – Pharr, Texas
- Information Technology Building, South Texas College – McAllen, Texas

Education

*Graduate of Donna High School
Donna, Texas
1998*

*Course Study, South Texas College
1999*

Registrations

*Certified Welding Inspector, License
No.08020501*

*Pre-stressed Concrete Institute – PCI
Level I & II Plant Quality*

*Control American Concrete Institute –
ACI Concrete Field Testing Grade I*

*Texas Hot Mix Center, Hot Mix Asphalt
Level I-A Plant Inspection*

*TxDOT Soils Certification Levels SB101,
SB102, SB103 & SB201*

Nuclear Gauge Operation and Safety

Affiliations

American Society of Civil Engineers

American Concrete Institute

American Welding Society

Work History

MEG Engineers, Pharr, Texas

*Construction Materials Testing Manager,
2007-present*

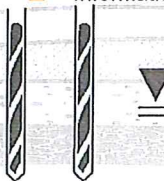

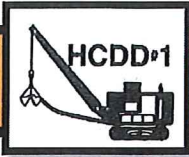

- La Joya ISD Agriculture Building – La Joya, Texas

GOVERNMENT

- Lateral A Levee, United States IBWC – Hidalgo County, Texas
- Main Floodway Levee, United States IBWC – Hidalgo County, Texas
- Mission Segment Levee, United States IBWC – Western Hidalgo County, Texas
- Moore Air Base WWTP Improvements, United States Air Force – Edinburg, Texas
- Moore Air Base Lift Station, United States Air Force – Edinburg, Texas

PUBLIC

- Edinburg City Hall, City of Edinburg – Edinburg, Texas
- City of Hidalgo WWTP Improvements – Hidalgo, Texas
- Hidalgo County Precinct No. 2 Equipment Compound – Pharr, Texas
- Early College Campus, Valley View ISD – Pharr, Texas
- Harlingen Water Works Elevated Water Storage Tank – Harlingen, Texas
- PSJA ISD Stadium Improvements – Pharr, Texas
- Robert Vela High School, Edinburg CISD – Edinburg, Texas

COMMERCIAL

- First Community Bank – Brownsville, Texas
- Popeye's Chicken – Hidalgo & Cameron Counties, Texas
- The Shoppes of the Rio Grande Valley – Edinburg, Texas
- Wells Fargo Bank – McAllen, Texas
- Stripes Convenient Stores – Starr, Hidalgo, Cameron Counties, Texas

HEAVY INDUSTRIAL

- North Edinburg Industrial Park, Phase 1 – Mission, Texas
- Pharr Industrial Park, City of Pharr – Pharr, Texas
- Santana Textiles 500,000 sf combined – Edinburg, Texas
- Loop Cold Storage Expansion – McAllen, Texas
- Weslaco Industrial Park, Weslaco EDC – Weslaco, Texas

RETAIL / MIXED-USE

- Retail / Mixed-Use
- The Shoppes at Rio Grande Valley – Edinburg, Texas
- The Shoppes at 29th Street – McAllen, Texas
- Unity Center Development, 6 story & 2 story – McAllen, Texas
- Morrison Crossing Development – Brownsville, Texas
- Blue Wave Car Wash – Hidalgo & Cameron Counties, Texas

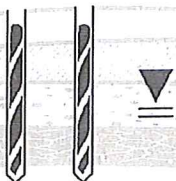



Relevant Project Experience

Mr. Raul Palma, P.E. will be allocated to this project and will serve as the task leader of this project. Mr. Raul Palma, P.E. has been the point of contact and project manager for 14 years on all drainage district projects.

Projects: Rogers Road, Rooth Road, Mile 17, Skinner Road, Mile 17 North, Dillon Road, Sioux Road, Tower Road (North of Pinkston Road), Tower Road (Ramseyer Road to Pinkston Road), Rogers Road (East of 23rd Street), Mile 9 North Road, and Ingle Road.

Hidalgo County Urban County

Construction Materials Testing
Mrs. Diana Serna
Director
(956)787-8127

Projects: Drainage Canal Improvements at Canton Road (East of Cesar Chavez Road), Drainage Canal Improvements at McColl Road (North of Schunior Street)

Hidalgo County Drainage District No. 1

Geotechnical Engineering & Construction Materials Testing
Mr. Godfrey Garza
Drainage District Manager
(956)292-7080

Projects: Westgate Boulevard (Pike Blvd. to Business 83), US Exp. 83 Utility Relocation, Mile 9 Road Improvements, Mid Valley Industrial Park No. 7 (Weslaco EDC)

City of Weslaco
Geotechnical Engineering & Construction Materials Testing
Mr. Bernard Rodriguez & Mr. Leonardo Olivares
Previous Director of Engineering / City Manager
(956) 968-3181

Projects: Rio Grande Produce District, Hall Acres Road, Hi-Line Road, International Bridge Lanes, Various Industrial Parks, Downtown Drainage Improvements Project

City of Pharr
Geotechnical Engineering & Construction Materials Testing
Mr. William F. Ueckert, Jr., P.E.
City Engineer
(956) 702-5335

Projects: City of Edinburg Water Treatment Plant, Edinburg City Hall, Edinburg Library, McIntyre Road, Joe Ochoa Road, Various Roadways, North Edinburg Industrial Park, 2014 24" Waterline

City of Edinburg
Geotechnical Engineering & Construction Materials Testing
Mr. Ramiro Garza, Jr.
City Manager
(956) 388-8207



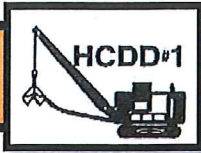

RELEVANT PROJECT EXPERIENCE CONTINUED

Projects: Red Gate Elevated Water Storage Tank, Primary Care Substance Abuse Facility, Hacienda De Los Vega, Lakeview Subdivision, Dillon Road, Foster Subdivision, Seminary Village, Laborsita Subdivision, North Alamo Road, Colonia Esperanza, Val Verde Road, Rogers Road, Brushline Road, Ingle Road, FM2812 (West of US Hwy. 281), Santa Cruz Industrial Park Subdivision, Santa Cruz #2 Subdivision, Health Department Parking, Chapa Road, Washington Avenue, North Doolittle Road (North of FM 2812), Laborsita Subdivision, Colonia Esperanza, 2008 Border Colonia Access Program Round 3, and North Alamo Road.

Hidalgo County Precinct No. 4

Geotechnical Engineering & Construction Materials Testing
Mr. Joseph Palacios
County Commissioner
(956)383-3112

Projects: Precinct 2 Administration Office, Precinct 2 Equipment Compound and Maintenance Facility, I Road (Various Sections), Tower Road (Owassa Road to Minnesota Road), South Tower Road (Hall Acres Road to Rancho Blanco Road), Tower Road (Moore Road to El Gato Road), Esperanza Estates Subdivision, Mesquite Acres Subdivision, Morningside South Subdivision, Rancho Blanco Road (Alamo Road to Tower Road), Rancho Blanco Road (Tower Road to Border Road), Thomas Road, Precinct 2 Multi-Purpose Facility, Colonia Whitewing, South Alamo Park, 2008 Round 1 Colonias (Various), Val Mex Drive, Southfork Drainage Lateral, 2008 3rd Colonia Access Projects (Various), RSW Unit No. 1, Tiny Acres Subdivision, Val Bar Estates, Tower Road Crossing Drainage Improvements, LJ Drainage Lateral, Cesar Chavez Drainage, South Tower Estates Subdivision, Alamo Road Crossing Drainage San Juan, Little Mexico Subdivision and South Tower Estates, and Border Road Improvements.

Hidalgo County Precinct No. 2

Geotechnical Engineering & Construction Materials Testing
Mr. Eduardo "Eddie" Cantu
County Commissioner
(956)787-1891

Projects: Minnesota Road (Valverde Road to Dillon Road), Olivares Road, Old La Blanca Road (Mile 9 North to Mile 10 North)

Hidalgo County Precinct No. 1

Geotechnical Engineering & Construction Materials Testing
Mr. J.C. Cuellar, Jr.
County Commissioner
(956)968-8733





RELEVANT PROJECT EXPERIENCE CONTINUED

Projects: 3rd Street Drainage Improvements, Loop 499 Crossing, 2014 CDBG Road Improvements, 2014 General Fund Overlay Improvements

City of Harlingen
Construction Materials Testing
Mr. Javier Zamora, P.E.
City Engineer
(956) 216-5280

Projects: Wastewater Treatment Plant Addition, Ridge Road Improvements (Alamo Road to Jackson Road), Acacia Avenue, Tower Road (Business 83 to Ridge Road)

City of Alamo
Geotechnical Engineering & Construction Materials Testing
Mr. Luciano Ozuna
City Manager
(956) 787-0006

Projects: City of Hidalgo Wastewater Treatment Plant

City of Hidalgo
Construction Materials Testing
Mr. Joe Vera III
City Manager
(956) 843-2286

Projects: Riverview Phase III Commercial Subdivision, City of Roma TCDP # 726551 Roadway Project, Aqualeguas Steet Improvements, Bethal Street Improvements

City of Roma
Geotechnical Engineering & Construction Materials Testing
Mr. Crisanto Salinas
City Manager
(956) 849-1411

Projects: Primavera Subdivision, Colonia Las Palmas, Sioux Road

City of San Juan
Construction Materials Testing
Mr. J.J. Rodriguez
City Manager
(956) 223-2200

Projects: Santana Textiles Wastewater Treatment Plant, Santana Textiles Facility

Santana Textiles
Geotechnical Engineering & Construction Materials Testing
Ms. Luciana De Castro
Construction Project Manager
(956) 650-6322





References of Representative Projects

1. Hidalgo County Precinct No. 4 Projects

Red Gate Elevated Water Storage Tank, Primary Care Substance Abuse Facility, Hacienda De Los Vega, Lakeview Subdivision, Dillon Road, Foster Subdivision, Seminary Village, Laborsita Subdivision, North Alamo Road, Colonia Esperanza, Val Verde Road, Rogers Road, Brushline Road, Ingle Road, FM2812 (West of US Hwy. 281), Santa Cruz Industrial Park Subdivision, Santa Cruz #2 Subdivision, Health Department Parking, Chapa Road, Washington Avenue, North Doolittle Road (North of FM 2812), Laborsita Subdivision, Colonia Esperanza, 2008 Border Colonia Access Program Round 3, and North Alamo Road.

Mr. Joseph Palacios

County Commissioner, Precinct No. 4

956/383-3112

2. Hidalgo County Precinct No. 2 Projects

Precinct 2 Administration Office, Precinct 2 Equipment Compound and Maintenance Facility, I Road (Various Sections), Tower Road (Owassa Road to Minnesota Road), South Tower Road (Hall Acres Road to Rancho Blanco Road), Tower Road (Moore Road to El Gato Road), Esperanza Estates Subdivision, Mesquite Acres Subdivision, Morningside South Subdivision, Rancho Blanco Road (Alamo Road to Tower Road), Rancho Blanco Road (Tower Road to Border Road), Thomas Road, Precinct 2 Multi-Purpose Facility, Colonia Whitewing, South Alamo Park, 2008 Round 1 Colonias (Various), Val Mex Drive, Southfork Drainage Lateral, 2008 3rd Colonia Access Projects (Various), RSW Unit No. 1, Tiny Acres Subdivision, Val Bar Estates, Tower Road Crossing Drainage Improvements, LJ Drainage Lateral, Cesar Chavez Drainage, South Tower Estates Subdivision, Alamo Road Crossing Drainage San Juan, Little Mexico Subdivision and South Tower Estates, and Border Road Improvements.

Mr. Hector "Tito" Palacios

Former County Commissioner, Precinct No. 2

956/787-1891





3. Hidalgo County Precinct No. 1 Projects

Minnesota Road (Val Verde Road to Dillon Road), Olivares Road, Old La Blanca Road (Mile 9 North to Mile 10 North), Mile 12.5 Road (FM 1015 to Mile 2 Road), Mile 4 West Road (Mile 15 to Mile 16), Sunset Park Improvements.

Mr. A.C. Cuellar, Jr.

County Commissioner, Precinct No. 1

956/968-8733

4. Hidalgo County Urban County Projects

Rogers Road, Rooth Road, Mile 17, Skinner Road, Mile 17 North, Dillon Road, Sioux Road, Tower Road (North of Pinkston Road), Tower Road (Ramseyer Road to Pinkston Road), Rogers Road (East of 23rd Street), Mile 9 North Road, and Ingle Road.

Mrs. Diana Serna

Urban County Director

956/787-8127

5. Hidalgo County Drainage District No. 1 Projects

Drainage Canal Improvements at Canton Road (East of Cesar Chavez Road), Drainage Canal Improvements at McColl Road (North of Schunior Street).

Mr. Godfrey Garza

Drainage District Manager

956/292-7080





References

Geotechnical Engineering & Construction Materials Testing

City of Pharr

Fred Sandoval
City Manager
(956) 702-5335

City of Pharr

William F. Ueckert, Jr., P.E.
City Engineer
(956) 702-5335

City of Edinburg

Ponciano N. Longoria, P.E.,
CFM
Director of Public Works
(956) 388-8210

City of Edinburg

Tomas D. Reyna
Assistant Director of Public Works
(956) 388-8210

City of Harlingen

Javier M. Zamora, P.E. *City Engineer*
(956) 216-5280

City of Hidalgo

Joe Vera, III
City Manager
(956) 843-2286

City of Alamo

Luciano Ozuna, Jr.
City Manager
(956) 787-0006

City of Sullivan City

Judy Davila
City Manager
(956) 485-2828

City of Roma

Crisanto Salinas
City Manager
(956) 849-1411

City of Weslaco

Mardoqueo Hinojosa, P.E.
City Engineer
(956) 447-3401

Hidalgo County Engineering

Dept.

Raul Sesin, P.E.
County Engineer
(956) 292-7000

TxDOT

Marion Jorge, P.E.
District Engineer
(956) 702-6100

TxDOT

Behrooz Badiozzamani, P.E.
Deputy District Engineer
(956) 702-6100

TxDOT

Rosendo Garcia, P.E.
Director of Construction
(956) 702-6100

Hidalgo County Precinct No. 2

Hector "Tito" Palacios
County Commissioner
(956) 787-1891

Hidalgo County Precinct No. 4

Joseph Palacios
County Commissioner
(956) 383-3112

Hidalgo County Precinct No. 1

A.C. Cuellar, Jr.
County Commissioner
(956) 968-8733

Hidalgo County Drainage Dist.

No. 1

Godfrey Garza
Drainage District Manager
(956) 292-7080

Port of Brownsville

Eduardo A. Campirano
Port Director & CEO
(956) 831-4592

South Texas College

Gerry Rodriguez
Director of Facilities
(956) 872-3737





Understanding the Project

The drainage district projects needs are specific to the services we provide, counting on the services we provide to be responsive, thorough, and precise. The projects need efficient communication, project management, and contract administration. The county faces the local issue of expansive soils and economical construction solutions. At MEG we consistently achieve this by:

- Understanding the specific needs of our Client
- Delivering on the expectations of our Client
- Efficient Communication
- Extensive Employee Training and Management
- Proven Consistency, Low Employee Turnover
- Highest Quality Accreditations and Internal Management

MEG has the ability to meet your schedule and deadline because of its thorough training and understanding of its CLIENTS needs, MEG's experience and resources, MEG's subcontractors resources, and industry requirements. MEG has the philosophy of providing quality Construction Materials Engineering and Geotechnical Engineering Services to all our clients in the Rio Grande Valley. We believe that client satisfaction, reputable and prompt service, and staying in stride with the latest technologies and tools will give our firm a unique advantage in providing a service to you as our client. We believe that providing quality service is the key to our client's satisfaction and their inclination to consider our firm in future projects.

The **geotechnical engineering services** contract will encompass all related services to the drainage district including, but not limited to, the following:

- Conducting initial discussions with the Owner and Design team for specific project requirements, project schedule, design requirements, and any additional information that will be beneficial to the Owner.
- Conducting a review of local geology at the project location.
- Conducting field soil exploration and testing services.
- Conducting the geotechnical laboratory testing program to meet the project requirements.
- Discussion with the Owner and Design team prior to report preparation to include updated project changes, requirements, or additional geotechnical options.
- Prepare precise, innovative, cost effective geotechnical engineering recommendations for all aspects of the project.
- Discussion after the geotechnical report submittal with the Owner and the Design team to support implementation of geotechnical recommendations that will be beneficial to the Owner.

The **construction material testing services** contract will encompass all related services to the drainage district including, but not limited to, the following:

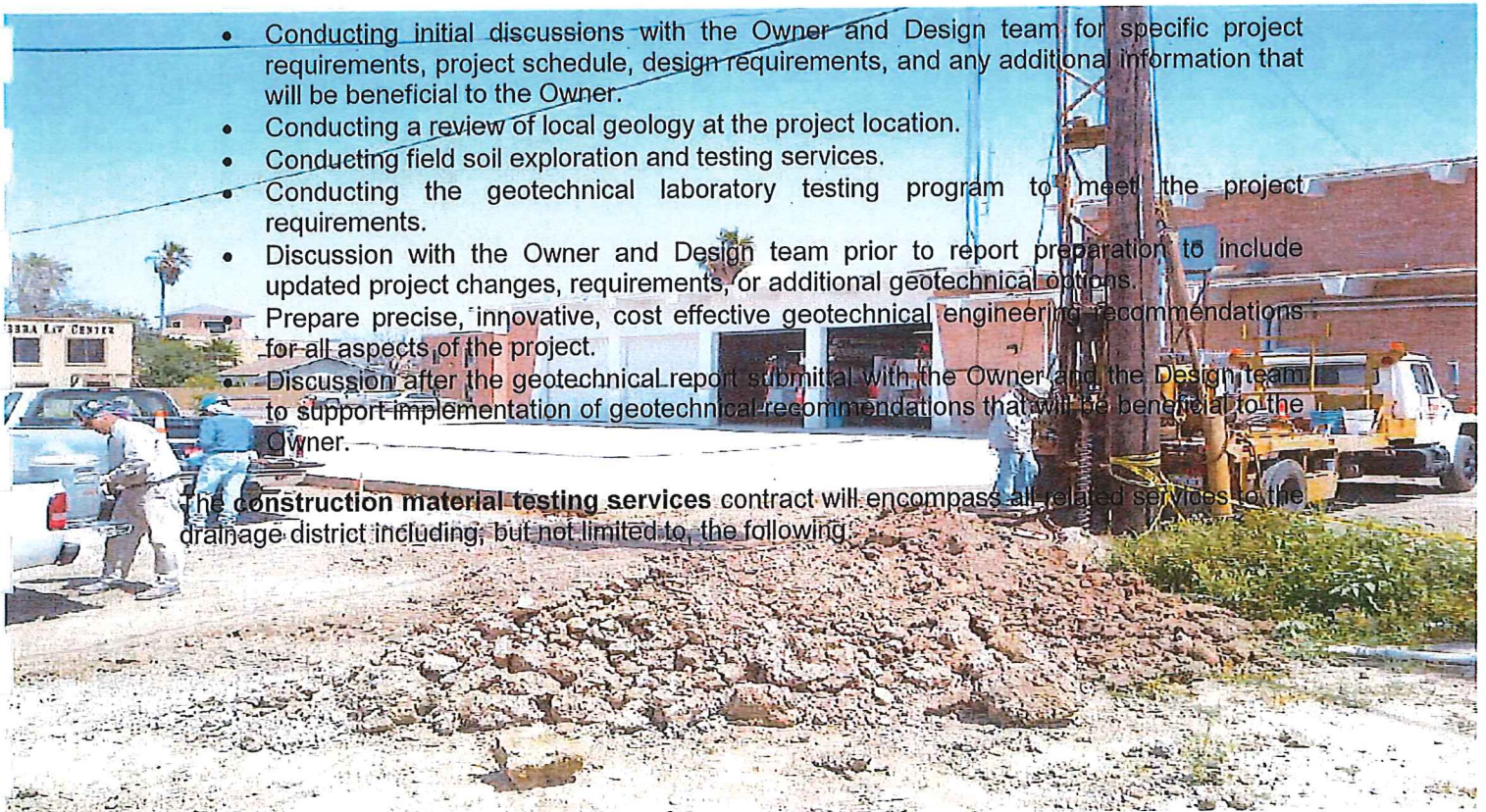



- Conducting initial discussions with the Owner and Design team for specific project requirements, project schedule, design requirements, and any additional information that will be beneficial to the district.
- Soil Sampling and Testing
- Laboratory Soil Testing
- Field Density Testing
- Field Soil Observations
- Field Soil Recommendations
- Field Reinforcing Steel Inspections
- Field Concrete Sampling and Testing
- Laboratory Concrete Compressive Strength Testing
- Field HMAC Pavement Testing
- Field and Laboratory Pavement Testing
- Field Structural Steel Inspections
- Daily reporting and communication with Owner, Design team, and Contractor

The **pavement engineering services** for this contract will encompass all related services to the drainage district including, but not limited to, the following:

- Conducting initial discussions with the Owner and Design team for specific project requirements, project schedule, design requirements, and any additional information that will be beneficial to the Owner.
- Conducting a review of local geology at the project location.
- Conducting field soil exploration and testing services.
- Conducting the geotechnical laboratory testing program to meet the project requirements.
- Review of available pavement materials
- Review of pavement design and implementation on similar type projects
- Discussion with the Owner and Design team prior to report preparation to include updated project changes, requirements, or additional pavement & geotechnical options.
- Prepare precise, innovative, cost effective geotechnical engineering recommendations for all aspects of the project.
- Preparation of Pavement Design
- Discussion after the geotechnical report submittal with the Owner and the Design team to support implementation of pavement & geotechnical recommendations that will be beneficial to the Owner.

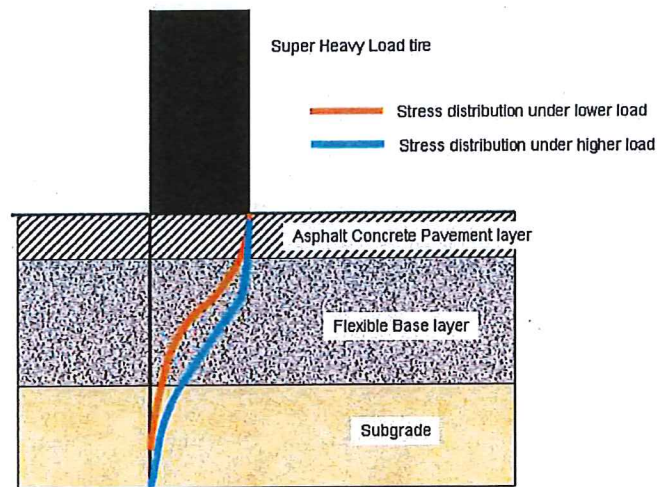



Workload Capacity

The scope of work to be performed under this contract is the scope of work that MEG performs daily for our clients in South Texas. MEG has the necessary capacity to meet drainage district's needs for both geotechnical and materials testing projects. MEG has the resources and experience to provide concurrent project construction services to an individual client for your detailed project schedule. Our resources can be shifted for operations and our staff and inspectors are cross trained for proper allocation of personnel for this specific reason.



Based on the current workload, resources, and staff of MEG it is estimated that current operations capacity is at 70%. There is currently no backlog with our Geotechnical Engineering and Material Testing Services. Our staffing plan is to never be above 85% capacity so we are able to expedite services when needed to meet critical project schedules.

Based on current and future assignments, it is estimated that during the duration of the project Millennium Engineers Group, Inc. will be operating at 80% of capacity. Engineers, Staff, and Inspectors will be able to complete the daily anticipated project tasks for this project along with current projects tasks. Geotechnical engineering projects are completed daily by our office and often the project duration is a few weeks. MEG is proficient in completing daily project tasks and expediting the testing and inspection results to the project team for the projects benefit.



The project team included in this submittal that will be allocated to this project will devote the necessary time to meet your schedule and often will be various percentages of their time based on your program needs. Inspectors that are assigned to this project will devote 100% of their time to this project when required and additional inspector resources will be available on an as needed basis for this project will be devoted 20% to 50% of their time for additional services as needed.

Engineers that are allocated to this project will devote daily time for review of project documents, necessary communication with the project team, review of field reports, and quality control measures on this project.





AASHTO Accreditation

We're Committed to Quality

MEG is an independent, licensed, engineering firm providing Geotechnical Investigations, Foundation Engineering, Consulting, and Quality Control Testing and Inspection services. Located in Pharr, Texas, our quality management system and testing facility are R18 accredited by the AASHTO Accreditation Program (AAP). From the brightest civil engineers of today to field technicians and inspectors with over 33 years of experience, our staff is qualified by rigorous internal training and independent certification programs to ensure delivery of quality professional services.

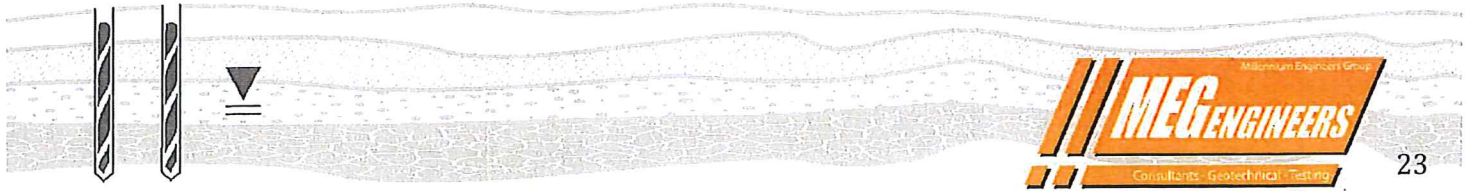



DEPARTMENT OF THE ARMY
ENGINEER RESEARCH AND DEVELOPMENT CENTER, CORPS OF ENGINEERS
GEOTECHNICAL AND STRUCTURES LABORATORY
WATERWAYS EXPERIMENT STATION, 3909 HALLS FERRY ROAD
VICKSBURG, MISSISSIPPI 39180-6199

March 18, 2015

Reply to the Attention of:
Concrete and Materials Branch

Andres Palma
Millenium Engineers Group, Inc.
5804 North Gumwood Avenue
Pharr, TX 78577

Dear Mr. Palma:

In reference to your check no. 1268, dated January 7, 2015, and audit agreement, dated January 27, 2015, an audit based on your AASHTO Accreditation was performed on documents submitted by your laboratory. We examined the AMRL On-site Assessment Report No. 1749D, dated February 27, 2015 and the AASHTO accreditation certificate effective March 6, 2015.

Your Quality System meets the requirements of the U.S. Army Corps of Engineers. The material test methods that you are validated to perform for the U.S. Army Corps of Engineers were determined from the inspection reports from AASHTO and are as follows:

Aggregate Tests: ASTM C117 and C136,

Bituminous Tests: ASTM D2726, D3666, and E329.

Concrete Tests: ASTM C1077, C1231, and E329.

Soil Tests: ASTM D698, D1140, D1557, D2216, D3740, D4318, and E329.

We will add your laboratory to the list of commercial laboratories qualified to conduct material tests for the U.S. Army Corps of Engineers; see the Materials Testing Center homepage at <http://www.erd.usace.army.mil/Media/FactSheets/FactSheetArticleView/tabid/9254/Article/476661/materials-testing-center.aspx>. All Corps offices will be notified of this decision and will have the opportunity to use your services. Millenium Engineers Group, Inc., Pharr, TX will remain on our list of laboratories qualified to conduct material tests until **March 6, 2017** two (2) years from the date of the audit. In the event your AASHTO accreditation is suspended in whole or part, Millenium Engineers Group, Inc., Pharr, TX is to notify the Materials Testing Center immediately to perform a re-evaluation of your laboratory's validation. Failure to notify the Materials Testing Center will result in immediate suspension of your U.S. Army Corps of Engineers validation.

Sincerely,

Alfred B. Crawley, PE
Director
Materials Testing Center

Copy Furnished:
Lori Thomas / Galveston District

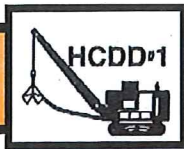

Quality Assurance / Quality Control

Internal Quality Management

Our firm follows a reporting structure that will best benefit our clients. Steps and processes are performed in every task of our services to give the client the best product possible. Our client first attitude, service approach, methodology of doing business, and internal quality control program allow us to continue providing services throughout the Rio Grande Valley and building long term business relationships.

Reporting Structure

Reporting Structure starts within our management team. **MEG** is called for the requested services and to make the necessary arrangements to initiate the project. Our dispatcher will dispatch one of our highly trained technicians to the requested project site. At this point the technician will perform the requested task(s) and then complete his/her field testing report. Field Testing reports are turned in daily and our project managers review the testing reports. The testing reports are then turned into our administrative staff and are typed for second review of the project managers. The reports are then reviewed and signed by the office engineer before they are sent to the client. The testing reports provided by **MEG** include all the necessary data that is often requested by the Owner and members of the design team.

Decision Making

Decision Making by **MEG** starts within our management team. The decisions made by our staff and key personnel come only after consulting with the principal engineer. Timing and scheduling are important factors of construction, and every decision made will take into account the best interest of our client. Engineering Recommendations are only made by a Professional Engineer that is registered in the State of Texas.

Quality Control Plans

Quality Control is monitored by **MEG** in every aspect of our work. Our office maintains a quality control program that has been approved by the American Association of State Highway and Transportation Officials (AASHTO) and the State of Texas, Department of State Health Services Radiation Control Program. Quality control is monitored and documented by our (QA/QC) Manager and Radiation Safety Officer.

Reporting and Billing Quality Assurance

Quality assurance is maintained by **MEG** in every aspect of our administrative work. Our office maintains an internal quality control program that is used by our administrative staff to audit every process of our reporting and billing procedures. This quality assurance measure allows us to maintain the quality service that is essential to our clients business.





Quality Control Application

- Our reporting structure was used in every project listed in the Representative Projects section of this submittal. In the Construction Materials testing phase of project, reports were processed daily often times same day of service to expedite the testing information for project team decision making.
- Decision making by the Principal Engineer was used in the foundation and/or drilled pier observation and testing for the building projects to determine adequate bearing depth of the drilled piers into the correct stratum of subsurface soil.



- Decision making by the Principal Engineer through our certified Welding Inspector was made same day of service for the welding inspection of structural connections and/ or columns for the building projects. That information allowed the welding crews to continue with their proposed task schedule even though items needed correction and re-inspection.



Request for Qualifications
For
HIDALGO COUNTY DRAINAGE DISTRICT NO. 1
(Including all funding sources, programs, and entities)

"Professional Engineering Services-Pool"

To: Jaime J. Salazar, Operations Manager
Hidalgo County Drainage District No. 1
902 N. Doolittle
Edinburg, Texas 78542

In accordance with the Requirements, and subject to all laws and regulations of the United States and state and local laws, the undersigned respondent proposes and commits to furnish all labor, equipment, material, software and services as set forth in the documents hereinbefore mentioned. The undersigned further agrees, upon acceptance of its qualification, to execute a contract and/or Purchase Order issued by Hidalgo County Drainage District No. 1 for performing and completing the work described in the Requirements within the time stated and for the prices proposed in the documents attached hereto and made a part hereof.

Respondent acknowledges receipt of all of the pages of the documents referenced in the Request for Qualification Checklist presented in connection with this procurement. Respondent understands that Hidalgo County Drainage District No. 1 reserves the right to reject any or all qualifications and further reserves the right to design the evaluation criteria to be used in selecting the lowest and best qualification.

Respondent agrees that this qualification shall be good and may not be withdrawn for a period of ninety (90) calendar days after the scheduled closing time for receiving qualifications, as contained in the Requirements.

Respectfully submitted,

Firm: Millennium Engineers Group, Inc.
Address: P.O. Box 4569 Edinburg, Texas 78540
By: 
Printed Name: Raul Palma, P.E.
Title: President

ATTACHMENT B
PROFESSIONAL ENGINEERING SERVICES POOL PROCUREMENT FORM
HIDALGO COUNTY DRAINAGE DISTRICT NO.1

Name and Address of Firm:	Millennium Engineers Group, Inc. P.O. Box 4569, Edinburg, Texas, 78540		
Principals of Firm and Titles:	Raul Palma, P.E. / President		
Firm's Registration No.:			
Area of Specialization:	Geotechnical Engineering / Construction Materials		
	Civil Engineering		Mechanical Engineering
	Structural Engineering		Environmental Engineering
X	Geotechnical Engineering		Electrical Engineering
X	CMT/Construction Material Testing		Highway Engineering
			MEP Engineering (Mech/Elec/Plumb)
Local References (Rio Grande Valley) List Four (4) Only:			
Reference #1: Hidalgo County Planning Dept./ Mr. Raul Sessin, P.E., C.F.M./ (956) 318-2840			
Reference #2: City of Harlingen / Mr. Javier Zamora, P.E. - City Manager / (956) 216-5304			
Reference #3: City of Edinburg / Mr. Ponciano Longoria - Public Works Director / (956) 388-8211			
Reference #4: City of Weslaco / Mr. Mardoqueo Hinojosa, P.E. / (956) 973-3146			
Recent Projects (Within Two [2] Years) List Four (4) Only:			
Project #1: Airport Drive Improvements			
Project #2: Mile 16 Road Improvements			
Project #3: Sioux Road Paving and Drainage Improvements			
Project #4: Whalen Road Improvements			
		Submitted By:	Raul Palma, P.E.
		Signature:	

Insurance Requirement Acknowledgment

I, Raul Palma, P.E., authorized representative for Millennium Engineers Group, Inc.
Company /Vendor

hereby acknowledge receipt of the Drainage District's required insurance limits. Said requirements:

- will be acquired within 10 working days after notification from Drainage District of award of project by the Hidalgo County Drainage District No.1 Board of Directors.
- will acquire additional amounts required to meet the Drainage District's requirements within 10 working days after notification from Drainage District of award of project by the Hidalgo County Drainage District No.1 Board of Directors.

Professional Liability (Errors & Omissions): \$ _____
Automobile Liability: \$ _____ General Liability: \$ _____

- have already been met; see attached copy of insurance certificate.

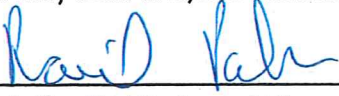

Authorized Representative

02/15/2016
Date

Notice to Proposer/Applicant:

A certificate of insurance for the required insurance limits shall be provided to the Drainage District's Contract Managers in order to qualify for award and to execute a contract between your Company and the Hidalgo County Drainage District No.1

Failure to provide Certificates of Insurance to the Drainage District's Contract Managers will cause the award to be rescinded and re-awarded to next qualified vendor. Certificates of Insurance will be monitored and verified on a quarterly basis to ensure coverage policy is in place. It is the District's obligation to maintain the appropriate insurance coverage throughout the term of the contract.

THIS FORM MUST ACCOMPANY YOUR PACKET



CERTIFICATE OF LIABILITY INSURANCE

DATE (MM/DD/YYYY)

3/1/2016

THIS CERTIFICATE IS ISSUED AS A MATTER OF INFORMATION ONLY AND CONFERS NO RIGHTS UPON THE CERTIFICATE HOLDER. THIS CERTIFICATE DOES NOT AFFIRMATIVELY OR NEGATIVELY AMEND, EXTEND OR ALTER THE COVERAGE AFFORDED BY THE POLICIES BELOW. THIS CERTIFICATE OF INSURANCE DOES NOT CONSTITUTE A CONTRACT BETWEEN THE ISSUING INSURER(S), AUTHORIZED REPRESENTATIVE OR PRODUCER, AND THE CERTIFICATE HOLDER.

IMPORTANT: If the certificate holder is an ADDITIONAL INSURED, the policy(ies) must be endorsed. If SUBROGATION IS WAIVED, subject to the terms and conditions of the policy, certain policies may require an endorsement. A statement on this certificate does not confer rights to the certificate holder in lieu of such endorsement(s).

PRODUCER Fenner & Esler 467 Kinderkamack Road P. O. Box 60 Oradell NJ 07649-0060	CONTACT NAME: certs@fenner-esler.com PHONE (A/C, No, Ext): (201) 262-1200 E-MAIL ADDRESS: jkosch@fenner-esler.com	FAX (A/C, No): (201) 262-7810
	INSURER(S) AFFORDING COVERAGE	
INSURED Millennium Engineers Group, Inc. PO Box 4569 Edinburg TX 78540	INSURER A: Amer. Casualty Co./Reading, PA	NAIC # 20427
	INSURER B: Continental Casualty Company	NAIC # 20443
	INSURER C:	
	INSURER D:	
	INSURER E:	
INSURER F:		

COVERAGES CERTIFICATE NUMBER: Master 15-16 REVISION NUMBER:

THIS IS TO CERTIFY THAT THE POLICIES OF INSURANCE LISTED BELOW HAVE BEEN ISSUED TO THE INSURED NAMED ABOVE FOR THE POLICY PERIOD INDICATED. NOTWITHSTANDING ANY REQUIREMENT, TERM OR CONDITION OF ANY CONTRACT OR OTHER DOCUMENT WITH RESPECT TO WHICH THIS CERTIFICATE MAY BE ISSUED OR MAY PERTAIN, THE INSURANCE AFFORDED BY THE POLICIES DESCRIBED HEREIN IS SUBJECT TO ALL THE TERMS, EXCLUSIONS AND CONDITIONS OF SUCH POLICIES. LIMITS SHOWN MAY HAVE BEEN REDUCED BY PAID CLAIMS.

INSR LTR	TYPE OF INSURANCE	ADDL INSD	SUBR WVP	POLICY NUMBER	POLICY EFF (MM/DD/YYYY)	POLICY EXP (MM/DD/YYYY)	LIMITS
A	<input checked="" type="checkbox"/> COMMERCIAL GENERAL LIABILITY <input type="checkbox"/> CLAIMS-MADE <input checked="" type="checkbox"/> OCCUR	X		6011181339	11/22/2015	11/22/2016	EACH OCCURRENCE \$ 1,000,000
	GEN'L AGGREGATE LIMIT APPLIES PER: <input checked="" type="checkbox"/> POLICY <input type="checkbox"/> PRO-JECT <input type="checkbox"/> LOC OTHER:						DAMAGE TO RENTED PREMISES (Ea occurrence) \$ 300,000 MED EXP (Any one person) \$ 10,000 PERSONAL & ADV INJURY \$ 1,000,000 GENERAL AGGREGATE \$ 2,000,000 PRODUCTS - COMP/OP AGG \$ 2,000,000
	AUTOMOBILE LIABILITY <input type="checkbox"/> ANY AUTO ALL OWNED AUTOS <input type="checkbox"/> HIRED AUTOS <input type="checkbox"/> SCHEDULED AUTOS NON-OWNED AUTOS						COMBINED SINGLE LIMIT (Ea accident) \$ BODILY INJURY (Per person) \$ BODILY INJURY (Per accident) \$ PROPERTY DAMAGE (Per accident) \$
B	<input checked="" type="checkbox"/> UMBRELLA LIAB <input checked="" type="checkbox"/> OCCUR <input checked="" type="checkbox"/> EXCESS LIAB <input type="checkbox"/> CLAIMS-MADE			6011181387	11/22/2015	11/22/2016	EACH OCCURRENCE \$ 1,000,000
	<input type="checkbox"/> DED <input checked="" type="checkbox"/> RETENTION \$ 10,000						AGGREGATE \$ 1,000,000
	WORKERS COMPENSATION AND EMPLOYERS' LIABILITY ANY PROPRIETOR/PARTNER/EXECUTIVE OFFICER/MEMBER EXCLUDED? (Mandatory in NH) If yes, describe under DESCRIPTION OF OPERATIONS below	Y/N	N/A				<input type="checkbox"/> PER STATUTE <input type="checkbox"/> OTH-ER E.L. EACH ACCIDENT \$ E.L. DISEASE - EA EMPLOYEE \$ E.L. DISEASE - POLICY LIMIT \$
B	Professional & Pollution Incident Liability			MCH288364872	12/12/2015	12/12/2016	Per Claim Limit \$2,000,000 Aggregate Limit \$2,000,000

DESCRIPTION OF OPERATIONS / LOCATIONS / VEHICLES (ACORD 101, Additional Remarks Schedule, may be attached if more space is required)
 Additional Insured - Certificate Holder as respects general liability where required by written contract.

CERTIFICATE HOLDER**CANCELLATION**

Hidalgo County Drainage District No. 1 9002 N. Doolittle Road Edinburg, TX 78542	SHOULD ANY OF THE ABOVE DESCRIBED POLICIES BE CANCELLED BEFORE THE EXPIRATION DATE THEREOF, NOTICE WILL BE DELIVERED IN ACCORDANCE WITH THE POLICY PROVISIONS. AUTHORIZED REPRESENTATIVE Timothy Esler/JEAN
---	---

© 1988-2014 ACORD CORPORATION. All rights reserved.



CERTIFICATE OF LIABILITY INSURANCE

DATE (MM/DD/YYYY)
02/15/2016

THIS CERTIFICATE IS ISSUED AS A MATTER OF INFORMATION ONLY AND CONFERS NO RIGHTS UPON THE CERTIFICATE HOLDER. THIS CERTIFICATE DOES NOT AFFIRMATIVELY OR NEGATIVELY AMEND, EXTEND OR ALTER THE COVERAGE AFFORDED BY THE POLICIES BELOW. THIS CERTIFICATE OF INSURANCE DOES NOT CONSTITUTE A CONTRACT BETWEEN THE ISSUING INSURER(S), AUTHORIZED REPRESENTATIVE OR PRODUCER, AND THE CERTIFICATE HOLDER.

IMPORTANT: If the certificate holder is an ADDITIONAL INSURED, the policy(ies) must be endorsed. If SUBROGATION IS WAIVED, subject to the terms and conditions of the policy, certain policies may require an endorsement. A statement on this certificate does not confer rights to the certificate holder in lieu of such endorsement(s).

PRODUCER STATE FARM INSURANCE ROBERT ELIZALDE, AGENT State Farm 5107 S MCCOLL RD EDINBURG, TX 78539	CONTACT NAME: ANDREA SALAZAR	
	PHONE (A/C, No, Ext): 956-683-9800 FAX (A/C, No): 956-683-9810 E-MAIL ADDRESS: ANDREA.SALAZAR.TGNY@STATEFARM.COM	
INSURED MILLENNIUM ENGINEERS GROUP, INC 5804 N GUMWOOD PHARR, TX 78577	INSURER(S) AFFORDING COVERAGE	NAIC #
	INSURER A: State Farm Mutual Automobile Insurance Company	25178
	INSURER B:	
	INSURER C:	
	INSURER D:	
	INSURER E:	

COVERAGES CERTIFICATE NUMBER: REVISION NUMBER:

THIS IS TO CERTIFY THAT THE POLICIES OF INSURANCE LISTED BELOW HAVE BEEN ISSUED TO THE INSURED NAMED ABOVE FOR THE POLICY PERIOD INDICATED. NOTWITHSTANDING ANY REQUIREMENT, TERM OR CONDITION OF ANY CONTRACT OR OTHER DOCUMENT WITH RESPECT TO WHICH THIS CERTIFICATE MAY BE ISSUED OR MAY PERTAIN, THE INSURANCE AFFORDED BY THE POLICIES DESCRIBED HEREIN IS SUBJECT TO ALL THE TERMS, EXCLUSIONS AND CONDITIONS OF SUCH POLICIES. LIMITS SHOWN MAY HAVE BEEN REDUCED BY PAID CLAIMS.

INSR LTR	TYPE OF INSURANCE	ADDL SUBR INSR	WVD	POLICY NUMBER	POLICY EFF (MM/DD/YYYY)	POLICY EXP (MM/DD/YYYY)	LIMITS
	GENERAL LIABILITY <input type="checkbox"/> COMMERCIAL GENERAL LIABILITY <input type="checkbox"/> CLAIMS-MADE <input type="checkbox"/> OCCUR						EACH OCCURRENCE \$ DAMAGE TO RENTED PREMISES (Ea occurrence) \$ MED EXP (Any one person) \$ PERSONAL & ADV INJURY \$ GENERAL AGGREGATE \$ PRODUCTS - COMP/OP AGG \$
A	AUTOMOBILE LIABILITY <input type="checkbox"/> ANY AUTO <input type="checkbox"/> ALL OWNED AUTOS <input checked="" type="checkbox"/> SCHEDULED AUTOS <input type="checkbox"/> HIRED AUTOS <input type="checkbox"/> NON-OWNED AUTOS			159 6511-A19-530	01/19/2016	07/19/2016	COMBINED SINGLE LIMIT (Ea accident) \$ 1,000,000 BODILY INJURY (Per person) \$ BODILY INJURY (Per accident) \$ PROPERTY DAMAGE (Per accident) \$
	UMBRELLA LIAB EXCESS LIAB DED RETENTION \$						EACH OCCURRENCE \$ AGGREGATE \$
	WORKERS COMPENSATION AND EMPLOYERS' LIABILITY ANY PROPRIETOR/PARTNER/EXECUTIVE OFFICE/MEMBER EXCLUDED? (Mandatory in NH) If yes, describe under DESCRIPTION OF OPERATIONS below						WC STATUTORY LIMITS OTHER E.L. EACH ACCIDENT \$ E.L. DISEASE - EA EMPLOYEE \$ E.L. DISEASE - POLICY LIMIT \$

DESCRIPTION OF OPERATIONS / LOCATIONS / VEHICLES (Attach ACORD 101, Additional Remarks Schedule, if more space is required)

CERTIFICATE HOLDER Hidalgo County Drainage District No. 1 9002 N. Doolittle Road Edinburg, Texas 78542	CANCELLATION SHOULD ANY OF THE ABOVE DESCRIBED POLICIES BE CANCELLED BEFORE THE EXPIRATION DATE THEREOF, NOTICE WILL BE DELIVERED IN ACCORDANCE WITH THE POLICY PROVISIONS. AUTHORIZED REPRESENTATIVE
---	---

PROJECT REQUIREMENTS ACKNOWLEDGMENT

This is to certify that I, Raul Palma, P.E., possess all of the **APPLICABLE:**

1. Licenses: Professional Engineers Licences for Mr. Raul Palma, P.E.
2. Bonds: Not Applicable
3. Certificates: Texas board of Professional Engineers, SCTRCA/SBE-MBE, HUB Certification, TxDOT Cert.
4. Permits: Not Applicable
5. Other: Certificates of Insurance- Professional, General, Workers Compensation, and Auto Liability
Necessary to carry out the required project. Furthermore, I am providing copies of the required documentation so that, if my company is awarded this project, I may be eligible to enter into a contract with Hidalgo County Drainage District No.1 and proceed to complete the project in a timely manner.

*** Any licenses, bonds, certificates, permits, etc. which are required must be presented as part of the packet in order to expedite the evaluation process. Failure to provide said documentation will result in the disqualification of your proposal/qualification.**



Authorized Signature

02/15/2016

Date

Millennium Engineers Group, Inc.

Company

P.O. Box 4569

Address

Edinburg, Texas 78540

City, State, Zip

CONFLICT OF INTEREST QUESTIONNAIRE

FORM CIQ

For vendor doing business with local governmental entity

This questionnaire reflects changes made to the law by H.B. 23, 84th Leg., Regular Session.

This questionnaire is being filed in accordance with Chapter 176, Local Government Code, by a vendor who has a business relationship as defined by Section 176.001(1-a) with a local governmental entity and the vendor meets requirements under Section 176.006(a).

By law this questionnaire must be filed with the records administrator of the local governmental entity not later than the 7th business day after the date the vendor becomes aware of facts that require the statement to be filed. See Section 176.006(a-1), Local Government Code.

A vendor commits an offense if the vendor knowingly violates Section 176.006, Local Government Code. An offense under this section is a misdemeanor.

OFFICE USE ONLY

Date Received

1 Name of vendor who has a business relationship with local governmental entity.

Millennium Engineers Group, Inc.

2 Check this box if you are filing an update to a previously filed questionnaire. (The law requires that you file an updated completed questionnaire with the appropriate filing authority not later than the 7th business day after the date on which you became aware that the originally filed questionnaire was incomplete or inaccurate.)

3 Name of local government officer about whom the information is being disclosed.

-NONE-

Name of Officer

4 Describe each employment or other business relationship with the local government officer, or a family member of the officer, as described by Section 176.003(a)(2)(A). Also describe any family relationship with the local government officer. Complete subparts A and B for each employment or business relationship described. Attach additional pages to this Form CIQ as necessary.

A. Is the local government officer or a family member of the officer receiving or likely to receive taxable income, other than investment income, from the vendor?

Yes No

B. Is the vendor receiving or likely to receive taxable income, other than investment income, from or at the direction of the local government officer or a family member of the officer AND the taxable income is not received from the local governmental entity?

Yes No

5 Describe each employment or business relationship that the vendor named in Section 1 maintains with a corporation or other business entity with respect to which the local government officer serves as an officer or director, or holds an ownership interest of one percent or more.

- NONE -

6 Check this box if the vendor has given the local government officer or a family member of the officer one or more gifts as described in Section 176.003(a)(2)(B), excluding gifts described in Section 176.003(a-1).

7 Raul Palma
Signature of vendor doing business with the governmental entity

02/15/2016
Date



Hidalgo County Clerk
Arturo Guajardo Jr.
P.O. Box 58
Edinburg, Texas 78540
Main: (956) 318-2100 Fax: (956) 318-2105

ORIGINAL COPY

Receipt No: 20160301000467
Date: 03/01/2016
Time: 09:17AM
Deputy Clerk: Elisa Castillo
Station: CH-1-CC-K15

Issued To: Millennium Engineers Group, Inc
PO Box 4569
Edinburg, TX 78540-4569

Recording Fees

Item No.	Item	Document No.	Serial No.	Amount
1	Real Property Recordings	2689961		36.00

Collected Amounts

Item No.	Payment	Amount
1	Check 2504 Millenium Eng PO Box 4569 956/702-8500	36.00

Total Received: 36.00
Order Total: 36.00
Change Due: 0.00

Thank you.

PROPOSER'S AFFIDAVIT
Exhibit "E"

PROPOSER'S AFFIDAVIT OF NON-COLLUSION
NON-CONFLICT OF INTEREST, AND ANTI-LOBBYING

STATE OF TEXAS
COUNTY OF HIDALGO

Affiant, Raul Palma, P.E., being first duly sworn, deposes that:

- (1) Affiant does hereby state neither the Proposer nor any of the Proposer's officers, partners, owners, agents, representatives, employees, or parties in interest, has in any way colluded, conspired, agreed, directly or indirectly with any person, firm, corporation, or other proposer, or potential proposer, to provide any money or other valuable consideration for assistance in procuring or attempting to procure a contract or fix the prices in the attached proposed or the proposal of any other proposer, and further states that no such money or other reward will be hereinafter paid.
- (2) Affiant further states they have neither recommended or suggested to Hidalgo County or any of its officials or employees, any of the terms or provisions set forth in their Request for Proposal and subsequent agreement, except at a meeting open to all interested proposers, of which proper notice was given.
- (3) Affiant, further states their officers, employees, or agents have not, and will not attempt to lobby, directly or indirectly, the Hidalgo County Commissioner's Court between proposal submission date and award by the Hidalgo County Commissioner's Court.
- (4) Affiant further states no officer, or stockholder of the Proposer is a member of the staff, or related to any employee of the Hidalgo County except as noted herein below:

Signature/Title: *Raul Palma* / President

Subscribed and sworn to before me this 15 day of Feb., 2015.

Martha Alicia Tapia

Notary Public

My commission expires: March 21, 2017

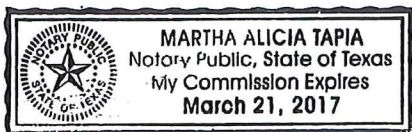

HISTORICALLY UNDERUTILIZED BUSINESS (HUB) DECLARATION

The primary objective of the Hidalgo County HUB Program is to ensure Historically Underutilized Businesses receive a fair and equal opportunity for participation in the County's procurement process. This fact holds true for Services (Professional & Non-Professional), Commodities, and Construction contracts and any subcontracts thereto. The program strongly encourages Prime Contractors to provide subcontracting opportunities to Certified Hub Contractors/Vendors. Our goal for HUB contractor/vendor participation, as well as HUB subcontractor participation is 30%. To be considered as a "Certified HUB Contractor/Vendor" the contractor/vendor must have been certified by, and hold a current and valid certification with any of the three agencies listed below.

Have you been Certified as a HUB or an MBE/WBE source?: Yes No

If yes, by whom?: State General Services Commission Other

Indicate Certification No(s) 1742996684300 or Are Certificate(s) Attached?: Yes No

LIST OF CERTIFIED HUB SUBCONTRACTORS

(Attach additional pages if necessary)

What percentage of the Bid or RFQ is to be subcontracted with Certified HUB sources? 0 % (List HUB Subcontractor information below).

HUB Subcontractor Name: N/A HUB Status:
Certifying Agency (Check all applicable): State General Services Commission Other

Address: N/A City: N/A State: N/A Zip:
Contact Person: N/A Title: N/A Phone No.: ()
Subcontract Amount: \$ N/A Description of Work to be Performed:

HUB Subcontractor Name: N/A HUB Status:
Certifying Agency (Check all applicable): State General Services Commission Other

Address: N/A City: N/A State: N/A Zip:
Contact Person: N/A Title: N/A Phone No.: ()
Subcontract Amount: \$ N/A Description of Work to be Performed :

HUB Subcontractor Name: N/A HUB Status:
Certifying Agency (Check all applicable): State General Services Commission Other

Address: N/A City: N/A State: N/A Zip:
Contact Person: N/A Title: N/A Phone No.: ()
Subcontract Amount: \$ N/A Description of Work to be Performed:

Request for Taxpayer Identification Number and Certification

Give Form to the
requester. Do not
send to the IRS.

Print or type See Specific Instructions on page 2.	Name (as shown on your income tax return) Millennium Engineers Group, Inc.		
	Business name/disregarded entity name, if different from above Same As Above		
	Check appropriate box for federal tax classification: <input type="checkbox"/> Individual/sole proprietor <input checked="" type="checkbox"/> C Corporation <input type="checkbox"/> S Corporation <input type="checkbox"/> Partnership <input type="checkbox"/> Trust/estate <input type="checkbox"/> Limited liability company. Enter the tax classification (C=C corporation, S=S corporation, P=partnership) ▶ _____ <input type="checkbox"/> Other (see Instructions) ▶ _____	Exemptions (see Instructions): Exempt payee code (if any) _____ Exemption from FATCA reporting code (if any) _____	
	Address (number, street, and apt. or suite no.) P.O. Box 4569 City, state, and ZIP code Edinburg, Texas, 78540	Requester's name and address (optional) Hidalgo County Drainage District No. 1 902 N. Doolittle Rd., Edinburg, Tx, 78542	
	List account number(s) here (optional) Not applicable		

Part I Taxpayer Identification Number (TIN)																																						
<p>Enter your TIN in the appropriate box. The TIN provided must match the name given on the "Name" line to avoid backup withholding. For individuals, this is your social security number (SSN). However, for a resident alien, sole proprietor, or disregarded entity, see the Part I instructions on page 3. For other entities, it is your employer identification number (EIN). If you do not have a number, see <i>How to get a TIN</i> on page 3.</p> <p>Note. If the account is in more than one name, see the chart on page 4 for guidelines on whose number to enter.</p>	<table border="1" style="width: 100%; border-collapse: collapse;"> <tr> <th colspan="9" style="text-align: center;">Social security number</th> </tr> <tr> <td style="width: 20px; height: 20px;"> </td> <td style="width: 20px; height: 20px;"> </td> <td style="width: 20px; height: 20px;"> </td> <td style="width: 20px; height: 20px;"> </td> <td style="width: 20px; height: 20px;"> </td> <td style="width: 20px; height: 20px;"> </td> <td style="width: 20px; height: 20px;"> </td> <td style="width: 20px; height: 20px;"> </td> <td style="width: 20px; height: 20px;"> </td> </tr> </table> <table border="1" style="width: 100%; border-collapse: collapse;"> <tr> <th colspan="9" style="text-align: center;">Employer identification number</th> </tr> <tr> <td style="width: 20px; height: 20px;">7</td> <td style="width: 20px; height: 20px;">4</td> <td style="width: 20px; height: 20px;">-</td> <td style="width: 20px; height: 20px;">2</td> <td style="width: 20px; height: 20px;">9</td> <td style="width: 20px; height: 20px;">9</td> <td style="width: 20px; height: 20px;">6</td> <td style="width: 20px; height: 20px;">6</td> <td style="width: 20px; height: 20px;">8</td> <td style="width: 20px; height: 20px;">4</td> </tr> </table>	Social security number																		Employer identification number									7	4	-	2	9	9	6	6	8	4
Social security number																																						
Employer identification number																																						
7	4	-	2	9	9	6	6	8	4																													

Part II Certification	
Under penalties of perjury, I certify that:	
<ol style="list-style-type: none"> 1. The number shown on this form is my correct taxpayer identification number (or I am waiting for a number to be issued to me), and 2. I am not subject to backup withholding because: (a) I am exempt from backup withholding, or (b) I have not been notified by the Internal Revenue Service (IRS) that I am subject to backup withholding as a result of a failure to report all interest or dividends, or (c) the IRS has notified me that I am no longer subject to backup withholding, and 3. I am a U.S. citizen or other U.S. person (defined below), and 4. The FATCA code(s) entered on this form (if any) indicating that I am exempt from FATCA reporting is correct. 	
<p>Certification Instructions. You must cross out item 2 above if you have been notified by the IRS that you are currently subject to backup withholding because you have failed to report all interest and dividends on your tax return. For real estate transactions, item 2 does not apply. For mortgage interest paid, acquisition or abandonment of secured property, cancellation of debt, contributions to an individual retirement arrangement (IRA), and generally, payments other than interest and dividends, you are not required to sign the certification, but you must provide your correct TIN. See the instructions on page 3.</p>	
<p>Sign Here</p>	<p>Signature of U.S. person ▶ </p> <p style="text-align: right;">Date ▶ 02/16/2015</p>

General Instructions

Section references are to the Internal Revenue Code unless otherwise noted.

Future developments. The IRS has created a page on IRS.gov for information about Form W-9, at www.irs.gov/w9. Information about any future developments affecting Form W-9 (such as legislation enacted after we release it) will be posted on that page.

Purpose of Form

A person who is required to file an information return with the IRS must obtain your correct taxpayer identification number (TIN) to report, for example, income paid to you, payments made to you in settlement of payment card and third party network transactions, real estate transactions, mortgage interest you paid, acquisition or abandonment of secured property, cancellation of debt, or contributions you made to an IRA.

Use Form W-9 only if you are a U.S. person (including a resident alien), to provide your correct TIN to the person requesting it (the requester) and, when applicable, to:

1. Certify that the TIN you are giving is correct (or you are waiting for a number to be issued),
2. Certify that you are not subject to backup withholding, or
3. Claim exemption from backup withholding if you are a U.S. exempt payee. If applicable, you are also certifying that as a U.S. person, your allocable share of any partnership income from a U.S. trade or business is not subject to the withholding tax on foreign partners' share of effectively connected income, and

4. Certify that FATCA code(s) entered on this form (if any) indicating that you are exempt from the FATCA reporting, is correct.

Note. If you are a U.S. person and a requester gives you a form other than Form W-9 to request your TIN, you must use the requester's form if it is substantially similar to this Form W-9.

Definition of a U.S. person. For federal tax purposes, you are considered a U.S. person if you are:

- An individual who is a U.S. citizen or U.S. resident alien,
- A partnership, corporation, company, or association created or organized in the United States or under the laws of the United States,
- An estate (other than a foreign estate), or
- A domestic trust (as defined in Regulations section 301.7701-7).

Special rules for partnerships. Partnerships that conduct a trade or business in the United States are generally required to pay a withholding tax under section 1446 on any foreign partners' share of effectively connected taxable income from such business. Further, in certain cases where a Form W-9 has not been received, the rules under section 1446 require a partnership to presume that a partner is a foreign person, and pay the section 1446 withholding tax. Therefore, if you are a U.S. person that is a partner in a partnership conducting a trade or business in the United States, provide Form W-9 to the partnership to establish your U.S. status and avoid section 1446 withholding on your share of partnership income.

Certification
Regarding Debarment, Suspension and Ineligibility

As is required by the Federal Regulations Implementing Executive Order 12549, Debarment and Suspension, 45 CFR Part 76, Government-wide Debarment and Suspension, the applicant certifies, to the best of his or her knowledge and belief, that both it and its principals:

- a. Are not presently debarred, suspended, proposed for debarment, declared ineligible, or voluntarily excluded from participation in this transaction by any federal department or agency;
- b. Have not within a three-year period preceding this bid proposal and/or application been convicted of or had a civil judgment rendered against them for commission of fraud or a criminal offense in connection with obtaining, attempting to obtain, or performing a public (federal, state, or local) transaction or contract under a public transaction, violation of federal or state antitrust statutes or commission of embezzlement, theft, forgery, bribery, falsification or destruction of records, making false statements, or receiving stolen property;
- c. Are not presently indicted for or otherwise criminally or civilly charged by a government entity with commission of any of the offenses enumerated herein; and
- d. Have not within a three-year period preceding this bid proposal and/or application had one or more public transactions terminated for cause or default.

Signature: 
Print Name: Raul Palma, P.E.
Title: President
Telephone Number: 956-702-8500
Date: 02/15/2016

If the bidder is unable to certify to all of the statements in this Certification, such bidder should attach an explanation to this proposal.



HIDALGO COUNTY
(Including all funding sources, programs, and entities)
REQUEST FOR QUALIFICATIONS
PROFESSIONAL ENGINEERING SERVICES-POOL

RFQ No.: HCDD1-16-001-02-17

RFQ SUBMITTAL CHECK LIST

All forms listed below must be included in the RFQ response.

Indicate with a check mark (v) the Forms completed and included in this response:

- Page 9 of Legal Notice
- Attachment "B" -Procurement Form -Areas of Specialization
- Exhibit "C" -Acknowledgement forms (page 3 and 4)
- Exhibit "D-1" -CIQ Form -Copy of County Clerk File Recording fee receipt.
- Exhibit "E" -Proposers Affidavit
- Vendor Bidder Application and IRS form W-9
- Certification Regarding Debarment
- One Original, 3 Copies, and 1 CD containing a complete copy of Response.



Innovative. Experienced. Professional.

GEOTECHNICAL ENGINEERING ■ CONSTRUCTION MATERIALS TESTING ■ CONSULTING ■ FORENSICS

Millennium Engineers Group, Inc.
TBPE Firm No. F-3913
Valleywide Engineering Services
www.megengineers.com



PHARR OFFICE
5804 N. Gumwood Ave. Pharr, Texas 78577
O 956.702.8500 F 956.702.4180

HARLINGEN OFFICE
1221 E. Tyler Ave. Harlingen, Texas 78550
O 956.622.7077 F 956.702.4180

■ PHARR ■ HARLINGEN ■ SOUTH TEXAS ■

EXHIBIT A

-Scope of Services to be provided by the County

The following provides an outline of the services to be provided by the Owner in the development of Projects (as defined and more particularly identified in Exhibit "A" attached to this Agreement).

General:

The Owner will provide to the Laboratory the following:

- 1) Provide the authorization to proceed with services through coordination with the project consulting and design Laboratory.
- 2) Payment for work performed by the Laboratory and accepted by the Owner in accordance with Article 3 of this Agreement.
- 3) Assistance to the Laboratory, as necessary, to obtain the required data and information from other local, regional, State and Federal agencies the Laboratory cannot easily obtain.
- 4) Provide any available relevant data the Owner may have on file concerning the projects.
- 5) Provide timely review and decisions in response to the Laboratory's request for information and/or required submittals and deliverables, in order for the Laboratory to maintain the agreed upon work schedule prepared in accordance with Exhibit "A" attached to this Agreement.
- 6) Attend and participate in progress meetings as required and as coordinated and conducted by Laboratory.
- 7) Provide the authorization to proceed with services on project by project basis through consulting design and construction Laboratory.

EXHIBIT B

-Scope of Services to be provided by the Laboratory

Exhibit "B"

Services to be Provided by Laboratory

The services to be provided by the LABORATORY in providing Geotechnical Laboratory Services, Construction Materials Testing and Geo Technical Services for Hidalgo County Drainage District No.1 - **Kenyon Road & Mile 17 Area Drainage Improvements** Project, "ON A AS NEEDED BASIS" and projects is as follows:

A. Preliminary Phase:

- (1) Attend preliminary conferences with the OWNER and, if requested, with the funding agency and other government agencies or interested parties regarding the Project.
- (2) Provide for the necessary geotechnical investigation and testing necessary to develop the design.
- (3) Provide environmental studies as may be necessary to complete a project.
- (4) Provide assistance to the OWNER in providing material requirements and specifications for design, construction and maintenance projects.
- (5) Provide assistance to the OWNER in providing pavement design recommendations for the design, construction and maintenance projects.
- (6) Provide assistance to the OWNER in providing pavement rehabilitation recommendations for the design, and maintenance projects.
- (7) Provide assistance to the OWNER in providing pavement condition studies.

B. Design Phase:

- (1) Attend the OWNER'S and respective Party's meeting as requested for the purpose of explaining geotechnical investigation report recommendations and preliminary testing results and their impact to proposed design activities.
- (2) Perform any additional geotechnical investigations, testing and environmental studies necessary to collect information required in the design of the Project.
- (3) Provide assistance to the OWNER in providing material requirements and specification for design, construction and maintenance projects.
- (4) Provide assistance to the OWNER in providing pavement design recommendations for the design, construction and maintenance projects.
- (5) Provide assistance to the OWNER in providing pavement rehabilitation recommendations for the design, construction and maintenance projects.
- (6) Provide assistance to the OWNER in providing pavement condition studies.
- (7) Furnish the OWNER all necessary reports for preliminary design, design, construction and maintenance projects.

C. Construction/Maintenance Phase:

- (1) Attend the OWNER'S and respective Party's pre-construction and construction meetings as requested for the purpose of explaining geotechnical investigation report recommendation and preliminary testing results and their impact to proposed construction activities and establish coordination and lines of communication for proposed construction materials testing during construction activities.
- (2) Consult and advise with the OWNER during construction.

- (3) Provide construction materials testing for construction and maintenance projects as required by the project plans and specifications and/or specified by the project design engineer.
- (4) Review all material designs as requested by the OWNER and/or project design engineer.
- (5) Furnish the OWNER all necessary reports for construction and maintenance projects.
- (6) Provide construction inspection services as requested by the OWNER on construction and maintenance projects.

D. Miscellaneous/Other:

- (1) Act for OWNER in professional manner, using that degree of care and skill ordinarily exercised by and consistent with the standards of the profession.
- (2) Perform all technical services under the general direction of a Licensed Professional Laboratory in the State of Texas and in substantial accordance with the basic requirements of the appropriate Standards of the American Society of Testing and Materials, where applicable, or other standards designated by County.
- (3) Employ testing machines which have been calibrated within a period not exceeding twelve (12) months from the time of use by devised of accuracy traceable to the National Institute of Standards and Technology (NIST) of the United States Department of Commerce, and, upon request, submit to the OWNER or its authorized representative documentation of such calibration.
- (4) Promptly submit formal construction materials testing reports for all tests, observations, and services performed indicating where applicable, compliance with OWNER specifications or other documents. Such reports shall be completed and factual, citing the tests performed, methods employed, values obtained, parts of the structure and location at which the tests were made.
- (5) The plans and specifications prepared under this Agreement shall become the property of the OWNER upon completion of the work and payment in full of all monies due to the Laboratory.
- (6) Retain all pertinent records relating to the services performed for a period of five (5) years following submission of all reports, during which period the records will be made available to the Owner within a reasonable time.

NOTE: Change in and/or additional services to Scope will require prior approval from OWNER prior to undertaking.

EXHIBIT C
-Laboratory's Contract Rates



EXHIBIT "C"
ENGINEER'S CONTRACT FEE SCHEDULE

For the services to be provided by the ENGINEER the charge will be on the basis of the units and unit fee rates established in this schedule of tests, staff personnel services and additional services. The overtime premium, required by the Fair Labor Standards Act for nonexempt classifications, will be charged for overtime hours worked because of the County's requirements and its authorization. However, except for the overtime premium, the maximum charges shall not exceed the rates shown in this schedule.

SOILS AND AGGREGATE SECTION

Material Preparation Time (per hour).....	\$50.00
Atterberg Limits (each test).....	70.00
Sieve Analysis	
Dry through No. 40 (each test).....	55.00
Additional Sieves (each sieve).....	12.00
Percent Passing No. 200 Sieve (each test).....	45.00
Moisture Density Relationship	
Standard Proctor (each test).....	200.00
Modified Proctor (each test).....	215.00
TxDOT Proctor (each test).....	215.00
Nuclear Density Test (In conjunction with Inspection)	
Nuclear Density Test (min. 3, each test).....	28.00
Depth Test (each test).....	6.00
Wet Ball Mill (each test)	210.00
Determination of Optimum Lime Content	
PI Method - (each test)	275.00
Tex 121-E - (each test)	275.00
PH Method - (each test)	275.00
Additional Points (each point).....	75.00
California Bearing Ratio (each test).....	750.00
Additional Specimens (each specimen).....	175.00
Small Moisture Content of Aggregates and Base (each test).....	13.00
Large Moisture Content of Aggregates and Base (each test).....	35.00
Linear Shrinkage (each test)	85.00
pH (each test).....	80.00
Resistivity of Soils (each test)	90.00
Specific Gravity (each test).....	75.00
Unit Weight (each test).....	45.00
Soundness (each test)	500.00
Sulfate Content (each test).....	80.00
Hydrometer (each test).....	275.00

BITUMINOUS SECTION

Material Preparation Time (per hour).....	\$55.00
Sieve Analysis for Fine and Coarse Aggregate (Tex 200-F or ASTM)	
Dry (each test).....	55.00
Additional Sieves (each sieve).....	12.00

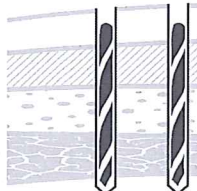



Sand Equivalent (each test)	75.00
Extraction & Gradation, Percent Asphalt (each test).....	250.00
Asphalt Cores (each core).....	60.00
Asphalt Core Density (each core).....	40.00
Thickness of Cores (each core).....	15.00
Theoretical Maximum Specific Gravity (each test)	60.00
Lab Density (each test).....	65.00
Effect of Water on Bituminous Paving Mixtures (each test)	75.00
Hveem Stability (each test).....	105.00
Coring Rig (per day).....	95.00
Asphaltic Concrete Design and Other Services	By Quote
Percent Passing No. 200 Sieve (per test).....	45.00
Molding Specimens (per set).....	60.00

CONCRETE SECTION

Material Preparation Time (per hour).....	\$55.00
Slump Test (In conjunction with Inspection)	
Slump Test (each test).....	20.00
Air Content of Fresh Concrete (In conjunction with Inspection)	
Pressure (each test).....	25.00
Volumetric (each test)	35.00
Concrete Cylinder Compressive Strength Test (each cylinder).....	16.00
Strip & Hold Cylinder (each cylinder).....	15.00
Concrete Beam Flexure Strength Test	
6x6x22 (each beam).....	40.00
Strip & Hold Beam (each beam).....	15.00
Concrete Cores By Circumference Area (Min. 100 sq. in.).....	2.00/sq. in.
Sawing of Concrete Cylinders or Cores (per end, per core).....	25.00
Thickness of Cores (each core).....	15.00
Coring Rig (per day).....	95.00
Portland Cement Concrete Design or other services	By Quote

MASONRY SECTION

Material Preparation Time (per hour).....	\$59.00
Grout Prism (each prism).....	24.00
Mortar Prism (each prism).....	24.00

SOIL EXPLORATION AND GEOTECHNICAL SERVICES

Drilled Borings	
In Soil, 0 – 50 feet (per foot).....	\$19.00
In Soil, 50 – 100 feet (per foot).....	22.50
In Rock	By Quote
Non-Conventional Drilling.....	By Quote
Standard Penetration Test (each test).....	12.00

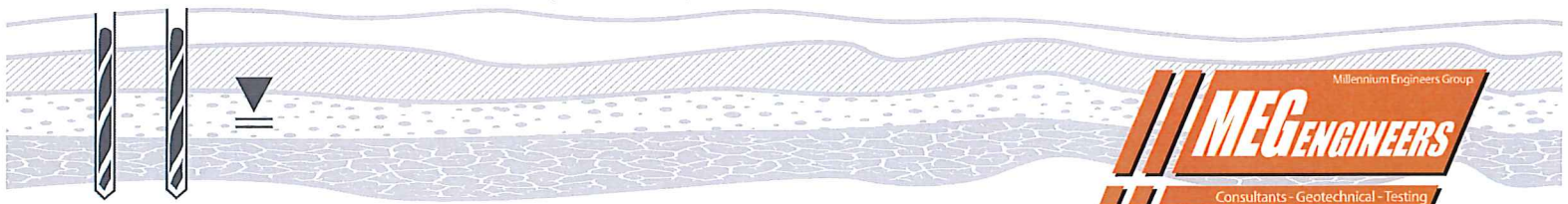



Texas Cone Penetration Test (each test).....	20.00
Shelby Tube Sampling (each test).....	20.00
Mobilization and Demobilization - In Rio Grande Valley (each trip)...	350.00
Mobilization and Demobilization - Outside Rio Grande Valley (each mile)	3.50/mile
Mobilization of Non-Conventional Drilling Equipment	By Quote
Trip Charge For Logger (each mile).....	0.80
Standby Time, Rig plus 2 man crew (per hour).....	200.00
Well Installation.....	By Quote
Technician To Log Soil Test Boring (per hour).....	59.00
Field Coordination	
Field Engineer (per hour).....	115.00
Utility Clearance (per hour).....	70.00
Flagman (per hour).....	59.00
Per Diem (If required)	Cost + 15%
Unconfined Compression (each test).....	45.00
Moisture Content (each test).....	13.00
Grout Backfill (per foot).....	5.00
Dozer/Clearing	Cost + 15%
Asphalt Pavement Coring (each core).....	100.00
Concrete/Asphalt Patch (per location).....	75.00

TECHNICIAN SERVICES

Soil Engineering Technician (per hour) (Min. 2 Hrs).....	\$50.00
Concrete Engineering Technician (per hour) (Min. 2 Hrs).....	55.00
Asphalt Engineering Technician (per hour) (Min. 2 Hrs).....	55.00
Masonry Engineering Technician (per hour) (Min. 2 Hrs).....	59.00
Senior Engineering Technician (per hour).....	59.00
Plant Inspection, Reinforcing Steel Inspection, Etc. (Min. 2 Hrs)	
Construction Inspection Engineering Technician Time (per hour).....	59.00
Plant Inspection, Reinforcing Steel Inspection, Etc. (Min. 2 Hrs)	
Engineering Specialist (per hour).....	70.00
Pier Inspection, Pile Load Inspections, Etc. (Min. 2 Hrs)	
Certified Welding Inspector (per hour) (Min. 4 Hrs).....	90.00

OTHER SERVICES

Vehicle Trip Charge (per trip) (within 25 miles of office).....	\$40.00
Vehicle Trip Charge (per mile) (beyond 25 miles of office).....	0.80
Other Testing Not Specified (Option 1)	Cost + 15%
Other Testing Not Specified (Option 2) (per hour).....	56.00
Other Services, Outside Services or Supplies.....	Cost + 15%
Test Reports (each report).....	30.00
Clerical/Administrative (per hour).....	50.00
Fax (per page).....	1.00
Photocopies	
8 1/2" x 11" (per page).....	0.12

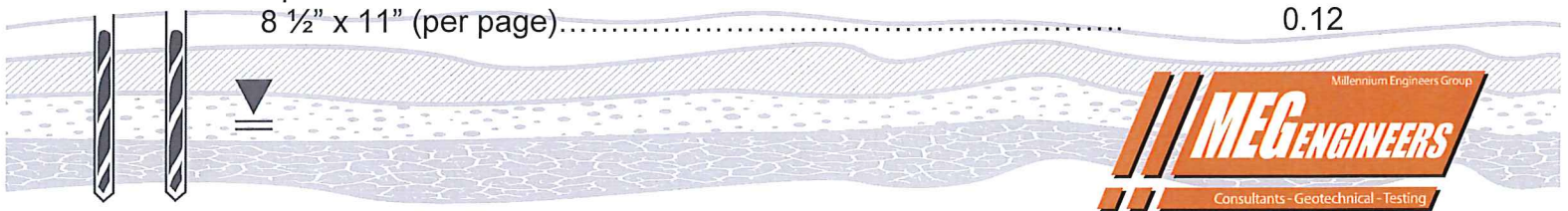



8 1/2" x 14" (per page).....	0.15
11" x 17" (per page).....	0.20
Additional Insured (per request).....	200.00

PROFESSIONAL SERVICES

Principal Engineer (per hour).....	\$165.00
Project Engineer (per hour).....	125.00
Staff Engineer (per hour).....	110.00

PROJECT MANAGEMENT AND COORDINATION OF SERVICES PROVIDED

Applied to each invoice of net services provided	
Project Management (per hour).....	\$75.00

BASIC SERVICES AGREEMENT

MEG will charge overtime at the rate of 1.5 applicable for technicians for services performed before 7 AM and after 6 PM on Monday through Friday, after 8 continuous hours on the Client's project and on Saturday, Sunday and holidays.

Hours billed will be from our office at 5804 N. Gumwood, Pharr, Texas, port to port. Fractions of hours will be billed as whole hours. Technician hours will be billed a minimum of 2 hours.

Laboratory testing performed after normal work hours of 7 AM to 6 PM on Monday through Friday will be billed the test rate plus applicable overtime hourly charges.

Project management will be billed for report review, coordination and management of project personnel at a rate of one hour for every two reports.

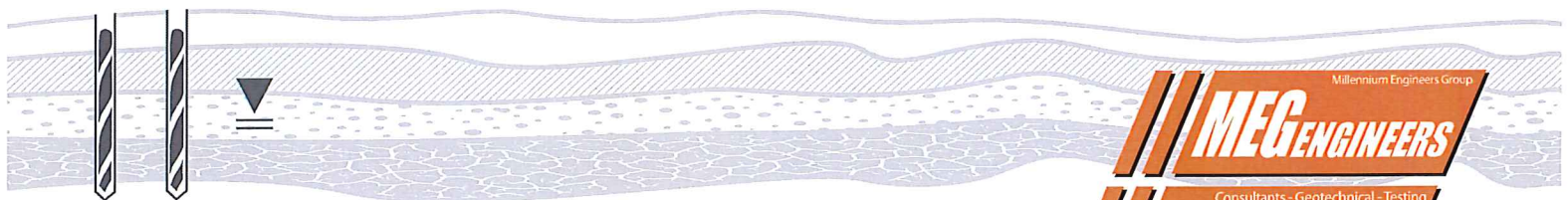

PART 6. RESPONSIBILITIES AND OBLIGATIONS

This Authorization does not waive the parties' responsibilities and obligations provided under the **Agreement**.

PART 7. ACKNOWLEDGEMENT AND CONFIRMATION

Acknowledgement and confirmation by Hidalgo County Drainage District No.1, General Manager, Raul E. Segin, PE, CFM, as to content and detail of this Work Authorization No. ____.

**HIDALGO COUNTY DRAINAGE DISTRICT NO. 1
General Manager**

BY: _____
Raul E. Segin, PE, CFM

PART 8. ACCEPTANCE AND APPROVAL

This Work Authorization is hereby accepted, approved by Hidalgo County Drainage District No. 1 Board of Directors on _____ (approval date) as indicated below and effective as of _____ day of _____, 2016.

THE LABORATORY:

By:

THE OWNER:

**HIDALGO COUNTY DRAINAGE
DISTRICT NO. 1**

By: Ramon Garcia,
Chairman of the Board

EXHIBIT E
-Supplemental Agreement Form

THE STATE OF TEXAS §
 §
COUNTY OF HIDALGO §

SUPPLEMENTAL AGREEMENT NO. _____
TO AGREEMENT FOR PROFESSIONAL CONSTRUCTION MATERIAL TESTING
SERVICES

THIS SUPPLEMENTAL AGREEMENT is made pursuant to the terms and conditions of paragraph 5 of the Agreement made by and between **HIDALGO COUNTY DRAINAGE DISTRICT NO. 1**, acting herein by and through the **Board of Directors**, hereinafter called the "**Owner**", and _____, Professional Laboratory of, _____, Texas, hereinafter called the "**Laboratory**".

WITNESSETH

WHEREAS, the **Owner** and the **Laboratory** executed the **Agreement** on the ____ day of _____ **20**____ concerning Laboratoring for _____ (hereinafter referred to as the "**Project**") ; and,

WHEREAS, Paragraph ____ of the **Agreement**, (paragraph title), establishes _____ ; and,

WHEREAS, it has become necessary to amend the Agreement to _____

A. AGREEMENT

NOW THEREFORE, premises considered, the **Owner** and the **Laboratory** agree that said **Agreement** is amended as follows:

I. Paragraph ____ of the **Agreement**, (paragraph title), is revised to

All other provisions are unchanged and remain in full force and effect.

IN WITNESS WHEREOF, the Laboratory and the Owner have caused this Supplemental Agreement to the Agreement for Professional Services to be executed as of the _____ day of _____, 20__.

THE LABORATORY:

BY: _____

Address for Giving Notices:

**THE OWNER:
HIDALGO COUNTY DRAINAGE DISTRICT NO. 1**

BY: _____
Ramon Garcia, Chairman of the Board

LIST OF ATTACHMENTS

(as required)

APPROVED AS TO FORM:
Atlas, Hall & Rodriguez, L.L.P.

By: _____

EXHIBIT F
-Certificates of Insurance



CERTIFICATE OF LIABILITY INSURANCE

DATE (MM/DD/YYYY)

11/17/2016

THIS CERTIFICATE IS ISSUED AS A MATTER OF INFORMATION ONLY AND CONFERS NO RIGHTS UPON THE CERTIFICATE HOLDER. THIS CERTIFICATE DOES NOT AFFIRMATIVELY OR NEGATIVELY AMEND, EXTEND OR ALTER THE COVERAGE AFFORDED BY THE POLICIES BELOW. THIS CERTIFICATE OF INSURANCE DOES NOT CONSTITUTE A CONTRACT BETWEEN THE ISSUING INSURER(S), AUTHORIZED REPRESENTATIVE OR PRODUCER, AND THE CERTIFICATE HOLDER.

IMPORTANT: If the certificate holder is an ADDITIONAL INSURED, the policy(ies) must be endorsed. If SUBROGATION IS WAIVED, subject to the terms and conditions of the policy, certain policies may require an endorsement. A statement on this certificate does not confer rights to the certificate holder in lieu of such endorsement(s).

PRODUCER Fenner & Esler 467 Kinderkamack Road P. O. Box 60 Oradell NJ 07649-0060	CONTACT NAME: certs@fenner-esler.com PHONE (A/C, No, Ext): (201)262-1200 E-MAIL ADDRESS: jkosch@fenner-esler.com	FAX (A/C, No): (201)262-7810
	INSURER(S) AFFORDING COVERAGE	
INSURED Millennium Engineers Group, Inc. PO Box 4569 Edinburg TX 78540	INSURER A: Amer. Casualty Co./Reading, PA INSURER B: Continental Casualty Company INSURER C: INSURER D: INSURER E: INSURER F:	NAIC # 20427 20443

COVERAGES **CERTIFICATE NUMBER:** Master 16-17 **REVISION NUMBER:**

THIS IS TO CERTIFY THAT THE POLICIES OF INSURANCE LISTED BELOW HAVE BEEN ISSUED TO THE INSURED NAMED ABOVE FOR THE POLICY PERIOD INDICATED. NOTWITHSTANDING ANY REQUIREMENT, TERM OR CONDITION OF ANY CONTRACT OR OTHER DOCUMENT WITH RESPECT TO WHICH THIS CERTIFICATE MAY BE ISSUED OR MAY PERTAIN, THE INSURANCE AFFORDED BY THE POLICIES DESCRIBED HEREIN IS SUBJECT TO ALL THE TERMS, EXCLUSIONS AND CONDITIONS OF SUCH POLICIES. LIMITS SHOWN MAY HAVE BEEN REDUCED BY PAID CLAIMS.

INSR LTR	TYPE OF INSURANCE	ADDL INSD	SUBR WVD	POLICY NUMBER	POLICY EFF (MM/DD/YYYY)	POLICY EXP (MM/DD/YYYY)	LIMITS		
A	<input checked="" type="checkbox"/> COMMERCIAL GENERAL LIABILITY			6011181339	11/22/2016	11/22/2017	EACH OCCURRENCE	\$ 1,000,000	
	<input type="checkbox"/> CLAIMS-MADE <input checked="" type="checkbox"/> OCCUR	X					DAMAGE TO RENTED PREMISES (Ea occurrence)	\$ 300,000	
	GEN'L AGGREGATE LIMIT APPLIES PER:							MED EXP (Any one person)	\$ 10,000
	<input checked="" type="checkbox"/> POLICY <input type="checkbox"/> PRO-JECT <input type="checkbox"/> LOC						PERSONAL & ADV INJURY	\$ 1,000,000	
	OTHER:						GENERAL AGGREGATE	\$ 2,000,000	
							PRODUCTS - COMP/OP AGG	\$ 2,000,000	
								\$	
	AUTOMOBILE LIABILITY						COMBINED SINGLE LIMIT (Ea accident)	\$	
	<input type="checkbox"/> ANY AUTO						BODILY INJURY (Per person)	\$	
	<input type="checkbox"/> ALL OWNED AUTOS						BODILY INJURY (Per accident)	\$	
	<input type="checkbox"/> HIRED AUTOS						PROPERTY DAMAGE (Per accident)	\$	
								\$	
B	<input type="checkbox"/> UMBRELLA LIAB <input checked="" type="checkbox"/> OCCUR			6011181387	11/22/2016	11/22/2017	EACH OCCURRENCE	\$ 1,000,000	
	<input checked="" type="checkbox"/> EXCESS LIAB <input type="checkbox"/> CLAIMS-MADE						AGGREGATE	\$ 1,000,000	
	<input type="checkbox"/> DED <input checked="" type="checkbox"/> RETENTIONS \$ 10,000							\$	
	WORKERS COMPENSATION AND EMPLOYERS' LIABILITY						PER STATUTE	OTH-ER	
	ANY PROPRIETOR/PARTNER/EXECUTIVE OFFICER/MEMBER EXCLUDED? (Mandatory in NH)		N/A				E.L. EACH ACCIDENT	\$	
	If yes, describe under DESCRIPTION OF OPERATIONS below						E.L. DISEASE - EA EMPLOYEE	\$	
							E.L. DISEASE - POLICY LIMIT	\$	
B	Professional & Pollution Incident Liability			MCH288364872	12/12/2015	12/12/2016	Per Claim Limit	\$2,000,000	
							Aggregate Limit	\$2,000,000	

DESCRIPTION OF OPERATIONS / LOCATIONS / VEHICLES (ACORD 101, Additional Remarks Schedule, may be attached if more space is required)
 Additional Insured - Certificate Holder as respects general liability where required by written contract.

CERTIFICATE HOLDER moises.salazar@hccdd1.org Hidalgo County Drainage District No. 1 902 N. Doolittle Edinburg, TX 78542	CANCELLATION SHOULD ANY OF THE ABOVE DESCRIBED POLICIES BE CANCELLED BEFORE THE EXPIRATION DATE THEREOF, NOTICE WILL BE DELIVERED IN ACCORDANCE WITH THE POLICY PROVISIONS. AUTHORIZED REPRESENTATIVE Timothy Esler/JEAN
---	--

© 1988-2014 ACORD CORPORATION. All rights reserved.



CERTIFICATE OF LIABILITY INSURANCE

DATE (MM/DD/YYYY)
11/17/2016

THIS CERTIFICATE IS ISSUED AS A MATTER OF INFORMATION ONLY AND CONFERS NO RIGHTS UPON THE CERTIFICATE HOLDER. THIS CERTIFICATE DOES NOT AFFIRMATIVELY OR NEGATIVELY AMEND, EXTEND OR ALTER THE COVERAGE AFFORDED BY THE POLICIES BELOW. THIS CERTIFICATE OF INSURANCE DOES NOT CONSTITUTE A CONTRACT BETWEEN THE ISSUING INSURER(S), AUTHORIZED REPRESENTATIVE OR PRODUCER, AND THE CERTIFICATE HOLDER.

IMPORTANT: If the certificate holder is an ADDITIONAL INSURED, the policy(las) must be endorsed. If SUBROGATION IS WAIVED, subject to the terms and conditions of the policy, certain policies may require an endorsement. A statement on this certificate does not confer rights to the certificate holder in lieu of such endorsement(s).

PRODUCER STATE FARM INSURANCE ROBERT ELIZALDE, AGENT 5107 S MCCOLL RD EDINBURG, TX 78539	CONTACT NAME: OMAR RIVERA PHONE (A/C No. Ext): 956-683-9800 FAX (A/C No): 956-683-9810 E-MAIL ADDRESS: OMAR.RIVERA.KOTN@STATEFARM.COM													
	<table border="1"> <tr> <th>INSURER(S) AFFORDING COVERAGE</th> <th>NAIC #</th> </tr> <tr> <td>INSURER A : State Farm Mutual Automobile Insurance Company</td> <td>25178</td> </tr> <tr> <td>INSURER B :</td> <td></td> </tr> <tr> <td>INSURER C :</td> <td></td> </tr> <tr> <td>INSURER D :</td> <td></td> </tr> <tr> <td>INSURER E :</td> <td></td> </tr> <tr> <td>INSURER F :</td> <td></td> </tr> </table>	INSURER(S) AFFORDING COVERAGE	NAIC #	INSURER A : State Farm Mutual Automobile Insurance Company	25178	INSURER B :		INSURER C :		INSURER D :		INSURER E :		INSURER F :
INSURER(S) AFFORDING COVERAGE	NAIC #													
INSURER A : State Farm Mutual Automobile Insurance Company	25178													
INSURER B :														
INSURER C :														
INSURER D :														
INSURER E :														
INSURER F :														
INSURED MILLENNIUM ENGINEERS GROUP, INC 5804 N GUMWOOD PHARR, TX 78577														

COVERAGES **CERTIFICATE NUMBER:** **REVISION NUMBER:**

THIS IS TO CERTIFY THAT THE POLICIES OF INSURANCE LISTED BELOW HAVE BEEN ISSUED TO THE INSURED NAMED ABOVE FOR THE POLICY PERIOD INDICATED. NOTWITHSTANDING ANY REQUIREMENT, TERM OR CONDITION OF ANY CONTRACT OR OTHER DOCUMENT WITH RESPECT TO WHICH THIS CERTIFICATION MAY BE ISSUED OR MAY PERTAIN, THE INSURANCE AFFORDED BY THE POLICIES DESCRIBED HEREIN IS SUBJECT TO ALL THE TERMS, EXCLUSIONS AND CONDITIONS OF SUCH POLICIES. LIMITS SHOWN MAY HAVE BEEN REDUCED BY PAID CLAIMS.

INSR LTR	TYPE OF INSURANCE	ADDL INSR	SUBR WVD	POLICY NUMBER	POLICY EFF (MM/DD/YYYY)	POLICY EXP (MM/DD/YYYY)	LIMITS
	GENERAL LIABILITY <input type="checkbox"/> COMMERCIAL GENERAL LIABILITY <input type="checkbox"/> CLAIMS-MADE <input type="checkbox"/> OCCUR GEN'L AGGREGATE LIMIT APPLIES PER: <input type="checkbox"/> POLICY <input type="checkbox"/> PRO-JECT <input type="checkbox"/> LOC						EACH OCCURRENCE \$ DAMAGE TO RENTED PREMISES (Ea occurrence) \$ MED EXP (Any one person) \$ PERSONAL & ADV INJURY \$ GENERAL AGGREGATE \$ PRODUCTS - COMP/OP AGG \$ \$
A	AUTOMOBILE LIABILITY <input type="checkbox"/> ANY AUTO <input type="checkbox"/> ALL OWNED AUTOS <input checked="" type="checkbox"/> SCHEDULED AUTOS <input type="checkbox"/> HIRED AUTOS <input type="checkbox"/> NON-OWNED AUTOS			159 6511-A19-53S	07/19/2016	01/19/2017	COMBINED SINGLE LIMIT (Ea accident) \$ 1,000,000 BODILY INJURY (Per person) \$ BODILY INJURY (Per accident) \$ PROPERTY DAMAGE (Per accident) \$ \$
	UMBRELLA LIAB <input type="checkbox"/> OCCUR EXCESS LIAB <input type="checkbox"/> CLAIMS-MADE DED RETENTION \$						EACH OCCURRENCE \$ AGGREGATE \$ \$
	WORKERS COMPENSATION AND EMPLOYERS' LIABILITY ANY PROPRIETOR/PARTNER/EXECUTIVE OFFICE/MEMBER EXCLUDED? (Mandatory In NH) If yes, describe under DESCRIPTION OF OPERATIONS below		Y/N	N/A			WC STATU-TORY LIMITS <input type="checkbox"/> OTH-ER E.L. EACH ACCIDENT \$ E.L. DISEASE - EA EMPLOYEE \$ E.L. DISEASE - POLICY LIMIT \$

DESCRIPTION OF OPERATIONS / LOCATIONS / VEHICLES (Attach ACORD 101, Additional Remarks Schedule, if more space is required)

2008 FORD RANGER PICKUP VIN: 1FTYR10D48PA62344 2008 FORD RANGER PICKUP VIN: 1FTYR10D38PA92175
 2010 FORD RANGER PICKUP VIN: 1FTKR10D0APA22160 2011 FORD RANGER PICKUP VIN: 1FTKR1ADXBPA02368
 2015 TOYOTA TUNDRA PICKUP VIN: 5TFRM5F14FX092223 2016 TOYOTA TUNDRA PICKUP VIN: 5TFRM5F1XGX095273
 2016 TOYOTA TINDRA PICKUP VIN: 5TFRM5F19GX102276 2016 TOYOTA TUNDRA PICKUP VIN: 5TFRM5F18GX102382
 2016 TOYOTA TUNDRA PICKUP VIN: 5TFRMF1XGX103579 2016 TOYOTA TUNDRA PICKUP VIN: 5TFRM5F11GX095758

CERTIFICATE HOLDER HIDALGO COUNTY DRAINAGE DISTRICT NO. 1 902 N. DOLITTLE EDINBURG, TX 78542	CANCELLATION SHOULD ANY OF THE ABOVE DESCRIBED POLICIES BE CANCELLED BEFORE THE EXPIRATION DATE THEREOF, NOTICE WILL BE DELIVERED IN ACCORDANCE WITH THE POLICY PROVISIONS. AUTHORIZED REPRESENTATIVE 
--	--

© 1988-2010 ACORD CORPORATION. All rights reserved.



CERTIFICATE OF LIABILITY INSURANCE

AKB
R045DATE (MM/DD/YYYY)
11/17/2016

THIS CERTIFICATE IS ISSUED AS A MATTER OF INFORMATION ONLY AND CONFERS NO RIGHTS UPON THE CERTIFICATE HOLDER. THIS CERTIFICATE DOES NOT AFFIRMATIVELY OR NEGATIVELY AMEND, EXTEND OR ALTER THE COVERAGE AFFORDED BY THE POLICIES BELOW. THIS CERTIFICATE OF INSURANCE DOES NOT CONSTITUTE A CONTRACT BETWEEN THE ISSUING INSURER(S), AUTHORIZED REPRESENTATIVE OR PRODUCER, AND THE CERTIFICATE HOLDER.

IMPORTANT: If the certificate holder is an ADDITIONAL INSURED, the policy(ies) must have ADDITIONAL INSURED provisions or be endorsed. If SUBROGATION IS WAIVED, subject to the terms and conditions of the policy, certain policies may require an endorsement. A statement on this certificate does not confer rights to the certificate holder in lieu of such endorsement(s).

PRODUCER		CONTACT NAME:	
SUPERIOR ACCESS INS SRVC INC/PHS		PHONE (A/C, No, Ext): (866) 467-8730	
181840 P:(866) 467-8730 F:(888) 443-6112		FAX (A/C, No): (888) 443-6112	
PO BOX 33015		E-MAIL ADDRESS:	
SAN ANTONIO TX 78265		INSURER(S) AFFORDING COVERAGE	
		INSURER A: Hartford Underwriters Ins Co	
		INSURER B:	
		INSURER C:	
		INSURER D:	
		INSURER E:	
		INSURER F:	
		NAIC#	
		30104	
INSURED			
MILLENNIUM ENGINEERS GROUP INC			
PO BOX 4569			
EDINBURG TX 78540			

COVERAGES**CERTIFICATE NUMBER:****REVISION NUMBER:**

THIS IS TO CERTIFY THAT THE POLICIES OF INSURANCE LISTED BELOW HAVE BEEN ISSUED TO THE INSURED NAMED ABOVE FOR THE POLICY PERIOD INDICATED. NOTWITHSTANDING ANY REQUIREMENT, TERM OR CONDITION OF ANY CONTRACT OR OTHER DOCUMENT WITH RESPECT TO WHICH THIS CERTIFICATE MAY BE ISSUED OR MAY PERTAIN, THE INSURANCE AFFORDED BY THE POLICIES DESCRIBED HEREIN IS SUBJECT TO ALL THE TERMS, EXCLUSIONS AND CONDITIONS OF SUCH POLICIES. LIMITS SHOWN MAY HAVE BEEN REDUCED BY PAID CLAIMS.

INSR LTR	TYPE OF INSURANCE	ADDL INSR	SUBR WVD	POLICY NUMBER	POLICY EFF (MM/DD/YYYY)	POLICY EXP (MM/DD/YYYY)	LIMITS
	COMMERCIAL GENERAL LIABILITY <input type="checkbox"/> CLAIMS-MADE <input type="checkbox"/> OCCUR GEN'L AGGREGATE LIMIT APPLIES PER: <input type="checkbox"/> POLICY <input type="checkbox"/> PRO-JECT <input type="checkbox"/> LOC OTHER:						EACH OCCURRENCE \$ DAMAGE TO RENTED PREMISES (Ea occurrence) \$ MED EXP (Any one person) \$ PERSONAL & ADV INJURY \$ GENERAL AGGREGATE \$ PRODUCTS - COMP/OP AGG \$ \$
	AUTOMOBILE LIABILITY <input type="checkbox"/> ANY AUTO OWNED AUTOS ONLY <input type="checkbox"/> HIRED AUTOS ONLY <input type="checkbox"/> SCHEDULED AUTOS NON-OWNED AUTOS ONLY						COMBINED SINGLE LIMIT (Ea accident) \$ BODILY INJURY (Per person) \$ BODILY INJURY (Per accident) \$ PROPERTY DAMAGE (Per accident) \$ \$
	UMBRELLA LIAB <input type="checkbox"/> OCCUR EXCESS LIAB <input type="checkbox"/> CLAIMS-MADE DED: RETENTION \$						EACH OCCURRENCE \$ AGGREGATE \$ \$
A	WORKERS COMPENSATION AND EMPLOYERS' LIABILITY ANY PROPRIETOR/PARTNER/EXECUTIVE OFFICER/MEMBER EXCLUDED? (Mandatory in NH) <input type="checkbox"/> Y/N If yes, describe under DESCRIPTION OF OPERATIONS below	N/A		72 WEC GY1880	10/16/2016	10/16/2017	<input checked="" type="checkbox"/> PER STATUTE <input type="checkbox"/> OTHER E.L. EACH ACCIDENT \$1,000,000 E.L. DISEASE-EA EMPLOYEE \$1,000,000 E.L. DISEASE-POLICY LIMIT \$1,000,000

DESCRIPTION OF OPERATIONS / LOCATIONS / VEHICLES (ACORD 101, Additional Remarks Schedule, may be attached if more space is required)

Those usual to the Insured's Operations.

CERTIFICATE HOLDER

Hidalgo County Drainage District
 Attn: Number 1
 902 N DOOLITTLE
 EDINBURG, TX 78542

CANCELLATION

SHOULD ANY OF THE ABOVE DESCRIBED POLICIES BE CANCELLED BEFORE THE EXPIRATION DATE THEREOF, NOTICE WILL BE DELIVERED IN ACCORDANCE WITH THE POLICY PROVISIONS.

AUTHORIZED REPRESENTATIVE

Joe Taylor

12. AI -55033 2013 Bonds
 Budget: 320-Alamo Expressway Drain
 Request approval to issue manual payment for Payment Application No. 6 in the amount of \$22,027.50 to Texas Cordia Construction, LLC pertaining to Construction Contract No. HCDD1-14-008-07-08 Pct.2 Alamo Expressway Drain.

Project Engineer: DOS Logistics, Inc.
 PO#625452

On motion by BOARD MEMBER PCT. 1, A.C. CUELLAR, JR., seconded by BOARD MEMBER PCT. 3, JOE M. FLORES, the Board made a UNANIMOUS vote of approval.

Vote: 3 - 0 - Unanimously

13. AI -55031 A.) Requesting exemption from competitive bidding requirements under the Texas Local Government Code, Section 262.024(A)(4) for a Professional Service.

B.) Presentation of scoring grid (for the purposes of ranking by HCDD1 Board of Directors) of the firms graded and evaluated through the District's approved "Pool" of Engineering Firms for the provision of "Construction Material Testing" for Tex Mex Drain Ditch Improvements.

FIRM NAME:	SCORE:	RANK:
MILLENNIUM ENGINEERS GROUP (MEG)	98	
CORTRAN ENGINEERING	96	
INTERNATIONAL CONSULTING ENGINEERS (ICE)	95	

C.) Requesting authority for Drainage District to negotiate a Professional Agreement for Engineering Services with the number one ranked firm of _____, as it relates to Construction Material Testing for Tex Mex Drain Ditch Improvements.

Court took no action on Item. 13.A to C.

14. AI -55034 A.) Requesting exemption from competitive bidding requirements under the Texas Local Government Code, Section 262.024(A)(4) for a Professional Service.

On motion by BOARD MEMBER PCT. 1, A.C. CUELLAR, JR., seconded by BOARD MEMBER PCT. 3, JOE M. FLORES, the Board made a UNANIMOUS vote of approval.

Vote: 3 - 0 - Unanimously

B.) Presentation of scoring grid (for purposes or ranking by HCDD1 Board of Directors) of the firms graded and evaluated through the District's approved "Pool" of Engineering Firms for the provision of

"Construction Material Testing" for Kenyon Rd. & Mile 17 Area Drainage Improvements.

FIRM NAME:	SCORE:	RANK:
MILLENNIUM ENGINEERS GROUP	98	1
INTERNATIONAL CONSULTING ENGINEERS	95	2
LNV ENGINEERS	93	3

On motion by BOARD MEMBER PCT. 1, A.C. CUELLAR, JR., seconded by BOARD MEMBER PCT. 3, JOE M. FLORES, the Board made a UNANIMOUS vote of approval.

Vote: 3 - 0 - Unanimously

C.) Requesting authority for Drainage District to negotiate a Professional Agreement for Engineering Services with the number one ranked firm of **Millennium Engineers Group**, as it relates to Construction Material Testing for Kenyon Rd. & Mile 17 Area Drainage Improvements.

On motion by BOARD MEMBER PCT. 1, A.C. CUELLAR, JR., seconded by BOARD MEMBER PCT. 3, JOE M. FLORES, the Board made a UNANIMOUS vote of approval.

Vote: 3 - 0 - Unanimously

15. **AI -55036** Requesting approval to accept bid and approval to execute Requirements Agreement with lowest and best bid meeting all specified requirements for RFB No. HCDD1-16-027-06-01 "Gasoline, On & Off Highway Diesel Fuel"

On motion by BOARD MEMBER PCT. 1, A.C. CUELLAR, JR., seconded by BOARD MEMBER PCT. 3, JOE M. FLORES, the Board made a UNANIMOUS vote of approval.

Vote: 3 - 0 - Unanimously

16. **Closed Session:**
Board of Directors may go into Closed Session pursuant to Chapter 551, Texas Government Code, Sections 551.071 & 551.072 to discuss the following:

On motion by BOARD MEMBER PCT. 1, A.C. CUELLAR, JR., seconded by BOARD PCT. 3, JOE M. FLORES, the Board made a UNANIMOUS vote of approval.

Vote: 3 - 0 - Unanimously

- A. **Real Estate Acquisition**

Court took no action on this item.

EXHIBIT D
-Work Authorization Form

HIDALGO COUNTY DRAINAGE DISTRICT NO 1
Professional Construction Material Testing Laboratory Services
Agreement # C-HCDD1-16-045A-11-22- WA-1

WORK AUTHORIZATION NO. 1

THIS WORK AUTHORIZATION is made pursuant to the terms and conditions of Section I.A. of the Agreement made by and between **HIDALGO COUNTY DRAINAGE DISTRICT NO 1**, action herein by and through the **Board of Director's**, hereinafter called the "**Owner**," and, Millennium Engineers Group, Inc. professional Laboratory's of Texas, hereinafter called "**Laboratory**".

PART 1. SCOPE OF WORK

The purpose of this Work Authorization is for the **Laboratory** to provide construction materials testing for the Kenyon Road and Mile 17 Area Drainage project.

The scope of services to be provided by the **Owner** is identified in **EXHIBIT "A" – Scope of Services to be Provided by the Owner** attached hereto.

The scope of services to be provided by the **Laboratory** is identified in **EXHIBIT "B" – Scope of Services to be Provided by the Laboratory** attached hereto.

PART 2. ESTIMATED COST

The estimated cost for services under this Work Authorization is \$24,828.25. This amount is based upon the costs outlined in the Estimated **Cost Proposal** attached hereto as **EXHIBIT "D"**.

PART 3. PAYMENT

Compensation and payment to the Laboratory for the services established under this Work Authorization shall be made in accordance with Article/Part/Section 3 of the Agreement.

PART 4. FUNDING

This Work Authorization No. 1 shall be funded through funding source:

Account No. - - - - -

Requisition Number _____ **(MUST BE INCLUDED AFTER CC APPROVAL)**

PART 5. PERIOD OF SERVICE

This Work Authorization shall become effective on the date of final acceptance of the parties hereto, and terminate **upon completion of scopes of the work authorization.**

PART 6. RESPONSIBILITIES AND OBLIGATIONS

This Authorization does not waive the parties' responsibilities and obligations provided under the **Agreement**.

PART 7. ACKNOWLEDGEMENT AND CONFIRMATION

Acknowledgement and confirmation by Hidalgo County Drainage District No 1, General Manager, Raul E. Sesin, PE, CFM, as to content and detail of this Work Authorization No. 1.

HIDALGO COUNTY DRAINAGE DISTRICT NO 1

General Manager

BY: _____
Raul E. Sesin, PE, CFM

PART 8. ACCEPTANCE AND APPROVAL

This Work Authorization is hereby accepted, approved by Hidalgo County Drainage District No 1 Board of Directors Court on _____ as indicated below and effective as of _____ day of _____, 2016.

LABORATORY:
MILLENNIUM ENGINEERS GROUP, INC.

OWNER:
HIDALGO COUNTY DRAINAGE DISTRICT No. 1

By: Raul Palma, P.E., Manager

Ramon Garcia
CHAIRMAN OF THE BOARD

APPROVED AS TO FORM:
Atlas, Hall & Rodriguez, L.L.P.

By: _____

- ATTACHMENTS:
Exhibit A -Services to be provided by Owner
Exhibit B -Services to be provided by Laboratory
Exhibit C -Omitted
Exhibit D -Cost Proposal

EXHIBIT A

-Scope of Services to be provided by the District

The following provides an outline of the services to be provided by the Owner in the development of Projects (as defined and more particularly identified in Exhibit "A" attached to this Agreement).

General:

The Owner will provide to the Laboratory the following:

- 1) Provide the authorization to proceed with services through coordination with the project consulting and design Laboratory.
- 2) Payment for work performed by the Laboratory and accepted by the Owner in accordance with Article 3 of this Agreement.
- 3) Assistance to the Laboratory, as necessary, to obtain the required data and information from other local, regional, State and Federal agencies the Laboratory cannot easily obtain.
- 4) Provide any available relevant data the Owner may have on file concerning the projects.
- 5) Provide timely review and decisions in response to the Laboratory's request for information and/or required submittals and deliverables, in order for the Laboratory to maintain the agreed upon work schedule prepared in accordance with Exhibit "A" attached to this Agreement.
- 6) Attend and participate in progress meetings as required and as coordinated and conducted by Laboratory.
- 7) Provide the authorization to proceed with services on project by project basis through consulting design and construction Laboratory.

Exhibit “B”

Services to be Provided by Laboratory

The services to be provided by the LABORATORY in providing Geotechnical Laboratory Services, Construction Materials Testing and Geo Technical Services for Hidalgo County Drainage District No.1 *Kenyon Road and Mile 17 Area Drainage* Project, “ON A AS NEEDED BASIS” and projects is as follows:

A. Preliminary Phase:

- (1) Attend preliminary conferences with the OWNER and, if requested, with the funding agency and other government agencies or interested parties regarding the Project.
- (2) Provide for the necessary geotechnical investigation and testing necessary to develop the design.
- (3) Provide environmental studies as may be necessary to complete a project.
- (4) Provide assistance to the OWNER in providing material requirements and specifications for design, construction and maintenance projects.
- (5) Provide assistance to the OWNER in providing pavement design recommendations for the design, construction and maintenance projects.
- (6) Provide assistance to the OWNER in providing pavement rehabilitation recommendations for the design, and maintenance projects.
- (7) Provide assistance to the OWNER in providing pavement condition studies.

B. Design Phase:

- (1) Attend the OWNER’S and respective Party’s meeting as requested for the purpose of explaining geotechnical investigation report recommendations and preliminary testing results and their impact to proposed design activities.
- (2) Perform any additional geotechnical investigations, testing and environmental studies necessary to collect information required in the design of the Project.
- (3) Provide assistance to the OWNER in providing material requirements and specification for design, construction and maintenance projects.
- (4) Provide assistance to the OWNER in providing pavement design recommendations for the design, construction and maintenance projects.
- (5) Provide assistance to the OWNER in providing pavement rehabilitation recommendations for the design, construction and maintenance projects.
- (6) Provide assistance to the OWNER in providing pavement condition studies.
- (7) Furnish the OWNER all necessary reports for preliminary design, design, construction and maintenance projects.

C. Construction/Maintenance Phase:

- (1) Attend the OWNER’S and respective Party’s pre-construction and construction meetings as requested for the purpose of explaining geotechnical investigation report recommendation and preliminary testing results and their impact to proposed construction activities and establish coordination and lines of communication for proposed construction materials testing during construction activities.
- (2) Consult and advise with the OWNER during construction.

- (3) Provide construction materials testing for construction and maintenance projects as required by the project plans and specifications and/or specified by the project design engineer.
- (4) Review all material designs as requested by the OWNER and/or project design engineer.
- (5) Furnish the OWNER all necessary reports for construction and maintenance projects.
- (6) Provide construction inspection services as requested by the OWNER on construction and maintenance projects.

D. Miscellaneous/Other:

- (1) Act for OWNER in professional manner, using that degree of care and skill ordinarily exercised by and consistent with the standards of the profession.
- (2) Perform all technical services under the general direction of a Licensed Professional Laboratory in the State of Texas and in substantial accordance with the basic requirements of the appropriate Standards of the American Society of Testing and Materials, where applicable, or other standards designated by County.
- (3) Employ testing machines which have been calibrated within a period not exceeding twelve (12) months from the time of use by devised of accuracy traceable to the National Institute of Standards and Technology (NIST) of the United States Department of Commerce, and, upon request, submit to the OWNER or its authorized representative documentation of such calibration.
- (4) Promptly submit formal construction materials testing reports for all tests, observations, and services performed indicating where applicable, compliance with OWNER specifications or other documents. Such reports shall be completed and factual, citing the tests performed, methods employed, values obtained, parts of the structure and location at which the tests were made.
- (5) The plans and specifications prepared under this Agreement shall become the property of the OWNER upon completion of the work and payment in full of all monies due to the Laboratory.
- (6) Retain all pertinent records relating to the services performed for a period of five (5) years following submission of all reports, during which period the records will be made available to the Owner within a reasonable time.

NOTE: Change in and/or additional services to Scope will require prior approval from OWNER prior to undertaking.



WA-1 EXHIBIT "D"
Construction Materials Testing Proposal
Kenyon Road and Mile 17 Area Drainage Improvements Project

SOILS SECTION

Task: Backfill Sample at Roadway (Per Trip, 7 trips estimated)

Line Item	Qty.	Unit Rate	Estimated Cost
Soil Engineering Technician (hourly)	2.5	50.00	125.00
Standard Proctor (each)	1	200.00	200.00
Atterberg Limits (each)	1	70.00	70.00
Vehicle trip charge (each)	1	40.00	40.00
Test Report (each)	1	30.00	30.00
Project Engineer (hourly)	0.5	125.00	62.50
Project Management (hourly)	0.25	75.00	18.75
Clerical (hourly)	1	50.00	50.00
Sub-Total (per trip)	1	-	596.25
Sub-Total (per task)	7	596.25	4,173.75

Task: Backfill density testing at Roadway (Per Trip, 25 trips estimated)

Line Item	Qty.	Unit Rate	Estimated Cost
Soil Engineering Technician (hourly)	2.5	50.00	125.00
Nuclear density test (each)	3	28.00	84.00
Vehicle trip charge (each)	1	40.00	40.00
Test Report (each)	1	30.00	30.00
Project Engineer (hourly)	0.5	125.00	62.50
Project Management (hourly)	0.25	75.00	18.75
Clerical (hourly)	1	50.00	50.00
Sub-Total (per trip)	1	-	410.25
Sub-Total (per task)	25	410.25	10,256.25

Task: Flexible Base Sample at Roadway Trench (Per Sample, 2 samples estimated)

Line Item	Qty.	Unit Rate	Estimated Cost
Soil Engineering Technician (hourly)	2.5	50.00	125.00
Standard Proctor (each)	1	200.00	200.00
Atterberg Limits (each)	1	70.00	70.00
Sieve Analysis (each)	1	55.00	55.00
Wet Ball Mill (each)	-	210.00	-
Vehicle trip charge (each)	1	40.00	40.00
Test Report (each)	1	30.00	30.00
Project Engineer (hourly)	0.5	125.00	62.50
Project Management (hourly)	0.25	75.00	18.75
Clerical (hourly)	1	50.00	50.00
Sub-Total (per sample)	1	-	651.25
Sub-Total (per task)	2	651.25	1,302.50



Task: Flexible Base density testing at Roadway Trench (Per Trip, 3 trips estimated)

Line Item	Qty.	Unit Rate	Estimated Cost
Soil Engineering Technician (hourly)	2.5	50.00	125.00
Nuclear density test (each)	3	28.00	84.00
Vehicle trip charge (each)	1	40.00	40.00
Test Report (each)	1	30.00	30.00
Project Engineer (hourly)	0.50	125.00	62.50
Project Management (hourly)	0.25	75.00	18.75
Clerical (hourly)	1	50.00	50.00
Sub-Total (per trip)	1	-	410.25
Sub-Total (per task)	3	410.25	1,230.75

SOILS Section Total

16,963.25

CONCRETE SECTION

Task: Concrete testing at Spillway/Canal Riprap (Per Trip, 10 trips estimated)

Line Item	Qty.	Unit Rate	Estimated Cost
Concrete Engineering Technician (hourly)	5	55.00	275.00
Slump Test (each)	1	20.00	20.00
Air Content, Pressure (each)	1	25.00	25.00
Concrete Compressive Strength Test	4	16.00	64.00
Vehicle trip charge (each)	2	40.00	80.00
Test Report (each)	2	30.00	60.00
Project Engineer (hourly)	1.0	125.00	125.00
Project Management (hourly)	0.5	75.00	37.50
Clerical (hourly)	2	50.00	100.00
Sub-Total (per trip)	1	-	786.50
Sub-Total (per task)	10	786.50	7,865.00

Concrete Section Total

7,865.00

Total Estimated Cost

\$24,828.25

AI -57435

9.

DRAINAGE DISTRICT

Meeting Date: 11/22/2016

Submitted For: Jaime Salazar

Submitted By: Moises Salazar, DRAINAGE DISTRICT

Department: DRAINAGE DISTRICT

Information

CAPTION

A.) Requesting exemption from competitive bidding requirements under the Texas Local Government Code, Section 262.024(A)(4) for a Professional Service.

B.) Presentation of scoring grid (for purposes or ranking by HCDD1 Board of Directors) of the firms graded and evaluated through the District's approved "Pool" of Engineering Firms for the provision of "Construction Material Testing" for Flood Pump Drainage Improvements Projects at Mercedes Lateral, East Donna Drain, South Mercedes Drain and Weslaco Drain.

FIRM NAME:	SCORE:	RANK:
MILLENNIUM ENGINEERS GROUP	98	
INTERNATIONAL CONSULTING ENGINEERS	94	
TERRACON CONSULTANTS, INC	97	

C.) Requesting authority for Drainage District to negotiate a Professional Agreement for Engineering Services with the number one ranked firm of _____, as it relates to Construction Material Testing for Flood Pump Drainage Improvements Projects at Mercedes Lateral, East Donna Drain, South Mercedes Drain, and Weslaco Drain.

BACKGROUND

Fiscal Impact

Attachments

No file(s) attached.

Form Review

Inbox

Reviewed By

Date

Final Approval Monica Badillo
Form Started By: Moises Salazar
Final Approval Date: 11/18/2016

11/18/2016 05:28 PM
Started On: 11/18/2016 08:12 AM

AI -57461

10.

DRAINAGE DISTRICT

Meeting Date: 11/22/2016

Submitted For: Jaime Salazar

Submitted By: Jaime Salazar, DRAINAGE
DISTRICT

Department: DRAINAGE DISTRICT

Information

CAPTION

Requesting approval to submit Application for Service to Sharyland Water Supply Corporation and approval for District General Manager to sign as it relates to water service for The North 1.0 Acre of the East 20.0 acres of Lot 8, Section 236.

BACKGROUND

Fiscal Impact

Attachments

Service Application

Form Review

Inbox	Reviewed By	Date
Final Approval	Monica Badillo	11/18/2016 05:28 PM
Form Started By: Jaime Salazar		Started On: 11/18/2016 03:14 PM
Final Approval Date: 11/18/2016		

APPLICATION FOR SERVICE / MEMBER INFORMATION

NEW INSTALLATION

Receipt No.: _____
Membership Fee: \$150.00
Installation: \$968.00 40' RB ON A 2 1/2" LINE
Inspection Fee: \$100.00
Other: \$1360.00 WATER RIGHTS
Cash \$ _____ Ck/MO# _____ \$

TRANSFER

From: _____
Acct No.: _____
Member ID No.: _____
Meter No.: _____

NAME CHANGE

From: _____
Reason: _____
Acct No.: _____
Member ID No.: _____
Meter No.: _____

MOVE / UPGRADE METER

From: _____
To: _____
Acct No.: _____
Member ID No.: _____
Meter No.: _____
Receipt No.: _____
Fee: \$ _____
Cash \$ _____ Ck/MO# _____ \$

EASEMENT

Receipt No.: _____
Easement Fee: \$ _____
Cash \$ _____ Ck/MO# _____ \$

Delinquent Book: _____
Work Order Prepared: _____
Tariff Book: Issued () Mailed ()
Confidentiality: Accepted ()
Denied () Mailed ()

NEW MEMBER ID NO.: _____

Member's Signature _____

Member's Signature _____

HIDALGO COUNTY DRAINAGE DIST #1
Printed Name _____

Printed Name _____

Service Address: _____

HOEHN N 9 3/4 (W)

Mailing Address: _____

902 N DOOLITTLE RD

EDINBURG TX 78542

E-mail Address: _____

Member's Phone No.: (956) 522-8095

Billing Address: C/O CITY OF MCALLEN

Phone No.: _____

Accepted and Approved:

Secretary-Treasurer _____

THE FOLLOWING INFORMATION IS REQUESTED BY THE FEDERAL GOVERNMENT IN ORDER TO MONITOR COMPLIANCE WITH FEDERAL LAWS PROHIBITING DISCRIMINATION AGAINST APPLICANTS SEEKING TO PARTICIPATE IN THIS PROGRAM. YOU ARE NOT REQUIRED TO FURNISH THIS INFORMATION, BUT ARE ENCOURAGED TO DO SO. THIS INFORMATION WILL NOT BE USED IN EVALUATING YOUR APPLICATION TO DISCRIMINATE AGAINST YOU IN ANY WAY. HOWEVER, IF YOU CHOOSE NOT TO FURNISH IT, WE ARE REQUIRED TO NOTE THE RACE/NATIONAL ORIGIN OF INDIVIDUAL APPLICANTS BASED ON VISUAL OBSERVATION OR SURNAME.

RACE/NATIONAL ORIGIN
[] WHITE [] BLACK [] AMERICAN INDIAN [] HISPANIC [] ASIAN OR [] OTHER (SPECIFY)
OR ALASKAN NATIVE PACIFIC ISLANDER
[] MALE [] FEMALE

AI -57451

11.

DRAINAGE DISTRICT

Meeting Date: 11/22/2016

Submitted For: Raul Sesin

Submitted By: Lora Briones, DRAINAGE DISTRICT

Department: DRAINAGE DISTRICT

Information

CAPTION

2012 Bond Referendum

A. Request approval to amend the 2012 bond resolution relating to the authorization to issue bonds for the Raymondville Drain Project.

B. Request approval of a resolution of the Board of Directors of Hidalgo County Drainage District No. 1, authorizing filing of a petition for Declaratory Action relating to issuance of the District \$100 million in authorized by unissued tax bonds, and approving other matters incident thereto.

C. Request approval and permission for the District to file Declaratory Action and Authorization to have such filing be prepare and filed by the District Bond Counsel, Jesus Ramirez, under the term of the current engagement between the Hidalgo County Drainage District No. 1 and The J. Ramirez Law Firm.

BACKGROUND

Fiscal Impact

Attachments

No file(s) attached.

Form Review

Inbox

Reviewed By

Date

Final Approval

Monica Badillo

11/18/2016 05:28 PM

Form Started By: Lora Briones

Started On: 11/18/2016 01:27 PM

Final Approval Date: 11/18/2016

AI -57428

12.

DRAINAGE DISTRICT

Meeting Date: 11/22/2016

Submitted By: Monica Badillo,
EXECUTIVE OFFICE

Department: EXECUTIVE OFFICE

Information

CAPTION

Authority to publish and approval of qualifications, requirements and scope of services for the engagement of legal counsel to pursue all remedies available to the Hidalgo County Drainage District #1 in connection with the agreement between Hidalgo County Drainage District #1 and Integ Corporation as outlined/contained in the final Lee Law Firm Report

BACKGROUND

Pursuant to Texas Water Code, Chapter 49, Section .057 (d) with said engagement to follow the procedures provided in Subchapter A, Chapter 2254.003 (a)(1)(2)(b) under Professional Services Procurement Act which will be accomplished through a Request for Qualifications through 3 required publications.

Same procurement packet used for engagement of Lee Law Firm will be utilized for this project.

Fiscal Impact

Attachments

No file(s) attached.

Form Review

Inbox	Reviewed By	Date
Final Approval	Monica Badillo	11/18/2016 05:28 PM
Form Started By: Monica Badillo		Started On: 11/17/2016 04:22 PM
Final Approval Date: 11/18/2016		

AI -57463

13. C.

DRAINAGE DISTRICT

Meeting Date: 11/22/2016

Submitted By: Monica Badillo,
EXECUTIVE OFFICE

Department: EXECUTIVE OFFICE

Information

CAPTION

Review of Attorney-Client Privileged Investigative Analysis Report with respect to potential litigation - Integ Corporation

BACKGROUND

Fiscal Impact

Attachments

No file(s) attached.

Form Review

Form Started By: Monica Badillo

Started On: 11/18/2016 04:37 PM

Final Approval Date: 11/18/2016

AI -57466

13. D.

DRAINAGE DISTRICT

Meeting Date: 11/22/2016

Submitted By: Monica Badillo,
EXECUTIVE OFFICE

Department: EXECUTIVE OFFICE

Information

CAPTION

Potential Litigation - 2012 Bond Resolution

BACKGROUND

Fiscal Impact

Attachments

No file(s) attached.

Form Review

Inbox	Reviewed By	Date
Final Approval	Monica Badillo	11/18/2016 05:28 PM
Form Started By: Monica Badillo		Started On: 11/18/2016 05:11 PM
Final Approval Date: 11/18/2016		

AI -57464

14. C.

DRAINAGE DISTRICT

Meeting Date: 11/22/2016

Submitted By: Monica Badillo,
EXECUTIVE OFFICE

Department: EXECUTIVE OFFICE

Information

CAPTION

Review of Attorney-Client Privileged Investigative Analysis Report with respect to potential litigation - Integ Corporation

BACKGROUND

Fiscal Impact

Attachments

No file(s) attached.

Form Review

Form Started By: Monica Badillo

Started On: 11/18/2016 04:38 PM

Final Approval Date: 11/18/2016

AI -57467

14. D.

DRAINAGE DISTRICT

Meeting Date: 11/22/2016

Submitted By: Monica Badillo,
EXECUTIVE OFFICE

Department: EXECUTIVE OFFICE

Information

CAPTION

Potential Litigation - 2012 Bond Resolution

BACKGROUND

Fiscal Impact

Attachments

No file(s) attached.

Form Review

Inbox	Reviewed By	Date
Final Approval	Monica Badillo	11/18/2016 05:28 PM
Form Started By: Monica Badillo		Started On: 11/18/2016 05:11 PM
Final Approval Date: 11/18/2016		